

J:\PROJECTS\2017\171010567_COW_STRYKER_170567_CAD\SH1505_CIVIL\TITLE170567-05-001.DWG
 J:\PROJECTS\2017\171010567_COW_STRYKER_170567_CAD\SH1505_CIVIL\TITLE170567-05-001.DWG
 PLOTTED: Wednesday, January 10, 2018 @ 08:39AM

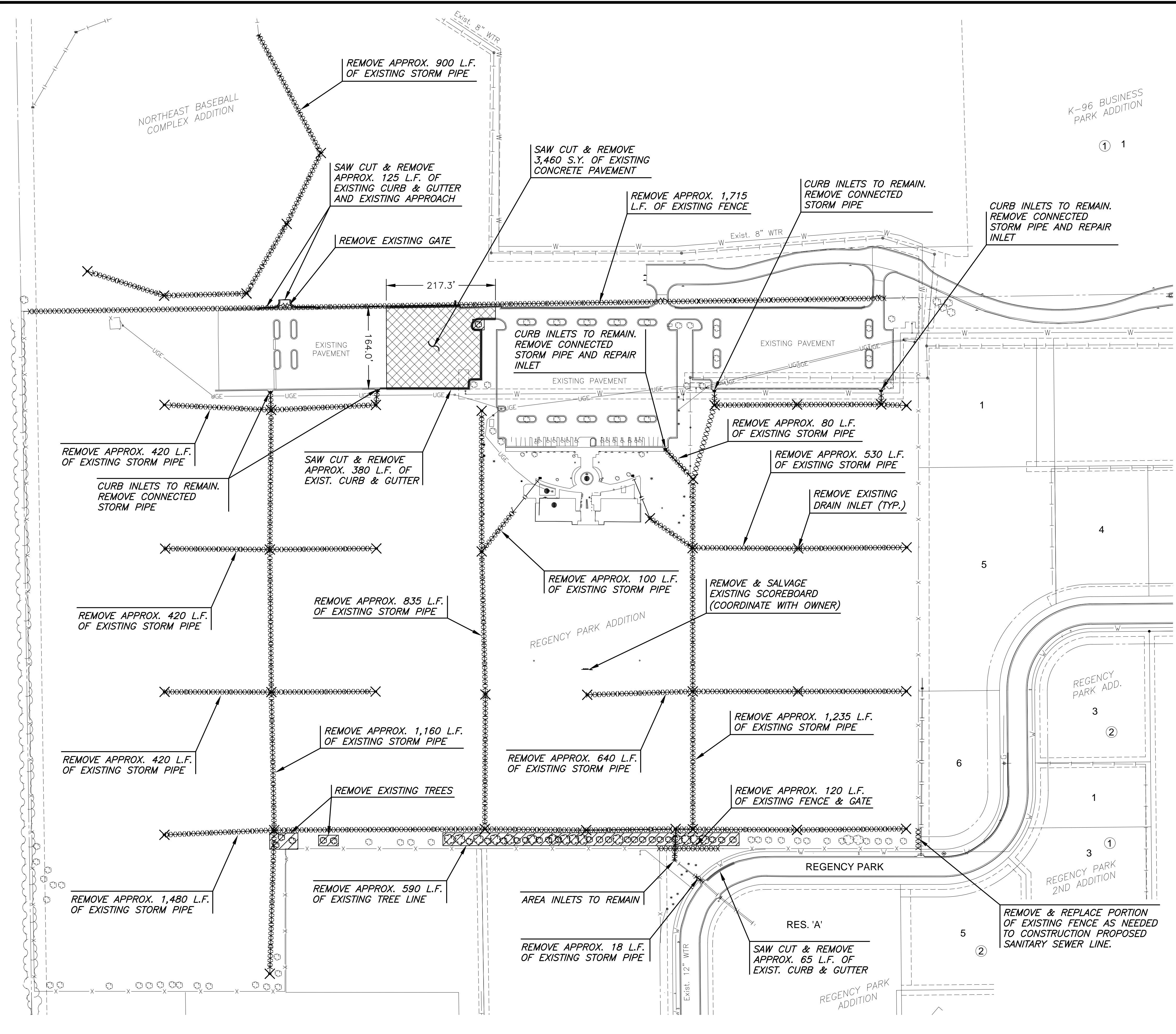

LEGEND

- W — WATERLINE
- S — SANITARY SEWER
- SW — STORMWATER SEWER
- UGE — UNDERGROUND ELECTRICAL
- G — GAS LINE
- X — EXISTING CURB TO BE REMOVED
- XXXXXXXXXXXXXXXXXXXX — PIPE AND FENCE TO BE REMOVED
- X — SWS INLETS TO BE REMOVED
- [Hatched Box] — EXISTING TREES TO BE REMOVED
- [Cross-hatched Box] — EXISTING PAVEMENT TO BE REMOVED

DEMOLITION SHOWN ON THIS SHEET SHALL BE SUBSIDIARY TO SITE CLEARING.



GRADING & UTILITIES PLANS FOR
STRYKER SPORTS
 WICHITA, KANSAS



©2018 MKEC Engineering All Rights Reserved www.mkec.com
 These drawings and their contents, including, but not limited to, all concepts, designs, & ideas are the exclusive property of MKEC Engineering (MKEC), and may not be used or reproduced in any way without the express consent of MKEC.

DEMOLITION PLAN

PROJECT NO.	170567
DATE	01-10-18
SCALE	1" = 100'
DESIGNED	MAB
DRAWN	JWC
CHECKED	MAB
ISSUE FOR CONST. NO.	01-10-18
REVISION	DATE
SHEET NO.	04 OF 70