

COORDINATE TABLE					
POINT NO.	COORDINATES		STATION	OFFSET	DESCRIPTION
	NORTH	EAST			
7000	1695919.5461	1665022.6283	119+80.00	18.75' Lt.	Edge of Pavement
7001	1695920.1675	1665059.1730	119+80.00	17.80' Rt.	Edge of Pavement
7002	1695955.1658	1665058.7780	120+15.00	18.00' Rt.	Edge of Pavement P.I.
7003	1696075.2080	1665060.2373	121+35.00	21.50' Rt.	Edge of Pavement P.I.
7004	1696294.6566	1665081.9469	123+54.05	46.94' Rt.	Edge of Pavement
7005	1696301.4315	1664967.9422	123+62.76	66.94' Lt.	Edge of Pavement
7006	1696329.0584	1664999.9128	123+89.84	34.50' Lt.	Edge of Pavement P.I.
7007	1696568.7290	1664846.1519	224+76.50	21.00' Rt.	Edge of Pavement
7008	1696569.1355	1664864.6429	224+95.00	21.00' Rt.	Edge of Pavement
7009	1696574.9035	1664899.5245	225+30.00	16.00' Rt.	Edge of Pavement
7010	1696609.6542	1664714.7161	223+46.00	22.80' Lt.	Edge of Pavement
7011	1696612.7183	1664845.1848	224+76.50	23.00' Lt.	Edge of Pavement
7012	1696613.1248	1664863.6758	224+95.00	23.00' Lt.	Edge of Pavement
7013	1696608.8953	1664898.7772	225+30.00	18.00' Lt.	Edge of Pavement
7014	1696619.5739	1665069.4677	227+00.81	25.04' Lt.	Edge of Pavement
7015	1696688.2507	1665131.3657	227+64.01	92.53' Lt.	Edge of Pavement
7016	1696704.1751	1665122.9743	227+55.92	108.61' Lt.	Edge of Pavement
7017	1696726.2923	1665111.3197	227+44.69	130.94' Lt.	Edge of Pavement
7018	1696742.2167	1665102.9284	227+36.60	147.02' Lt.	Edge of Pavement
7019	1696843.3765	1665005.5595	129+04.00	19.95' Lt.	Edge of Pavement
7020	1696843.7197	1665025.0061	129+04.00	0.50' Lt.	Edge of Pavement
7021	1696911.3855	1664979.8052	129+72.45	44.50' Lt.	Edge of Pavement
7022	1696912.1808	1665001.7946	129+72.86	22.50' Lt.	Edge of Pavement

SIDEWALK COORDINATE TABLE					
POINT NO.	COORDINATES		STATION	OFFSET	DESCRIPTION
	NORTH	EAST			
5001	1695950.9700	1665077.5140	120+10.49	36.66' Rt.	P.I. (Match Existing Sidewalk)
5002	1695951.2590	1665073.5910	120+10.84	32.74' Rt.	P.I. (Match Existing Sidewalk)
5003	1695960.9743	1665077.6820	120+20.49	37.00' Rt.	P.I.
5004	1696256.2033	1665072.6620	123+15.76	37.00' Rt.	P.I. (WCR)
5005	1696306.8837	1665071.8002	123+66.45	37.00' Rt.	P.I. (WCR)
5006	1696538.1618	1665093.6575	125+97.32	62.79' Rt.	P.C. (25' R.)
5007	1696543.3133	1665078.0279	126+02.74	47.25' Rt.	P.T. (25' R.)
5008	1696543.1391	1665067.7830	126+02.74	37.00' Rt.	P.I. (End Sidewalk)
5009	1696543.0200	1665060.7840	126+02.74	30.00' Rt.	P.I. (WCR)
6001	1695919.9610	1665002.8816	119+80.75	38.49' Lt.	P.I. (Match Existing Sidewalk)
6002	1695929.9848	1665004.1982	119+90.75	37.00' Lt.	P.I.
6003	1696214.5690	1664999.3592	122+75.38	37.00' Lt.	P.I. (WCR)
6004	1696247.9591	1664999.2915	123+08.76	36.50' Lt.	P.I. (WCR)
6005	1696249.7920	1664999.2604	123+10.60	36.50' Lt.	P.I. (WCR)
6006	1696321.1086	1664988.2265	123+82.09	46.32' Lt.	P.I. (Match Existing Sidewalk)
6007	1696321.7932	1664991.5351	123+82.72	43.00' Lt.	P.I. (End Sidewalk)
6008	1696334.9640	1664994.3116	123+95.84	40.00' Lt.	P.I. (WCR)
6009	1696488.9089	1664988.6936	125+49.86	43.00' Lt.	P.I.
6010	1696541.7886	1664987.7944	126+02.74	43.00' Lt.	P.I. (WCR)
6011	1696557.7316	1664846.3937	224+76.50	32.00' Rt.	P.I. (Match Existing Sidewalk)
6012	1696561.2276	1664868.9218	224+99.10	29.00' Rt.	P.I.
6013	1696564.2823	1664887.3944	225+17.64	26.35' Rt.	P.I. (WCR)
6014	1696556.6491	1664933.6465	225+63.71	35.00' Rt.	P.I.
6015	1696567.7115	1664959.1134	225+89.42	24.50' Rt.	P.I. (WCR)
6016	1696623.7157	1664844.9430	224+76.50	34.00' Lt.	P.I. (Match Existing Sidewalk)
6017	1696621.2131	1664867.6030	224+99.10	31.00' Lt.	P.I.
6018	1696618.9732	1664886.1921	225+17.64	28.35' Lt.	P.I. (WCR)
6019	1696620.5540	1664957.9481	225+89.41	28.36' Lt.	P.I. (WCR)
6020	1696626.1973	1664957.8240	225+89.41	34.00' Lt.	P.I. (End Sidewalk)
6021	1696638.4977	1664957.5536	127+00.00	71.56' Lt.	P.I.
6022	1696666.5209	1664958.6221	127+28.00	70.00' Lt.	P.I.

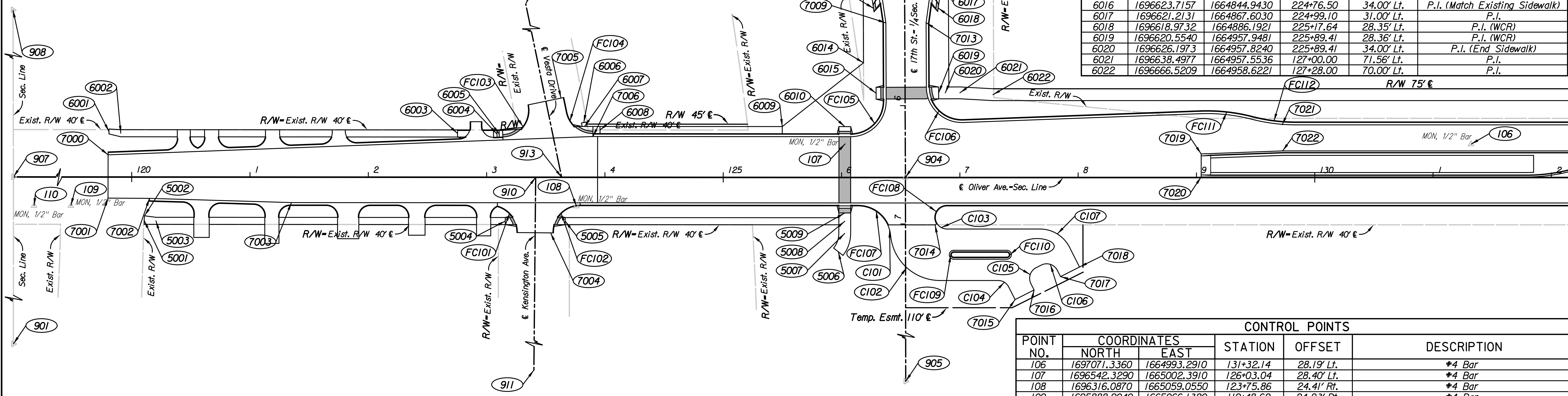

CURVE DATA													
NO.	Δ	R	T	L	E	P.C. COORDINATES		P.I. COORDINATES		P.T. COORDINATES		C.C. COORDINATES	
						NORTH	EAST	NORTH	EAST	NORTH	EAST	NORTH	EAST
CI01	19°18'57.13" Rt.	27.50'	4.68'	9.27'	0.40'	1696581.5744	1665074.3919	1696581.5744	1665074.3919	1696581.5744	1665074.3919	1696581.5744	1665074.3919
CI02	84°39'17.19" Lt.	42.00'	38.25'	62.06'	14.81'	1696582.0925	1665079.0430	1696586.3275	1665117.0616	1696624.5753	1665116.3867	1696623.8343	1665074.3933
CI03	57°51'54.26" Rt.	9.75'	5.39'	9.85'	1.39'	1696629.5840	1665072.7916	1696624.1953	1665072.8867	1696621.2485	1665068.3741	1696629.4120	1665063.0431
CI04	63°13'26.52" Rt.	10.00'	6.15'	11.03'	1.74'	1696673.6897	1665115.5201	1696679.8437	1665115.4115	1696682.7130	1665120.8567	1696673.8661	1665125.5185
CI05	90°00'00" Rt.	10.00'	10.00'	15.71'	4.14'	1696701.3780	1665117.6662	1696696.7161	1665108.8193	1696705.5630	1665104.1575	1696710.2249	1665113.0044
CI06	90°00'00" Rt.	10.00'	10.00'	15.71'	4.14'	1696709.9865	1665101.8266	1696718.8333	1665097.1647	1696723.4952	1665106.0116	1696714.6483	1665110.6735
CI07	63°13'26.52" Rt.	28.00'	17.23'	30.90'	4.88'	1696708.2136	1665071.4041	1696725.4447	1665071.1000	1696733.4789	1665086.3466	1696708.7076	1665099.3997
FCI01	90°29'28.67" Rt.	23.00'	23.20'	36.33'	9.67'	1696243.2674	1665059.3800	1696266.4621	1665058.9856	1696266.6576	1665082.1828	1696243.6584	1665082.3767
FCI02	89°30'31.33" Rt.	23.00'	22.80'	35.93'	9.39'	1696296.6510	1665081.2783	1696296.4589	1665058.4755	1696319.2592	1665058.0878	1696319.6502	1665081.0845
FCI03	99°32'20.23" Lt.	23.00'	27.19'	39.96'	12.61'	1696252.9558	1665002.1311	1696280.1015	1665000.6254	1696274.1181	1664974.1046	1696251.6820	1664979.1664
FCI04	78°15'36.98" Lt.	23.00'	18.71'	31.42'	6.65'	1696306.1973	1664979.9783	1696310.3154	1664998.2312	1696329.0244	1664997.9131	1696328.6334	1664974.9165
FCI05	90°17'06.92" Lt.	28.00'	28.14'	44.12'	11.70'	1696546.8384	1664994.2095	1696574.9741	1664993.7311	1696574.3556	1664965.5981	1696546.3624	1664966.2135
FCI06	91°52'21.45" Lt.	28.00'	28.93'	44.90'	12.26'	1696612.0923	1664953.2030	1696612.7282	1664982.1264	1696641.6154	1664980.5458	1696640.0855	1664952.5876
FCI07	65°46'15.58" Rt.	28.00'	18.10'	32.14'	5.34'	1696554.2855	1665054.0915	1696572.3868	1665053.7837	1696580.0960	1665070.1643	1696554.7615	1665082.0875
FCI08	122°08'05.74" Rt.	10.25'	18.54'	21.85'	10.94'	1696620.8299	1665068.6475	1696610.6911	1665053.1218	1696629.2312	1665052.7947	1696629.4120	1665063.0431
FCI09	180°00'00" Lt.	2.50'	—	7.85'	—	1696635.6728	1665091.9371	—	—	1696635.7610	1665096.9363	1696635.7169	1665094.4367
FCI10	180°00'00" Rt.	2.50'	—	7.85'	—	1696680.6657	1665091.1432	—	—	1696680.7540	1665096.1424	1696680.7099	1665093.6428
FCI11	16°37'23.92" Rt.	152.00'	22.21'	44.10'	1.61'	1696842.2056	1664969.5697	1696864.3784	1664968.3565	1696885.9716	1664973.5371	1696850.5104	1665121.3427
FCI12	14°30'07.97" Lt.	148.00'	18.83'	37.46'	1.19'	1696885.9716	1664973.5371	1696904.2828	1664977.9302	1696923.1108	1664977.5980	1696920.4996	1664829.6210

CONTROL POINTS					
POINT NO.	COORDINATES		STATION	OFFSET	DESCRIPTION
	NORTH	EAST			
106	1697071.3360	1664993.2910	131+32.14	28.19' Lt.	#4 Bar
107	1696542.3290	1665002.3910	126+03.04	28.40' Lt.	#4 Bar
108	1696316.0870	1665059.0550	123+75.86	24.41' Rt.	#4 Bar
109	1695888.9040	1665066.1380	119+48.62	24.23' Rt.	#4 Bar
110	1695600.3670	1665070.9150	116+60.05	24.10' Rt.	#4 Bar
901	1693986.5897	166726.4977	100+01.35	2651.87' Rt.	S 1/4 Cor. Sec. 12, T27S, R1E
904	1696593.7740	1665029.9167	126+54.01	0.00' Rt.	W 1/4 Cor. Sec. 12, T27S, R1E
905	1696644.4445	1667687.1886	253+18.53	0.00' Rt.	Ctr. Sec. 12, T27S, R1E
906	1696535.2930	1662369.7840	200+00.00	0.00' Rt.	Ctr. Sec. 11, T27S, R1E
907	1693940.1510	1665075.0380	100+00.00	0.00' Rt.	SE Cor. Sec. 11, T27S, R1E
908	1693885.8730	1662411.3900	99+91.02	2664.19' Lt.	S 1/4 Cor. Sec. 11, T27S, R1E
910	1696281.2624	1665035.2305	20+00.00	0.00' Rt.	CL Kensington Ave.
911	1696282.9479	1665235.2234	22+00.00	0.00' Rt.	CL Kensington Ave.
912	1696259.1853	1664839.7612	18+00.00	0.00' Rt.	CL Vesta Dr.
913	1696303.2018	1665034.8575	20+00.00	0.00' Rt.	CL Vesta Dr.

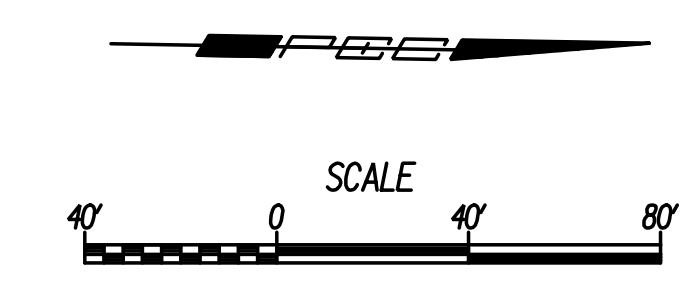

17TH STREET AND OLIVER INTERSECTION

COORDINATE GEOMETRY PLAN

STA. 119+00 TO STA. 132+00

GARY JANZEN, P.E.—CITY ENGINEER
CITY OF WICHITA PROJECT NO. 472-85214

PROFESSIONAL ENGINEERING CONSULTANTS, P.A.
303 SOUTH TOPEKA WICHITA, KS 67202
316-262-2691 www.pec1.com

Designed by: CKC Job No: 15081
Drawn by: CP, SVB Date: Dec., 2017

Sheet 13 of 107

Plotted By: sheldon.bfn@date: 12/14/2017 4:55:52 PM
FILE:U:\Wichita-Civil\2015\15081\000\Tran\Road\DCN Project\Geometry\15081-COGO_119.dgn