

BENCHMARKS:
 City of Wichita Benchmark Disk
 34.9' S. & 31.2' W. of the SW Cor.,
 NW1/4, Sec. 2, Twp. 27-S, R-1-W.
 Elev. = 1327.57 NAVD88

"□" cut in top of curb 1.5'
 north of the northeast corner of
 Lot 20, Block B, Sandcrest Addn.
 Elev. = 1327.21 NAVD88

"□" cut in top of east curb
 inlet at the southeast corner of
 the southern intersection of Curtis
 & Sandcrest.
 Elev. = 1322.05 NAVD88

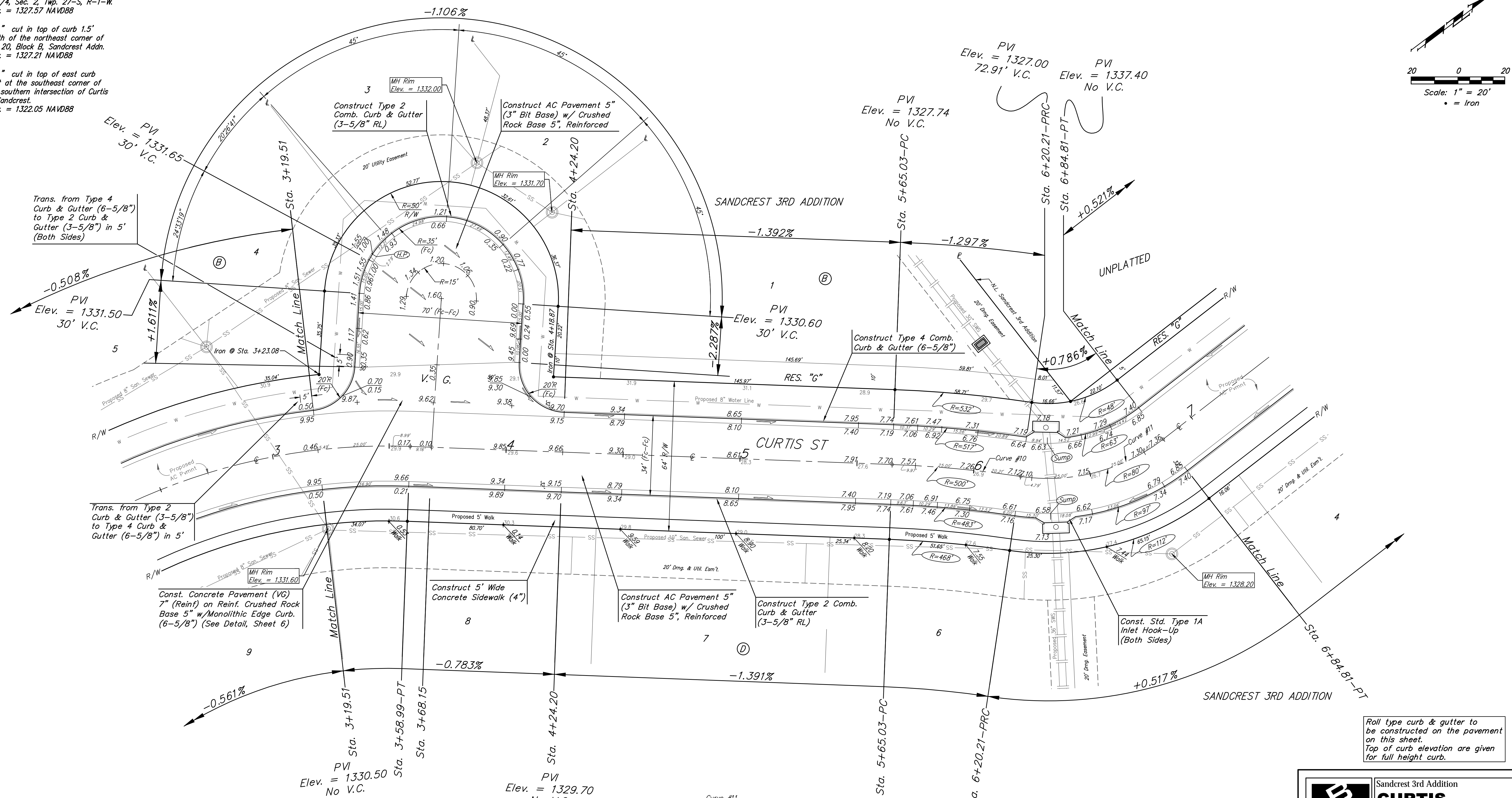
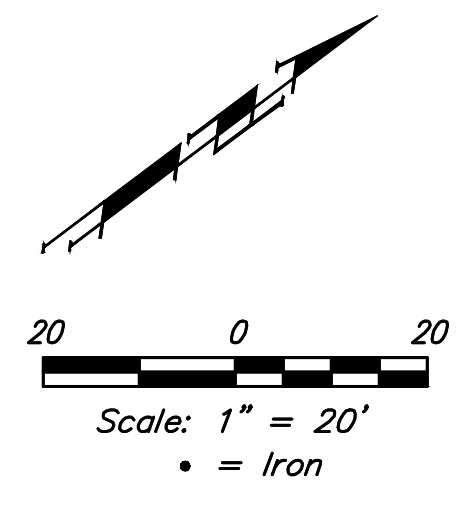

Trans. from Type 2
 Curb & Gutter (3-5/8")
 to Type 4 Curb &
 Gutter (6-5/8") in 5'

Const. Concrete Pavement (VG)
 7" (Reinf) on Reinf. Crushed Rock
 Base 5" w/Monolithic Edge Curb.
 (6-5/8") (See Detail, Sheet 6)

Const. 5' Wide
 Concrete Sidewalk (4")

Construct AC Pavement 5"
 (3" Bit Base) w/ Crushed
 Rock Base 5", Reinforced

Construct Type 2 Comb.
 Curb & Gutter
 (3-5/8" RL)

Construct Type 4 Comb.
 Curb & Gutter (6-5/8")

Construct AC Pavement 5"
 (3" Bit Base) w/ Crushed
 Rock Base 5", Reinforced

Construct Type 2
 Comb. Curb & Gutter
 (3-5/8" RL)

Construct Type 4
 Comb. Curb & Gutter
 (6-5/8")

Const. Std. Type 1A
 Inlet Hook-Up
 (Both Sides)

Curve #10
 Curve Data Based on Centerline
 Rad. = 500' Delta = 61'22" Tangent = 27.62'
 Arc = 55.18' L.C. = 55.15' Def./Ft. = 3.43754 Min.

Station	Arc	Face Chord Length		Defl.	Total Defl.
		8' Left	8' Right		
5+65.03	-	-	-	0'00"00"	0'00"00"
5+75.00	9.97'	10.47'	9.47'	0'34"16"	0'34"16"
6+00.00	25.00'	26.25'	23.75'	1'25"57"	2'00"13"
6+20.21	20.21'	21.22'	19.20'	1'09"28"	3'09"41"

Curve #11
 Curve Data Based on Centerline
 Rad. = 80' Delta = 46'16"17" Tangent = 34.18'
 Arc = 64.60' L.C. = 62.87' Def./Ft. = 21.48826 Min.

Station	Arc	Face Chord Length		Defl.	Total Defl.
		8' Left	8' Right		
6+20.21	-	-	-	0'00"00"	0'00"00"
6+25.00	4.79'	3.29'	6.29'	1'42"56"	1'42"56"
6+50.00	25.00'	17.12'	32.68'	8'57"12"	10'40"08"
6+75.00	25.00'	17.12'	32.68'	8'57"13"	19'37"21"
6+84.81	9.81'	6.74'	12.87'	3'30"47"	23'08"08"

Roll type curb & gutter to
 be constructed on the pavement
 on this sheet.
 Top of curb elevation are given
 for full height curb.

		Sandcrest 3rd Addition	
		CURTIS	
Baughman Company, P.A. 315 Ellis St. Wichita, KS 67211 P 316-262-7271 F 316-262-0149 ENGINEERING SURVEYING PLANNING LANDSCAPE ARCHITECTURE		Street / SWS Improvements	
PROJECT NUMBER 472-85423	DESIGN AEG	DRAWN JAK	
REVISIONS:	APPROVED	DATE 1/15/18	
SCALE Noted		SHEET 11 OF 50	