

BENCHMARKS:
 City of Wichita Benchmark Disk
 34.9' S. & 31.2' W. of the SW Cor.,
 NW1/4, Sec. 2, Twp. 27-S, R-1-W.
 Elev. = 1327.57 NAVD88

"□" cut in top of curb 1.5'
 north of the northeast corner of
 Lot 20, Block B, Sandcrest Addn.
 Elev. = 1327.21 NAVD88

"□" cut in top of east curb
 inlet at the southeast corner of
 the southern intersection of Curtis
 & Sandcrest.
 Elev. = 1322.05 NAVD88

Curve #12
 Curve Data Based on Centerline
 Rad. = 148.25' Delta = 18°39'55" Tangent = 24.36'
 Arc = 48.30' L.C. = 48.08' Def./Ft. = 11.59334 Min.

Station	Arc	Face Chord Length		Defl.	Total Defl.
		8' Left	8' Right		
10+99.60	-	-	-	0'00'00"	0'00'00"
11+00.00	0.40'	0.33'	0.47'	0'04'38"	0'04'38"
11+25.00	25.00'	20.76'	29.18'	4'49'50"	4'54'28"
11+47.90	22.90'	19.02'	26.73'	4'25'30"	9'19'58"

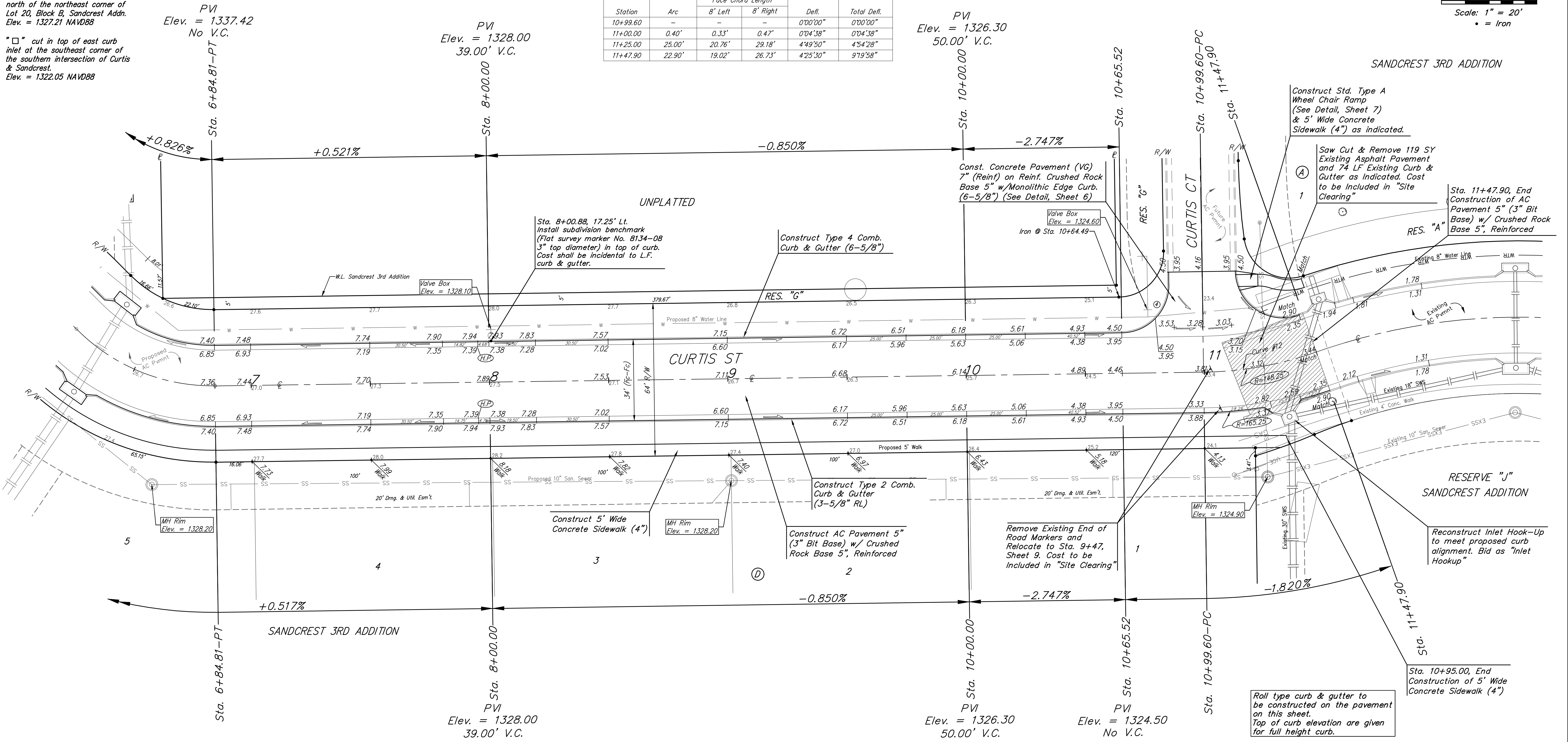
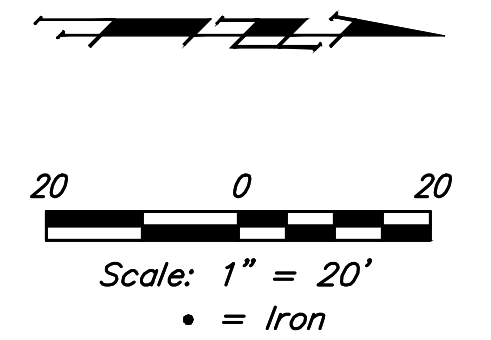

Construct Std. Type A
 Wheel Chair Ramp
 (See Detail, Sheet 7)
 & 5' Wide Concrete
 Sidewalk (4") as indicated.

Saw Cut & Remove 119 SY
 Existing Asphalt Pavement
 and 74 LF Existing Curb &
 Gutter as Indicated. Cost
 to be Included in "Site
 Clearing"

Sta. 11+47.90, End
 Construction of AC
 Pavement 5" (3" Bit
 Base) w/ Crushed Rock
 Base 5", Reinforced

Sta. 8+00.88, 17.25' Lt.
 Install subdivision benchmark
 (Flat survey marker No. 8134-08
 3" top diameter) in top of curb.
 Cost shall be incidental to L.F.
 curb & gutter.

Const. Concrete Pavement (VG)
 7" (Reinf) on Reinf. Crushed Rock
 Base 5" w/Monolithic Edge Curb.
 (6-5/8") (See Detail, Sheet 6)

Construct Type 4 Comb.
 Curb & Gutter (6-5/8")

Construct Type 2 Comb.
 Curb & Gutter
 (3-5/8" RL)

Construct AC Pavement 5"
 (3" Bit Base) w/ Crushed
 Rock Base 5", Reinforced

Remove Existing End of
 Road Markers and
 Relocate to Sta. 9+47,
 Sheet 9. Cost to be
 Included in "Site Clearing"

Reconstruct Inlet Hook-Up
 to meet proposed curb
 alignment. Bid as "Inlet
 Hookup"

Roll type curb & gutter to
 be constructed on the pavement
 on this sheet.
 Top of curb elevation are given
 for full height curb.

	Sandcrest 3rd Addition	
	CURTIS Street / SWS Improvements	
Baughman Company, P.A. 315 Ellis St. Wichita, KS 67211 P 316-262-7271 F 316-262-0149 ENGINEERING SURVEYING PLANNING LANDSCAPE ARCHITECTURE		
PROJECT NUMBER 472-85423	DESIGN AEG	DRAWN JAK
REVISIONS:	APPROVED	DATE 1/15/18
	SCALE Noted	SHEET 12 OF 50

I:\Projects\Sandcrest 3rd Addition_1706-P296\Engineering\Phase 1\Str. 16114584\STR PLANS.dwg