

**BENCHMARKS:**  
 City of Wichita Benchmark Disk  
 34.9' S. & 31.2' W. of the SW Cor.,  
 NW1/4, Sec. 2, Twp. 27-S, R-1-W.  
 Elev. = 1327.57 NAVD88

"□" cut in top of curb 1.5'  
 north of the northeast corner of  
 Lot 20, Block B, Sandcrest Addn.  
 Elev. = 1327.21 NAVD88

"□" cut in top of east curb  
 inlet at the southeast corner of  
 the southern intersection of Curtis  
 & Sandcrest.  
 Elev. = 1322.05 NAVD88

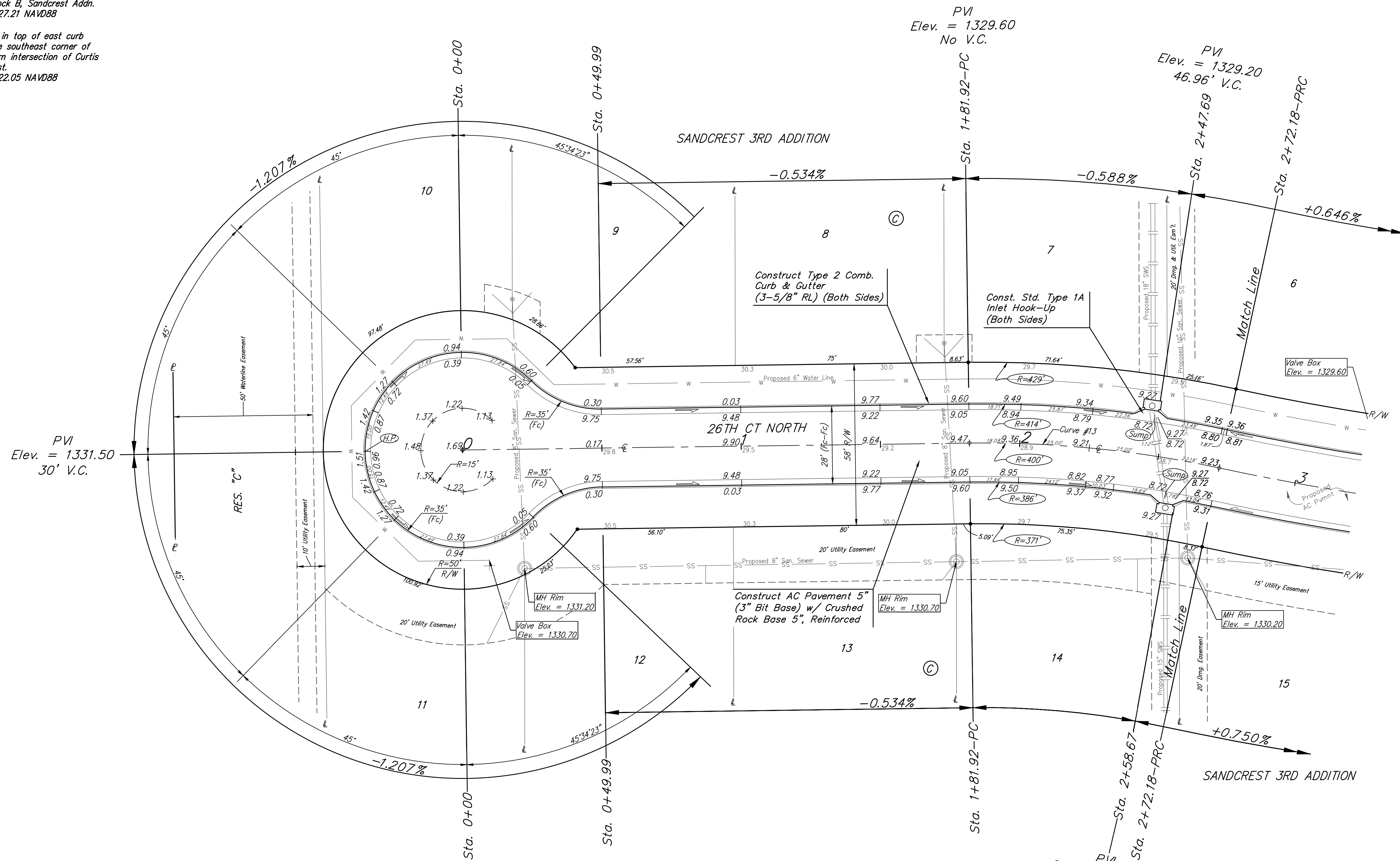
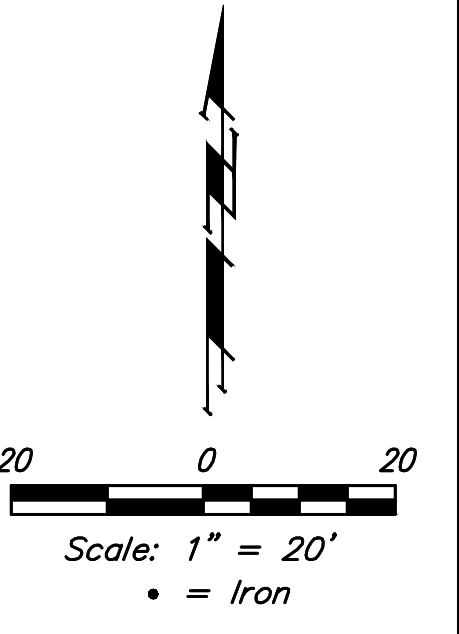

Curve #13  
 Curve Data Based on Centerline  
 Rad. = 400' Delta = 12°55'43" Tangent = 45.32'  
 Arc = 90.26' L.C. = 90.07' Def./Ft. = 4.29712 Min.

Station	Arc	Face Chord Length		Defl.	Total Defl.
		8' Left	8' Right		
1+81.92	-	-	-	0'00"00"	0'00"00"
2+00.00	18.08'	19.07'	17.08'	1'7"42"	1'7"42"
2+25.00	25.00'	26.37'	23.62'	1'4"25"	3'05"07"
2+50.00	25.00'	26.37'	23.62'	1'4"26"	4'52"33"
2+72.18	22.18'	23.40'	20.96'	1'35"19"	6'27"52"

Roll type curb & gutter to be constructed on the pavement on this sheet.  
 Top of curb elevation are given for full height curb.

	Sandcrest 3rd Addition	
	<b>26TH CT N</b> Street / SWS Improvements	
<small>Baughman Company, P.A. 315 Ellis St. Wichita, KS 67211 P 316-262-7271 F 316-262-0149          ENGINEERING   SURVEYING   PLANNING   LANDSCAPE ARCHITECTURE</small>		
PROJECT NUMBER <b>472-85423</b>	DESIGN AEG	DRAWN JAK
REVISIONS:	APPROVED DATE 1/15/18	SCALE Noted SHEET <b>13 OF 50</b>

I:\Projects\Sandcrest 3rd Addition\_17-06-P296\Engineering\Phase 1\Str. 16-11-1584\STR PLANS.dwg