

BENCHMARKS:
 City of Wichita Benchmark Disk
 34.9' S. & 31.2' W. of the SW Cor.,
 NW1/4, Sec. 2, Twp. 27-S, R-1-W.
 Elev. = 1327.57 NAVD88

"□" cut in top of curb 1.5'
 north of the northeast corner of
 Lot 20, Block B, Sandcrest Addn.
 Elev. = 1327.21 NAVD88

"□" cut in top of east curb
 inlet at the southeast corner of
 the southern intersection of Curtis
 & Sandcrest.
 Elev. = 1322.05 NAVD88

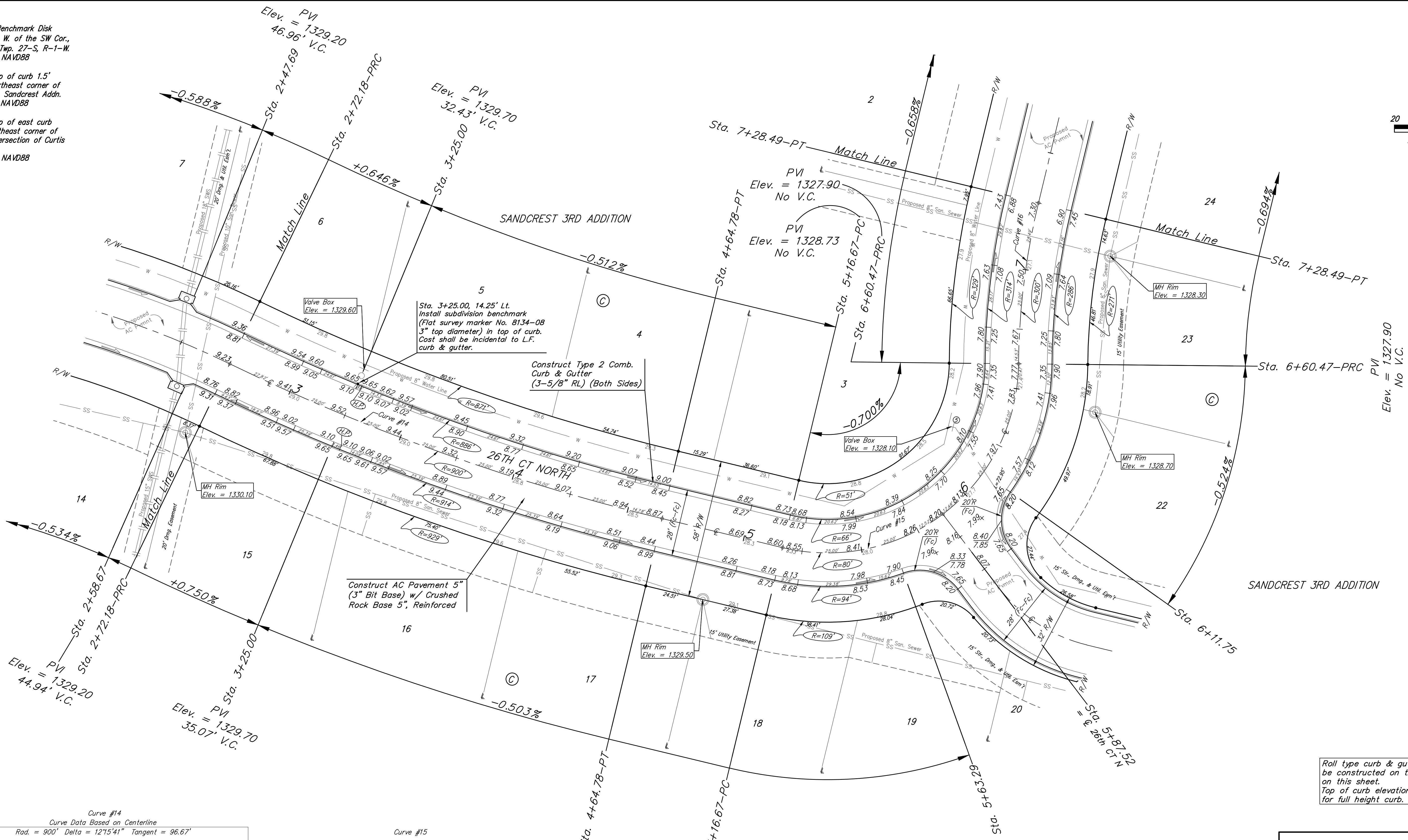
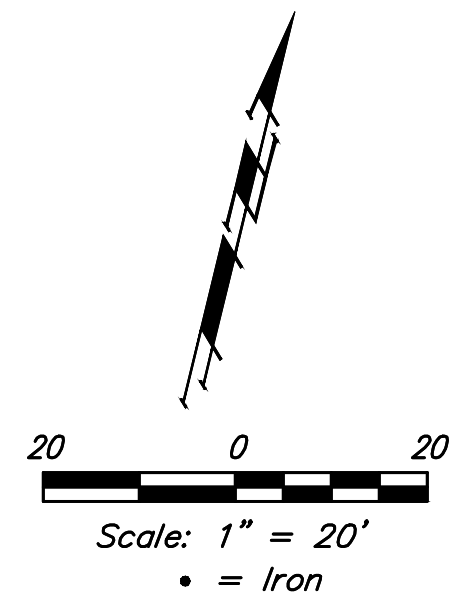

Curve #14
 Curve Data Based on Centerline
 Rad. = 900' Delta = 121°54'11" Tangent = 96.67'
 Arc = 192.60' L.C. = 192.23' Def./Ft. = 1.90987 Min.

Station	Arc	Face Chord Length		Defl.	Total Defl.
		8' Left	8' Right		
2+72.18	-	-	-	0'00"00"	0'00"00"
2+75.00	2.82'	2.75'	2.89'	0'05"23"	0'05"23"
3+00.00	25.00'	24.39'	25.61'	0'47"45"	0'53"08"
3+25.00	25.00'	24.39'	25.61'	0'47"45"	1'40"53"
3+50.00	25.00'	24.39'	25.61'	0'47"45"	2'28"38"
3+75.00	25.00'	24.39'	25.61'	0'47"44"	3'16"22"
4+00.00	25.00'	24.39'	25.61'	0'47"45"	4'04"07"
4+25.00	25.00'	24.39'	25.61'	0'47"45"	4'51"52"
4+50.00	25.00'	24.39'	25.61'	0'47"45"	5'39"37"
4+64.78	14.78'	14.42'	15.14'	0'28"13"	6'07"50"

Curve #15
 Curve Data Based on Centerline
 Rad. = 80' Delta = 102°59'14" Tangent = 100.55'
 Arc = 143.80' L.C. = 125.21' Def./Ft. = 21.48551 Min.

Station	Arc	Face Chord Length		Defl.	Total Defl.
		8' Left	8' Right		
5+16.67	-	-	-	0'00"00"	0'00"00"
5+25.00	8.33'	6.04'	10.62'	2'58"58"	2'58"58"
5+50.00	25.00'	18.05'	31.74'	8'57"09"	11'56"07"
5+75.00	25.00'	18.05'	31.74'	8'57"08"	20'53"15"
6+00.00	25.00'	18.05'	31.74'	8'57"08"	29'50"23"
6+25.00	25.00'	18.05'	31.74'	8'57"09"	38'47"32"
6+50.00	25.00'	18.05'	31.74'	8'57"08"	47'44"40"
6+60.47	10.47'	7.59'	13.34'	3'44"57"	51'29"37"

Curve #16
 Curve Data Based on Centerline
 Rad. = 300' Delta = 12°59'29" Tangent = 34.16'
 Arc = 68.02' L.C. = 67.88' Def./Ft. = 5.72981 Min.

Station	Arc	Face Chord Length		Defl.	Total Defl.
		8' Left	8' Right		
6+60.47	-	-	-	0'00"00"	0'00"00"
6+75.00	14.53'	15.59'	13.46'	1'23"15"	1'23"15"
7+00.00	25.00'	26.83'	23.16'	2'23"15"	3'46"30"
7+25.00	25.00'	26.83'	23.16'	2'23"15"	6'09"45"
7+28.49	3.49'	3.75'	3.23'	0'19"59"	6'29"44"

Roll type curb & gutter to be constructed on the pavement on this sheet. Top of curb elevation are given for full height curb.

	Sandcrest 3rd Addition	
	26TH CT N	
Street / SWS Improvements		
<small>Baughman Company, P.A. 315 Ellis St. Wichita, KS 67211 P 316-262-7271 F 316-262-0149 ENGINEERING SURVEYING PLANNING LANDSCAPE ARCHITECTURE</small>		
PROJECT NUMBER 472-85423	DESIGN AEG	DRAWN JAK
REVISIONS:	APPROVED	DATE 1/15/18
	SCALE Noted	SHEET 14 OF 50

I:\Projects\Sandcrest 3rd Addition_17-06-P296\Engineering\Phase 1\Str. 16114384\STR PLANS.dwg