

**BENCHMARKS:**  
 City of Wichita Benchmark Disk  
 34.9' S. & 31.2' W. of the SW Cor.,  
 NW1/4, Sec. 2, Twp. 27-S, R-1-W.  
 Elev. = 1327.57 NAVD88

"□" cut in top of curb 1.5'  
 north of the northeast corner of  
 Lot 20, Block B, Sandcrest Addn.  
 Elev. = 1327.21 NAVD88

"□" cut in top of east curb  
 inlet at the southeast corner of  
 the southern intersection of Curtis  
 & Sandcrest.  
 Elev. = 1322.05 NAVD88

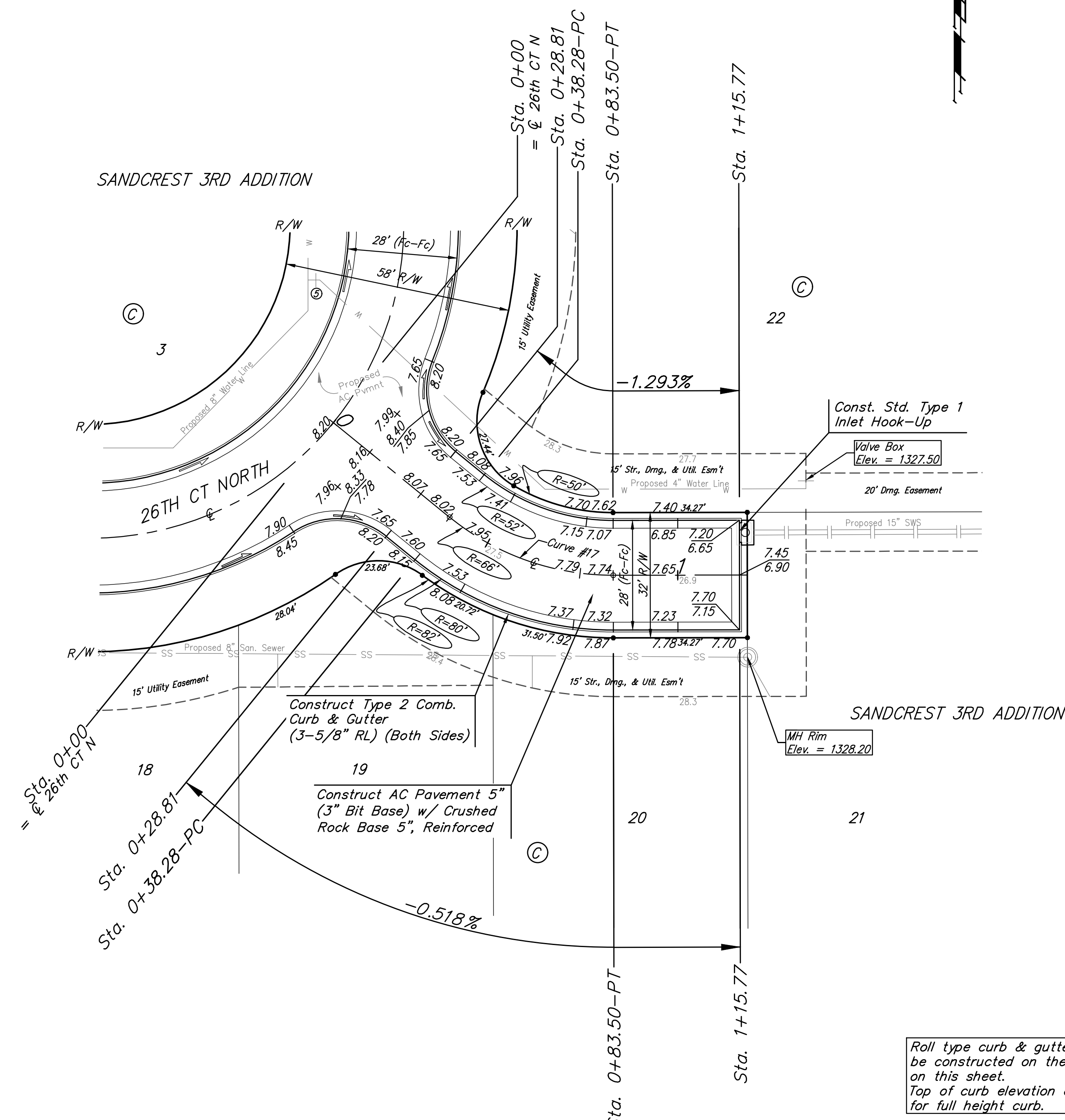
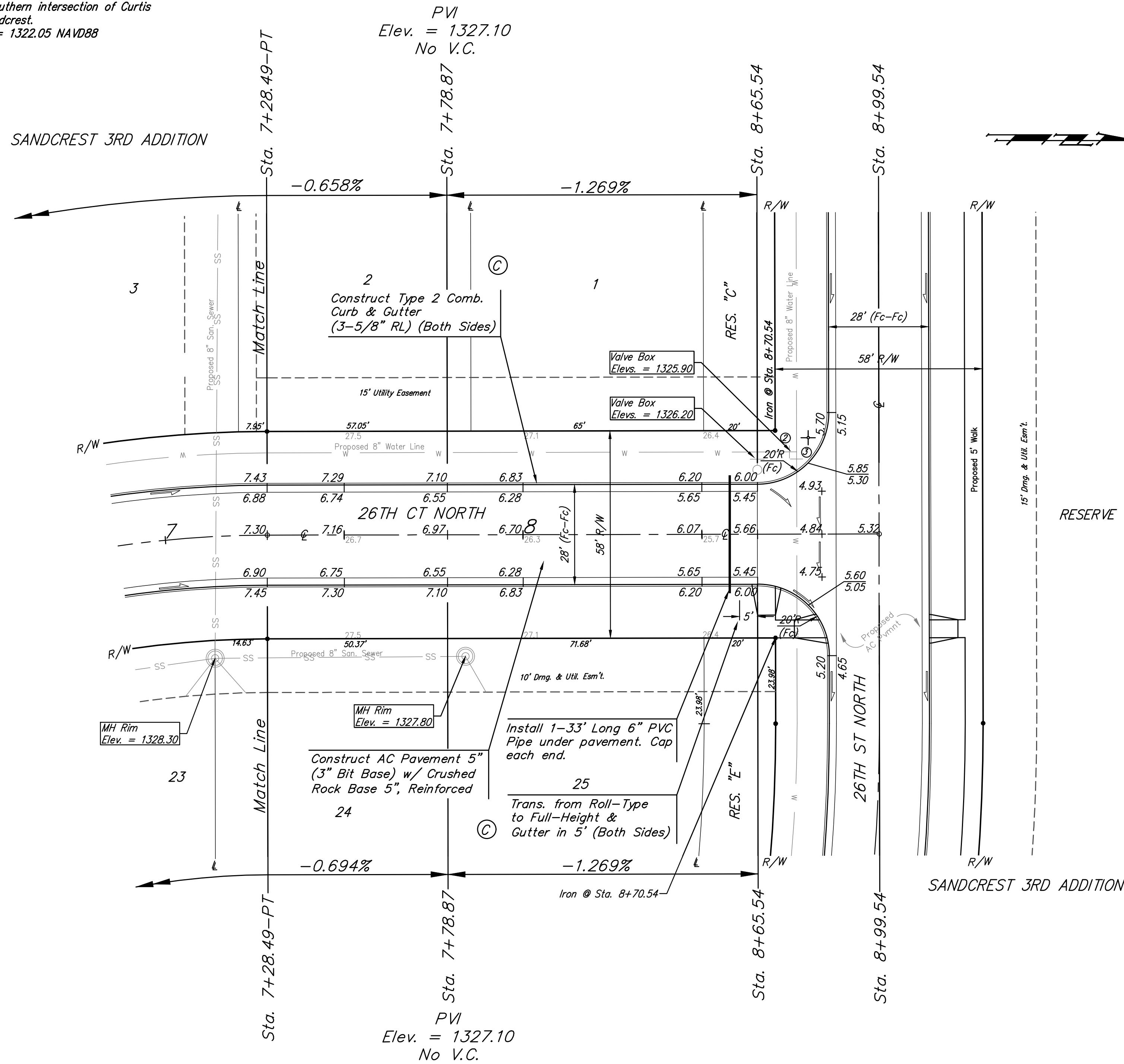
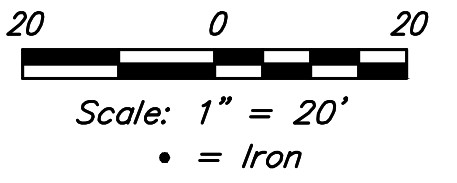

Curve #17  
 Curve Data Based on Centerline  
 Rad. = 66' Delta = 39°15'31" Tangent = 23.54'  
 Arc = 45.22' L.C. = 44.34' Def./Ft. = 26.04508 Min.

Station	Arc	Face Chord Length		Defl.	Total Defl.
		8' Left	8' Right		
0+38.28	-	-	-	0°00'00"	0°00'00"
0+50.00	11.72'	7.80'	15.61'	5°05'15"	5°05'15"
0+75.00	25.00'	16.57'	33.14'	10°51'08"	15°56'23"
0+83.50	8.50'	5.66'	11.33'	3°41'23"	19°37'46"

Roll type curb & gutter to be constructed on the pavement on this sheet.  
 Top of curb elevation are given for full height curb.

	Sandcrest 3rd Addition	
	<b>26TH CT N</b>	
Street / SWS Improvements		
Baughman Company, P.A. 315 Ellis St. Wichita, KS 67211 P 316-262-7271 F 316-262-0149 ENGINEERING   SURVEYING   PLANNING   LANDSCAPE ARCHITECTURE		
PROJECT NUMBER 472-85423	DESIGN AEG	DRAWN JAK
REVISIONS:	APPROVED	DATE 1/15/18
	SCALE Noted	SHEET <b>15 OF 50</b>