

STATE	PROJECT NO.	YEAR	SHEET NO.	TOTAL SHEETS
KANSAS	87 N-0615-01	2017	1	183

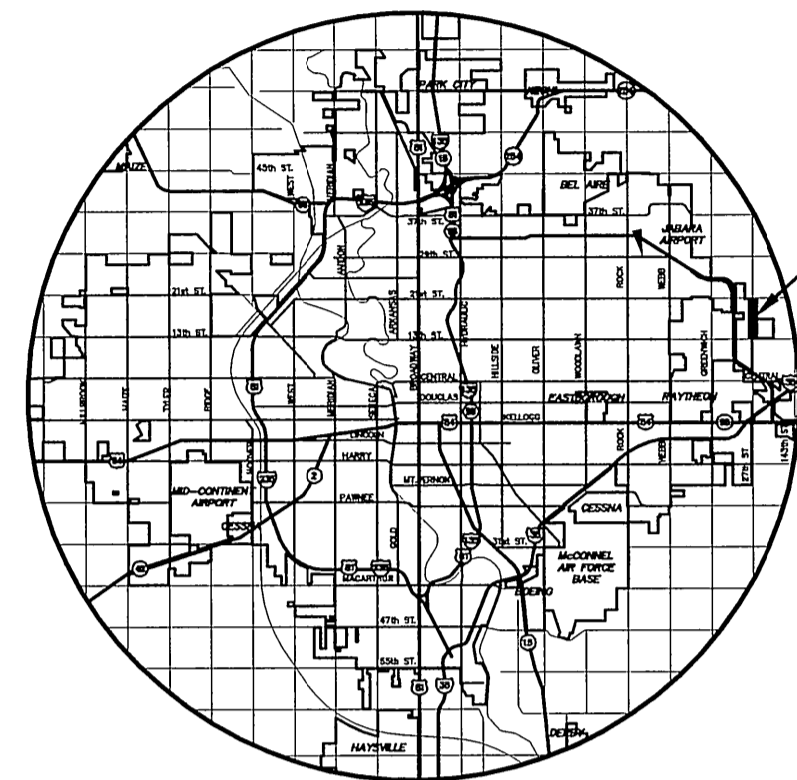

KDOT PROJ. NO. 87 N-0615-01
F.A. NO. STP-N-061(501)

GRADING
SURFACING
STORM SEWER
BRIDGE
PAVEMENT MARKING
SEEDING



LOCATION MAP

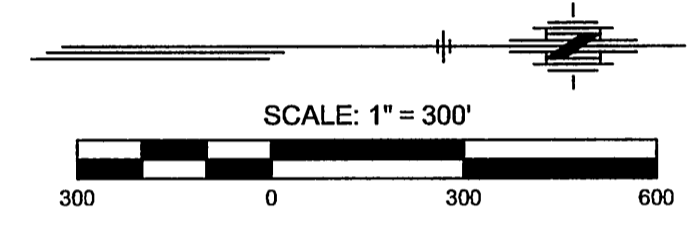

STATE OF KANSAS
DEPARTMENT OF TRANSPORTATION
PLAN AND PROFILE OF PROPOSED
127TH STREET EAST
FROM 13TH STREET NORTH TO 21ST STREET NORTH
FEDERAL AID PROJECT
CITY OF WICHITA PROJECT NO. 472-85158
CITY OF WICHITA OCA NO. 707065
SEDGWICK COUNTY
CITY OF WICHITA

INDEX TO DRAWINGS

SHEET NO.	DESCRIPTION
1	TITLE SHEET
2	GENERAL NOTES
3-4	TYPICAL SECTIONS
5-15	PAVING PLANS
17-19	PAVING BUBBLES MAPS
20	STORM SEWER KEY MAP
21	STORM SEWER SUMMARY
22-35	STORM SEWER PLAN AND PROFILES
36-38	STORM SEWER BUBBLE MAPS
39-54	PAVING DETAILS
55-72	STORM SEWER DETAILS
73	SANITARY SEWER MANHOLE DETAILS
75	MISCELLANEOUS DETAILS
76-80	RETAINING WALL PLAN AND DETAILS
81-101	BRIDGE WIDENING DETAILS
102-109	WATER LINE PLANS AND DETAILS
110	WATER LINE BUBBLE MAPS
111-113	SUMMARY AND RECAPITULATION OF QUANTITIES
114-121	EROSION CONTROL PLAN AND DETAILS
122-126	ROADSIDE IMPROVEMENT PLANS
127	TRAFFIC SIGNAL PLANS
128-133	PAVEMENT MARKING AND SIGNING PLANS AND DETAILS
134	CONSTRUCTION SEQUENCE SUMMARY
135-150	TRAFFIC CONTROL PLANS
151-152	DRAINAGE MAP
153-183	CROSS SECTIONS

Sta. 23+78.56 Const.
 Br. No. 530400870WBFM20
 30'-40'-30' R.C.
 Haunched Slab Spans
 48'-0" Roadway
 6'-0" Walkway, Lt.
 30° Skew Rt.

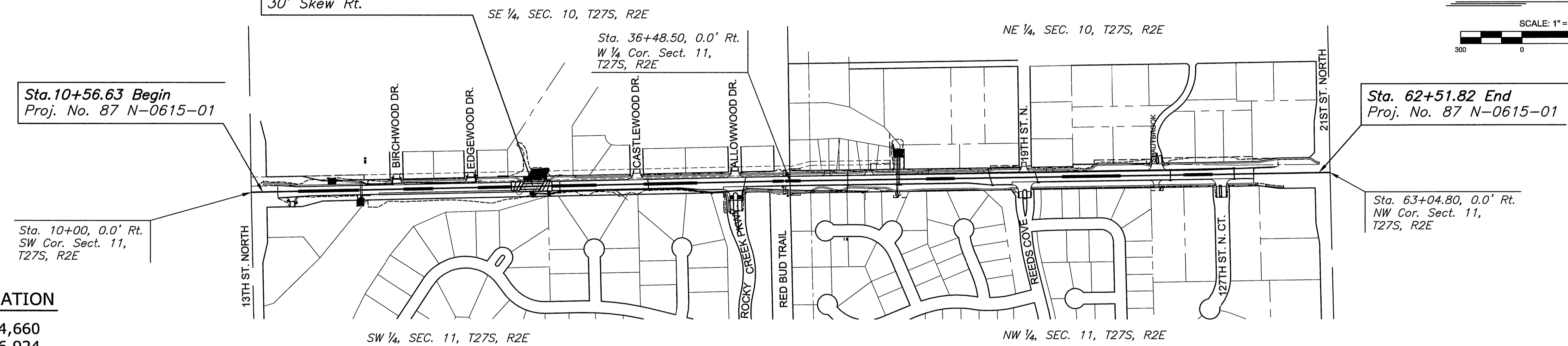

Sta. 62+51.82 End
 Proj. No. 87 N-0615-01

Sta. 63+04.80, 0.0' Rt.
 NW Cor. Sect. 11,
 T27S, R2E

Sta. 10+56.63 Begin
 Proj. No. 87 N-0615-01

Sta. 10+00, 0.0' Rt.
 SW Cor. Sect. 11,
 T27S, R2E

DESIGN DESIGNATION

- AADT (2014) = 4,660
- AADT (2034) = 6,924
- DHV = 10%
- D = 60%
- T = 3%
- V = 40 MPH
- C of A = None
- Lateral Offset = 2 FT.

CONVENTIONAL SIGNS

COUNTY LINE	-----	CENTER LINE OF PROJECT	-----
CITY LIMITS	-----	TERRACE	-----
STATE OR NATIONAL LINE	-----	CULVERTS	-----
TOWNSHIP, SECTION or GRANT LINE	-----	DROP INLET & STORM SEWER	-----
PROPERTY LINE	-----	ACCESS CONTROL	-----
HIGHWAY FENCE	-----	POWER POLE	-----
EXISTING FENCE	-----	TELEPHONE POLE	-----
GUARDRAIL	-----	MARSH	-----
CONSTRUCTION LIMITS	-----	HEDGE	-----
RIGHT OF WAY LINE	-----	TREES	-----
TRAVELED WAY	-----	PROFILE ELEVATION	-----
RAILROADS	-----	STREAM or CREEK	-----

GROSS LENGTH OF PROJECT	5,195.19	FT.
EXCEPTIONS	0.00	FT.
ADDITIONS	0.00	FT.
NET LENGTH OF PROJECT	5,195.19	FT. 0.984 MILES
NET LENGTH OF BRIDGES	102.94	FT. 0.019 MILES
NET LENGTH OF ROAD	5,092.25	FT. 0.889 MILES

NOTE: ONE LANE NORTH BOUND TRAFFIC TO BE CARRIED THROUGH CONSTRUCTION. LOCAL TRAFFIC WILL BE PERMITTED TO ADJACENT PROPERTIES.

NOTE: THE PIPES ON THIS PROJECT ARE IN ACCORDANCE WITH THE CURRENT KDOT PIPE POLICY.

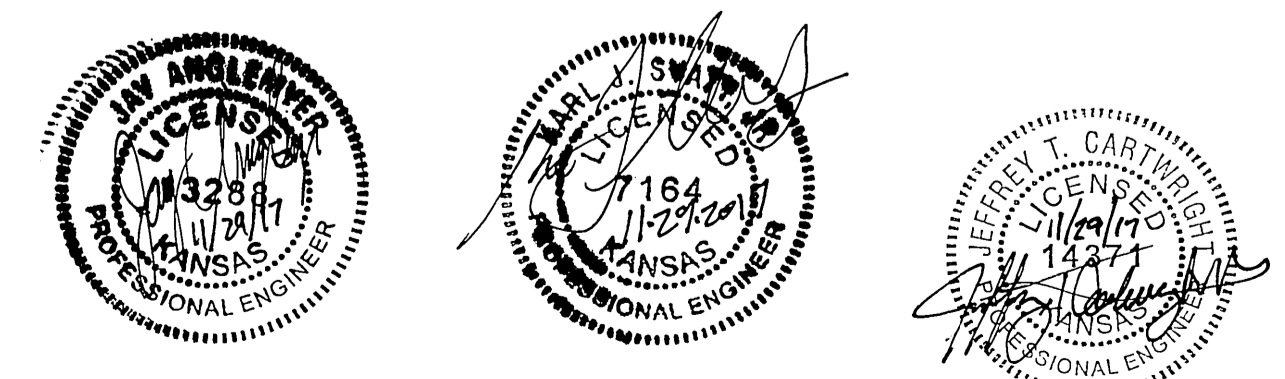

APPROVED - DATE
 Gary Janzen 11/30/17
 GARY JANZEN, P.E.
 CITY ENGINEER

STREET IMPROVEMENTS FOR
127TH STREET EAST
 FROM 13TH STREET NORTH TO 21ST STREET NORTH

©2017 MKEC Engineering All Rights Reserved www.mkec.com
 These drawings and their contents, including, but not limited to, all concepts, designs, & ideas are the exclusive property of MKEC Engineering (MKEC), and may not be used or reproduced in any way without the express consent of MKEC.

TITLE SHEET

PROJECT NO.	472-85158	
DATE	11/29/17	
SCALE	1"=300'	
DESIGNED	JRA	
DRAWN	DM	
CHECKED	JRA	
NO.	REVISION	DATE
SHEET NO.		
1 OF 183		