

STATE	PROJECT NO.	YEAR	SHEET NO.	TOTAL SHEETS
KANSAS	87 N-0615-01	2017	95	183



STREET IMPROVEMENTS FOR
127TH STREET EAST
 FROM 13TH STREET NORTH TO 21ST STREET NORTH

©2017 MKEC Engineering All Rights Reserved www.mkec.com
 These drawings and their contents, including, but not limited to, all concepts, designs, & ideas are the exclusive property of MKEC Engineering (MKEC), and may not be used or reproduced in any way without the express consent of MKEC.

CONCRETE RIPRAP

PROJECT NO.	472-85158	
DATE	11/29/17	
SCALE	1"=10'	
DESIGNED	DRAWN	CHECKED
DMU	RAM	DMU

NO.	REVISION	DATE

SHEET NO.

95 OF 183

J:\PROJECTS\2017\1401040280 - COM_127THE_13TH TO 21ST\05-CIVIL\CAO\BRIDGE\142802P01.DWG
 PLOTTED: Wednesday, November 29, 2017 @ 03:17PM

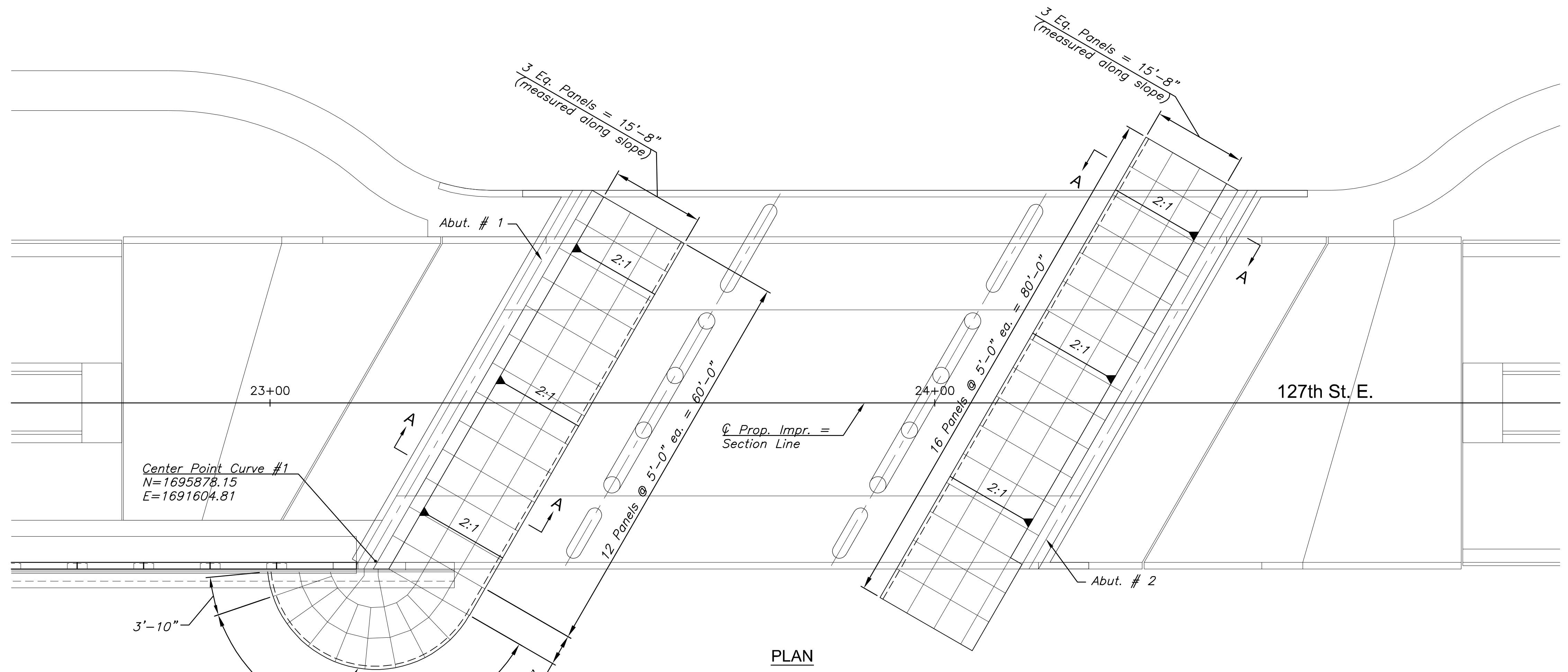

PLAN

8 Panels @ 4'-8"
(Dim. along Curve #1)

CURVE #1 DATA	
Radius	16.31
Curve Length	41.125
Total Deflection	144'

NOTES:

- Use Concrete (Grade 3.0)(AE) for the riprap.
- Use 6x6 - W1.4 x W1.4 welded wire fabric conforming to the requirements of ASTM A185.
- Use reinforcing steel conforming to the requirements of ASTM A615, Grade 60.
- Place 1/2" Type B expansion material in the joints caused by any intersection of the riprap with the abutment, wings, or columns.
- Measurement of the "Reinforced Concrete Riprap" shall be in square yards and is based on the outside surface area.
- The toe walls, Type B expansion material, welded wire fabric, and reinforcing steel are *subsidiary* to the bid item "Reinforced Concrete Riprap".

REINFORCED CONCRETE RIPRAP

Location	Quantity
Abutment No. 1	168.06 Sq. Yds.
Abutment No. 2	157.04 Sq. Yds.

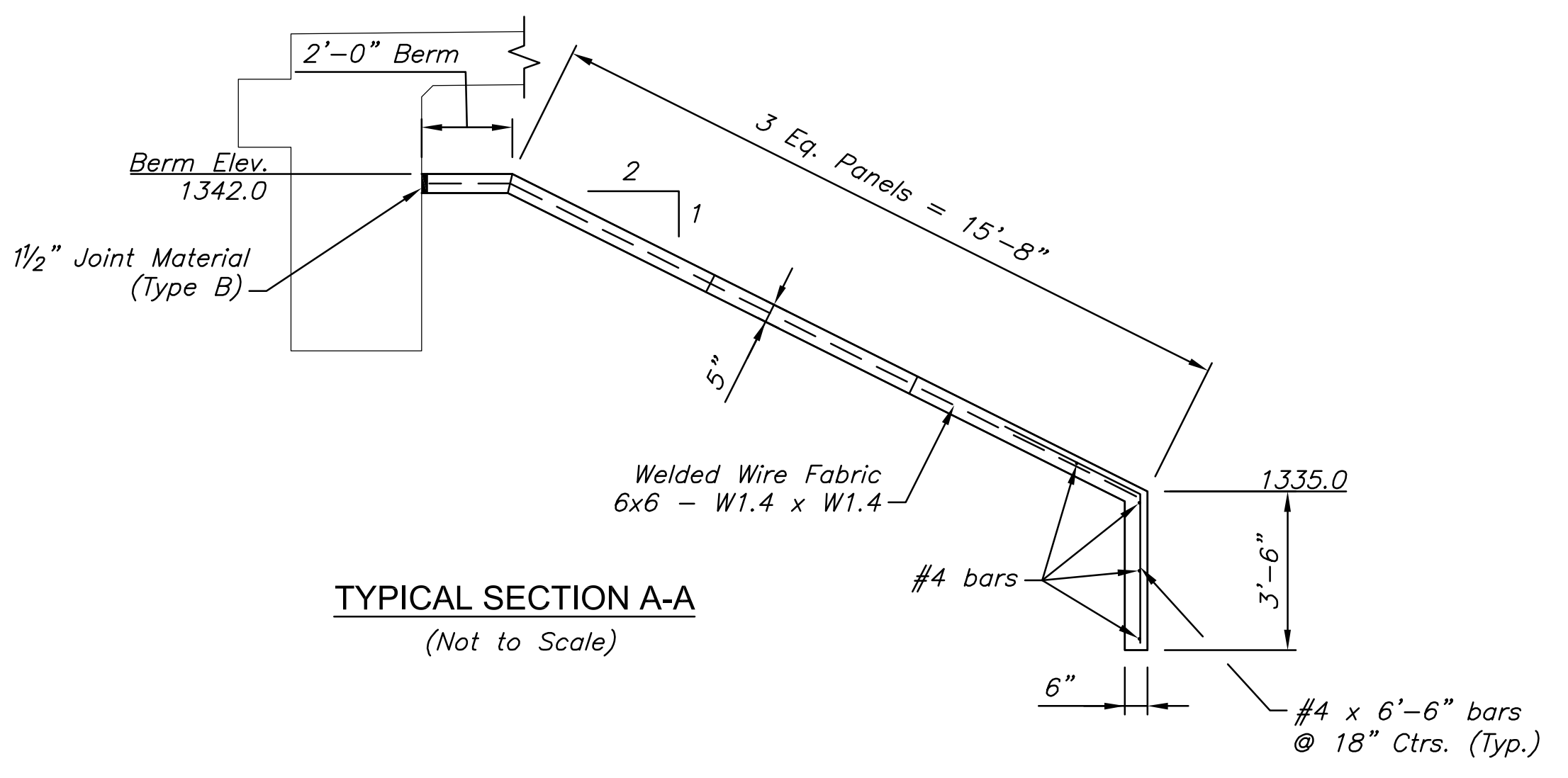

TYPICAL SECTION A-A
(Not to Scale)