

Edward Rose Development Co. LLC
 PO Box 3015
 Kalamazoo, MI 49003
 Lot 1
 STONEY POINTE ADDITION

NOTE: Trees to be removed are marked as such:

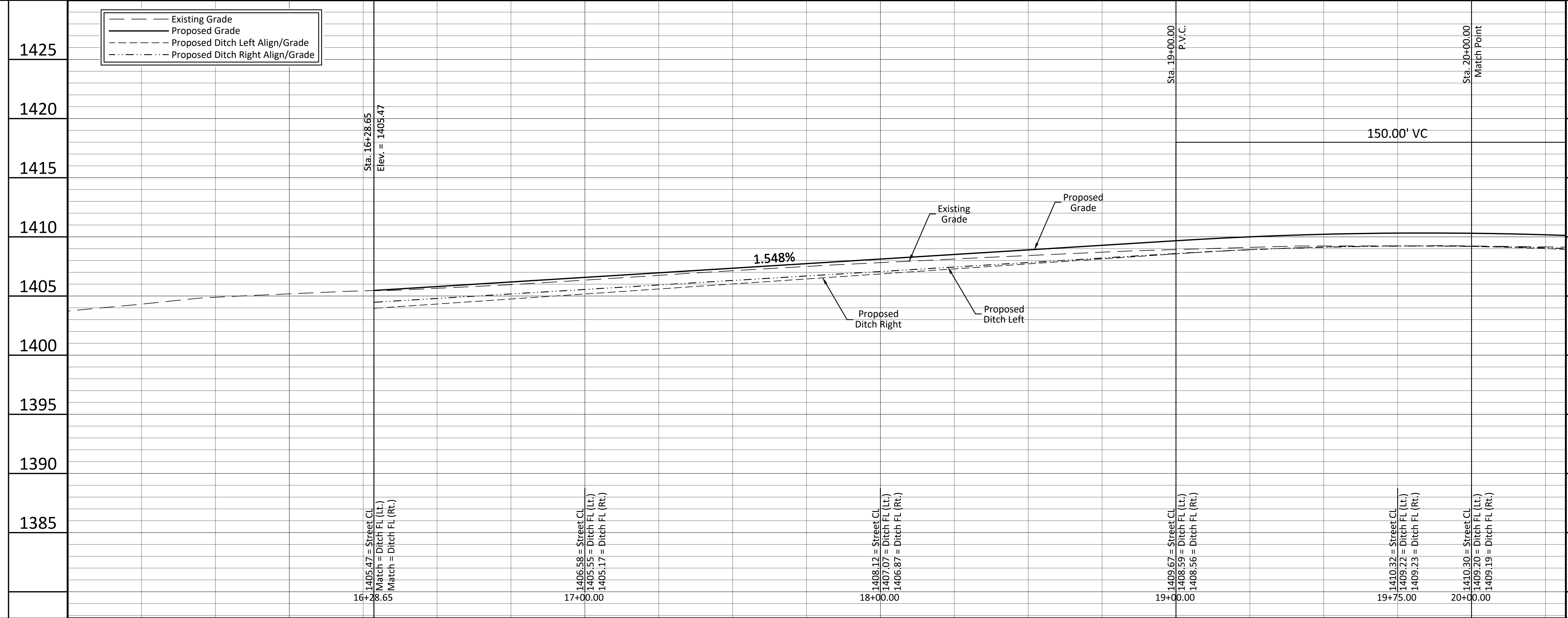

Existing Grade
 Proposed Grade
 Proposed Ditch Left Align/Grade
 Proposed Ditch Right Align/Grade

1405.47 = Street CL
 1405.55 = Ditch FL (Lt.)
 1405.17 = Ditch FL (Rt.)

1406.58 = Street CL
 1407.07 = Ditch FL (Lt.)
 1406.87 = Ditch FL (Rt.)

1408.12 = Street CL
 1407.22 = Ditch FL (Lt.)
 1406.87 = Ditch FL (Rt.)

1409.67 = Street CL
 1408.59 = Ditch FL (Lt.)
 1408.56 = Ditch FL (Rt.)

1410.32 = Street CL
 1409.22 = Ditch FL (Lt.)
 1409.23 = Ditch FL (Rt.)

1410.30 = Street CL
 1409.20 = Ditch FL (Lt.)
 1409.19 = Ditch FL (Rt.)

BAUGHMAN COMPANY
 315 Ellis St. Wichita, KS 67211 316-262-7271
 baughmanCo.com

CAPITAL IMPROVEMENT PROJECT
29TH STREET PAVING
 Sta. 16+28.65 - Sta. 20+00.00
 29TH & 127TH STREET PAVING

PROJECT NUMBER: 472-85344
 INTERNAL NUMBER: 17-02-E657
 DESIGN: LP
 DRAWN: LP
 DATE: Dec, 2017
 SHEET
 OF
4
39