

BENCHMARKS:

BM #1: Brass Disc on Top of Curb near the SW corner of Lot 67, Block D, near fire hydrant at NE corner of Cimarron & Driftwood, Edge Water Addition
Elev. = 1339.44 NGVD29

BM #2: "□" on Top of Curb, SE Corner of Lot 21, Block A; west side of Ridge Port, Edge Water Addition
Elev. = 1336.02 NGVD29

BM #3: Brass Disc on Top of Curb near the NE corner of Lot 27, Block A, near fire hydrant at SW corner of Ridge Port & Ridge Port Ct., Edge Water Addition
Elev. = 1337.42 NGVD29

Subdivision Bench Marks		
Street & Station	Location Description	Elevation
Ridge Port 0+29.81, 27.25' Rt.	Adjacent to Fire Hydrant at E. End of S. Curb Return of Ridge Port & Ridge Port Ct.	

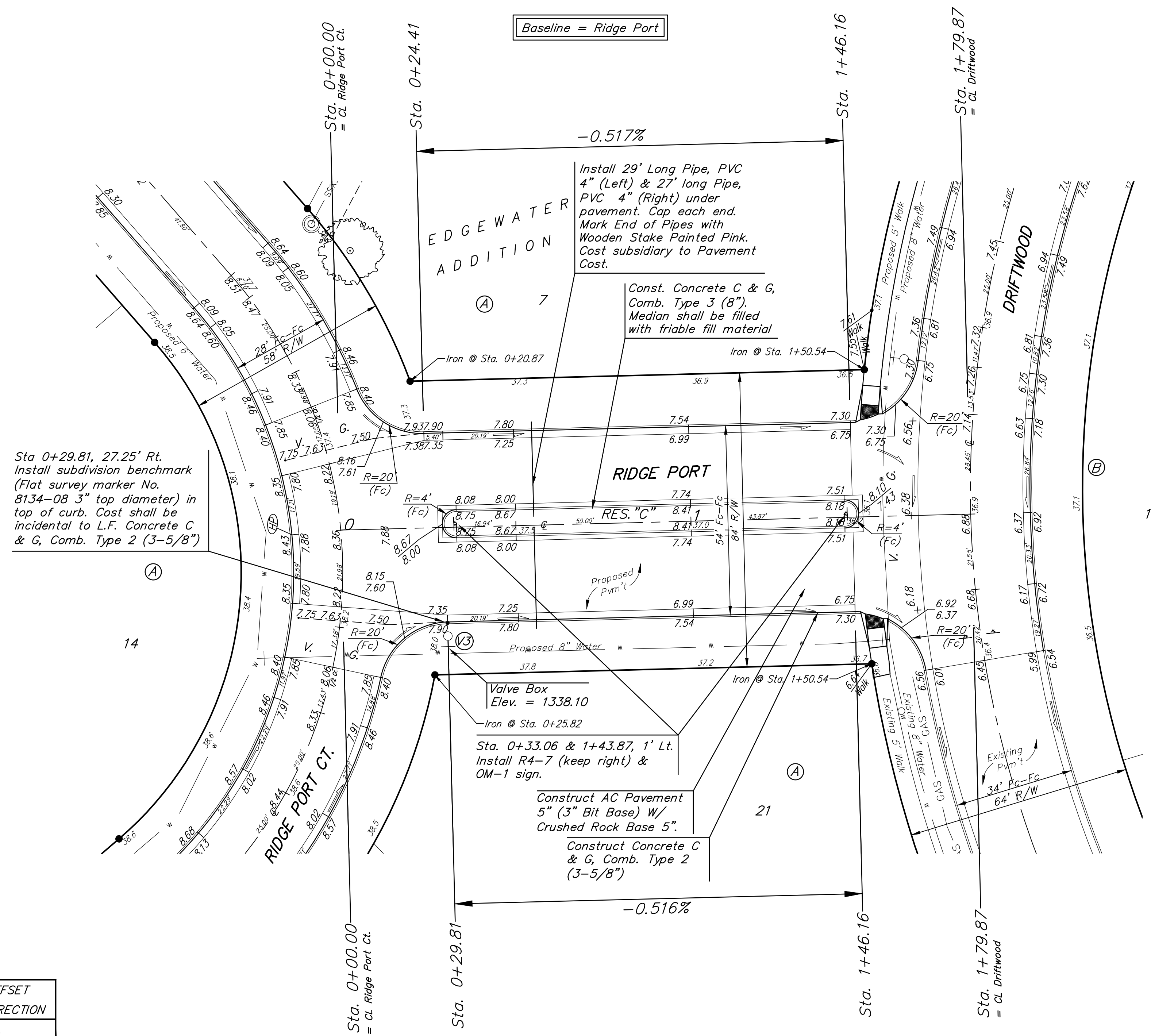
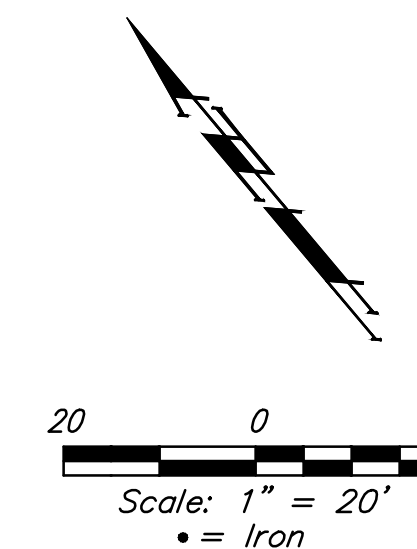

WATER VALVE LOCATION TABLE

VALVE NUMBER	STREET	BASELINE STATION	OFFSET DISTANCE	OFFSET DIRECTION
V3	Ridge Port	0+29.81	36'	Rt.

Paving contractor will be responsible to operate all water valves on the project, in the presence of the inspector, to ensure accessibility to the valves, and that all valves (except blowoffs) are left in the "ON" position when the project is completed.

NOTE: ROLL TYPE CURB & GUTTER (TYPE 2) TO BE CONSTRUCTED ON THE PAVEMENT SHOWN ON THIS SHEET. TOP OF CURB ELEVATIONS ARE GIVEN FOR FULL HEIGHT CURB (TYPE 4).