

BENCHMARKS:

BM #1: Brass Disc on Top of Curb near the SW corner of Lot 67, Block D, near fire hydrant at NE corner of Cimarron & Driftwood, Edge Water Addition
Elev. = 1339.44 NGVD29

BM #2: "□" on Top of Curb, SE Corner of Lot 21, Block A; west side of Ridge Port, Edge Water Addition
Elev. = 1336.02 NGVD29

BM #3: Brass Disc on Top of Curb near the NE corner of Lot 27, Block A, near fire hydrant at SW corner of Ridge Port & Ridge Port Ct., Edge Water Addition
Elev. = 1337.42 NGVD29

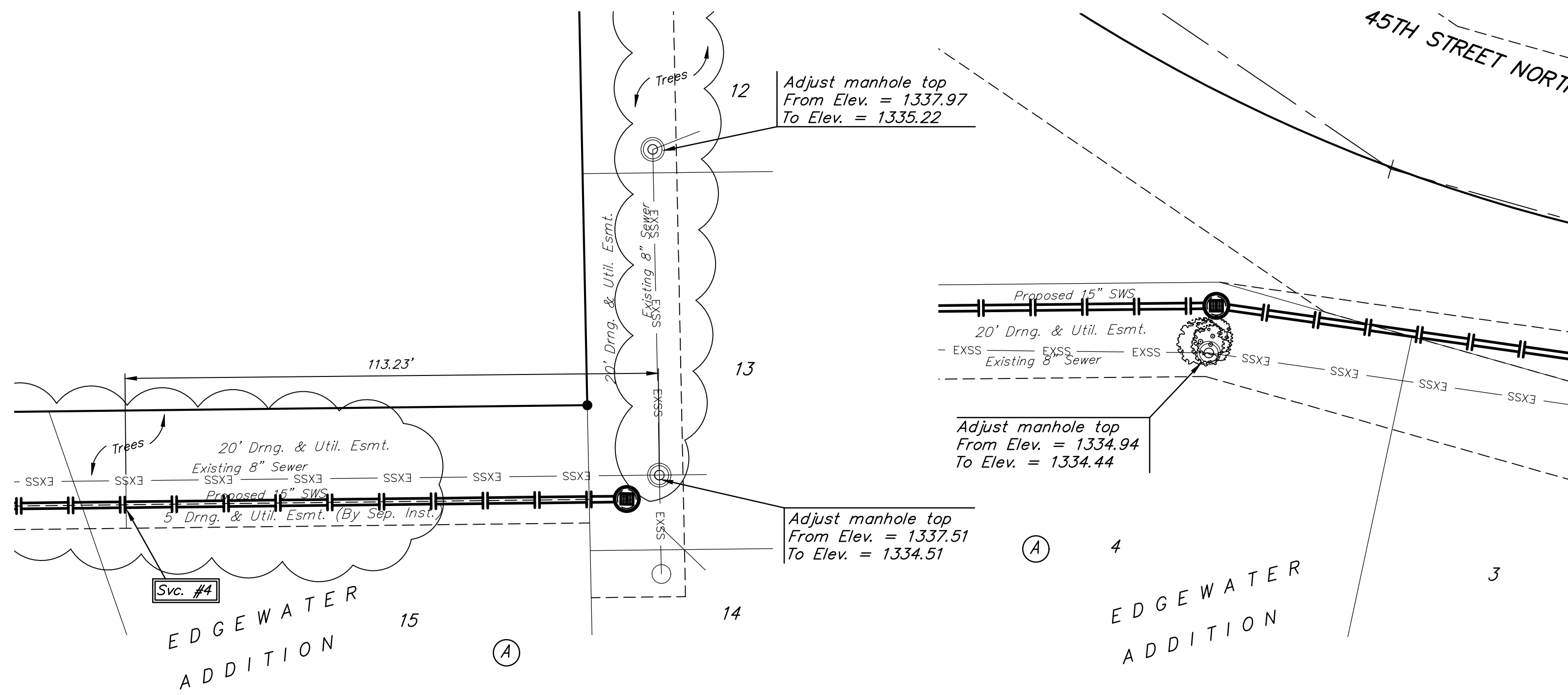
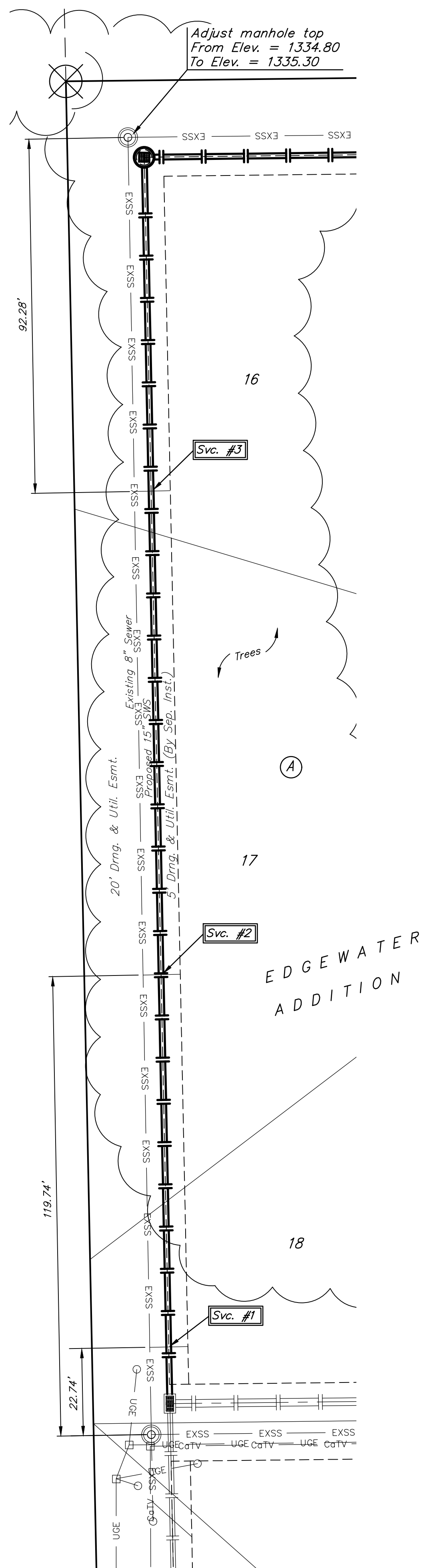

SEWER SERVICE TABLE

NUMBER	TYPE	LOCATION				FOR INFORMATION ONLY	
		LOT NO.	BLOCK NO.	LINE NO.	STATION DIRECTION	APPROXIMATE LENGTH 4" PIPE VERTICAL	HORIZONTAL
1	8" X 4" Tee	18	A	-	-	-	9.9'
2	8" X 4" Tee	17	A	-	-	-	9.7'
3	8" X 4" Tee	16	A	-	-	-	9.4'
4	8" X 4" Tee	15	A	-	-	-	10.2'

NOTE: Vertical Riser Pipe shall be extended to 2' minimum above ground water elevation and 4' maximum below proposed ground elevation.