

FHWA REG. NO.	STATE	PROJECT NO.	YEAR	SHEET NO.	TOTAL SHEETS
7	KANSAS	87 N-0199-01	2002	85	158
FED. AID NO. - CMQ-NO19(901)					

N. 21st STREET

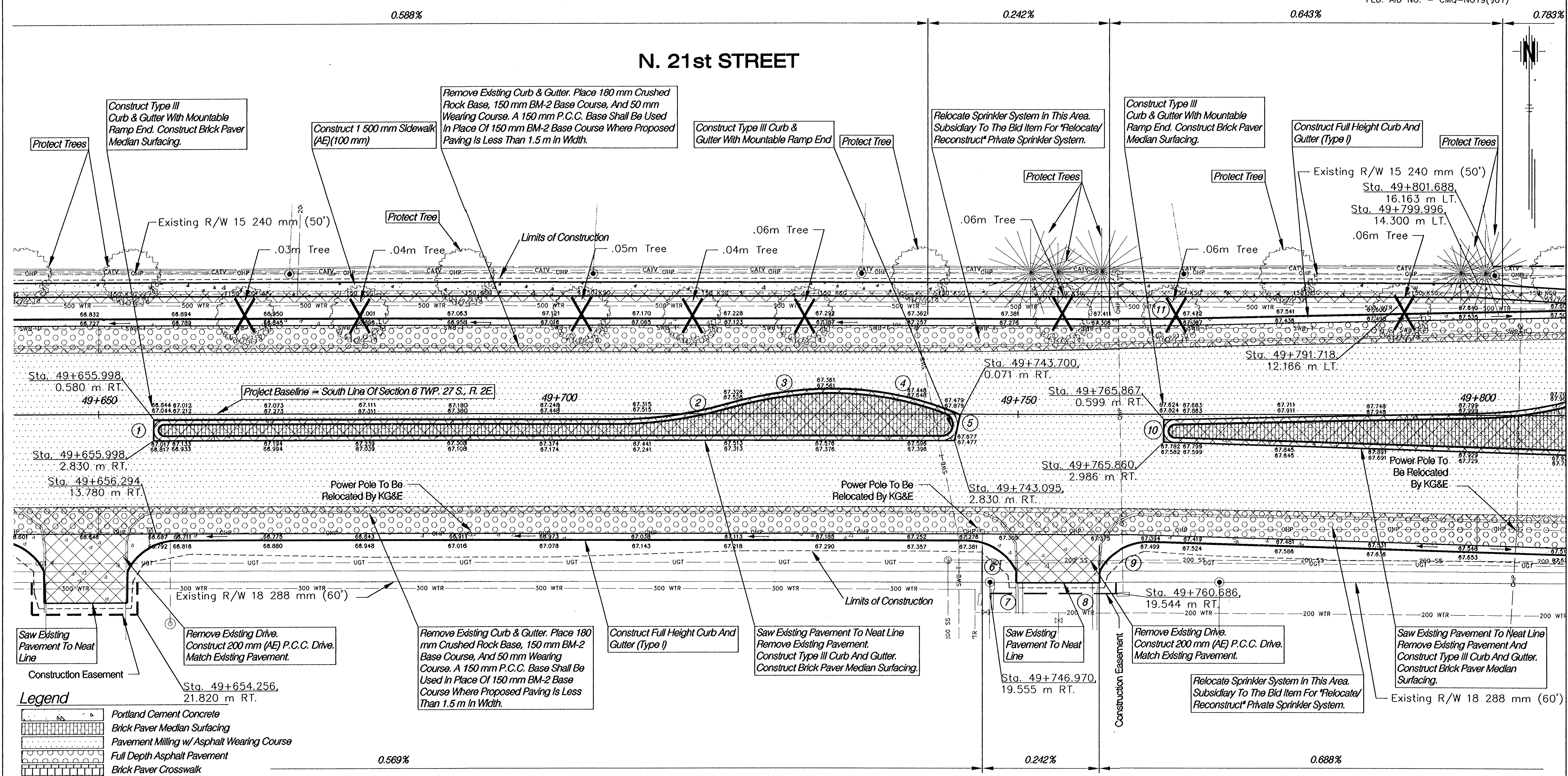

- Legend**
- Portland Cement Concrete
 - Brick Paver Median Surfacing
 - Pavement Milling w/ Asphalt Wearing Course
 - Full Depth Asphalt Pavement
 - Brick Paver Crosswalk
 - Concrete Base w/ Asphalt Wearing Course
 - Pavement Removal
 - Control Point
 - Existing Property Pin (Found)
 - Water Flow
 - Construction Easement
 - Permanent Easement
 - Proposed Right Of Way
 - Existing Right Of Way
 - Geometrics, See Sheet 93 For Data

Note: Elevations Are At Even 10 m Stations Unless Otherwise Noted.

N. 21st STREET PLAN
STA. 49+650 - 49+800

HWS Consulting Group Inc

Omaha Office
 10844 Old Mill Rd., Ste 1
 Omaha, NE 68154
 Phone: (402) 333-5792
 Fax: (402) 333-2248

Designed By: BWE	Checked By: RJK
Drawn By: HS	Date: 03-25-2002 Job No: 55-70-2003

See Sheets 20 To 43 For Construction Phasing