

BENCHMARKS:
 BM #1: Benchmark on top of north 48" headwall in Reserve "B" between Lots 18-19, Block B, Falcon Falls 3rd Addition. Elev. = 1349.35 NGVD29

BM #2: Benchmark on top of north 48" headwall in Reserve "C" north of the NE corner of Lots 30, Block C, Falcon Falls 3rd Addition. Elev. = 1343.63 NGVD29

Curve #1					
Curve Data Based on Centerline					
Rad. = 100'		Delta = 90° 00' 00"		Tangent = 100.00'	
Arc = 157.08'		L.C. = 141.42'		Def./Ft. = 17.18869 Min.	
Station	Arc	8' Left	8' Right	Defl.	Total Defl.
0+72.00	-	-	-	0° 00' 00"	0° 00' 00"
1+00.00	28.00'	20.93'	34.89'	8° 01' 17"	8° 01' 17"
1+10.70	10.70'	8.02'	13.37'	3° 03' 55"	11° 05' 12"
1+25.00	14.30'	10.72'	17.86'	4° 05' 48"	15° 11' 00"
1+35.78	10.78'	8.08'	13.47'	3° 05' 18"	18° 16' 18"
1+50.00	14.22'	10.66'	17.76'	4° 04' 25"	22° 20' 43"
1+60.86	10.86'	8.14'	13.57'	3° 06' 40"	25° 27' 23"
1+75.00	14.14'	10.60'	17.66'	4° 03' 03"	29° 30' 26"
2+00.00	25.00'	18.70'	31.17'	7° 09' 43"	36° 40' 09"
2+25.00	25.00'	18.70'	31.17'	7° 09' 43"	43° 49' 52"
2+29.08	4.08'	3.06'	5.10'	1° 10' 08"	45° 00' 00"

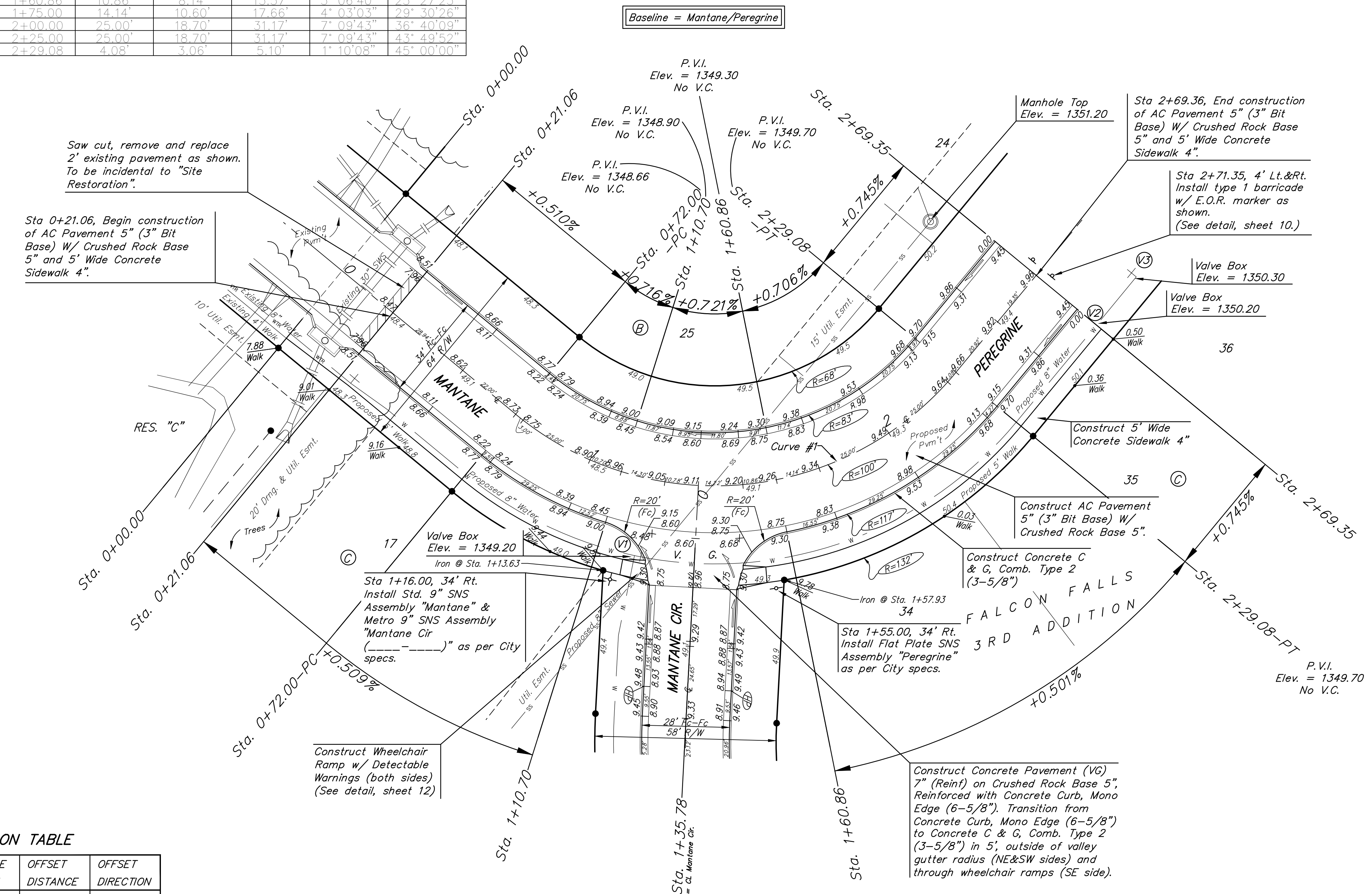
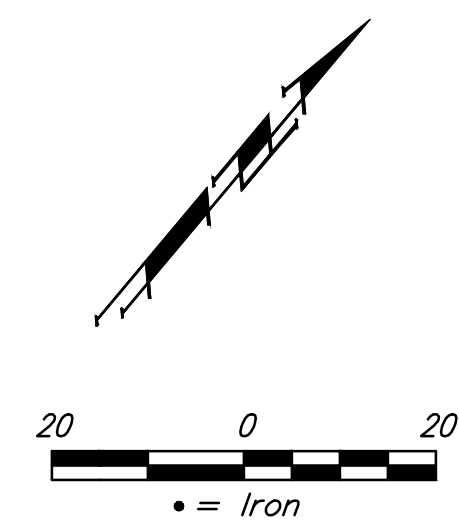

WATER VALVE LOCATION TABLE

VALVE NUMBER	STREET	BASELINE STATION	OFFSET DISTANCE	OFFSET DIRECTION
V1	Mantane	1+20.34	27'	Rt.
V2	Peregrine	2+69.35	27'	Rt.
V3	Peregrine	2+89.35	27'	Rt.

Paving contractor will be responsible to operate all water valves on the project, in the presence of the inspector, to ensure accessibility to the valves, and that all valves (except blowoffs) are left in the "ON" position when the project is completed.

NOTE: ROLL TYPE CURB & GUTTER (TYPE 2) TO BE CONSTRUCTED ON THE PAVEMENT SHOWN ON THIS SHEET. TOP OF CURB ELEVATIONS ARE GIVEN FOR FULL HEIGHT CURB (TYPE 4).