

BENCHMARKS:
 BM #1: Benchmark on top of north 48" headwall in Reserve "B" between Lots 18-19, Block B, Falcon Falls 3rd Addition.
 Elev. = 1349.35 NGVD29

BM #2: Benchmark on top of north 48" headwall in Reserve "C" north of the NE corner of Lots 30, Block C, Falcon Falls 3rd Addition.
 Elev. = 1343.63 NGVD29

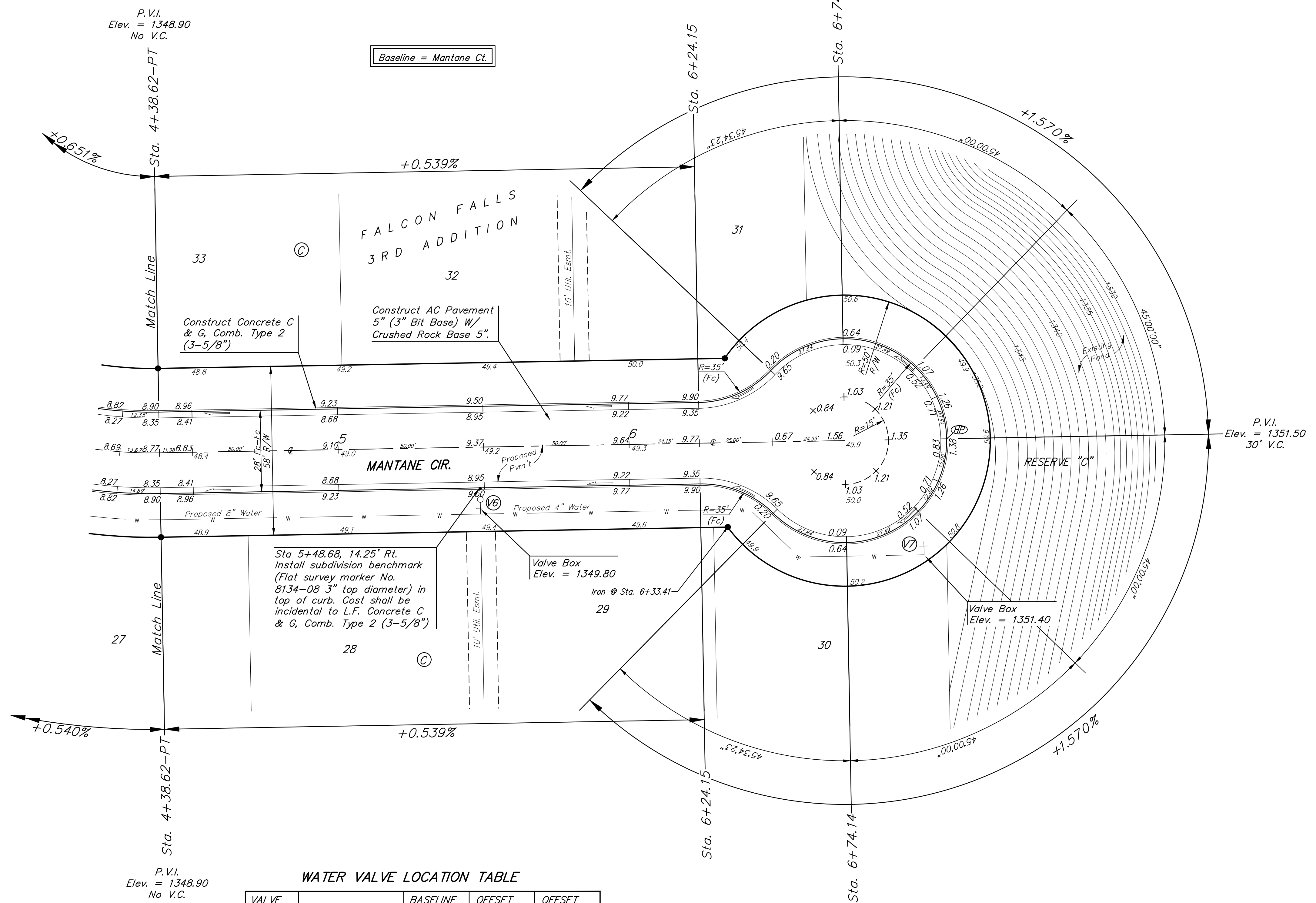
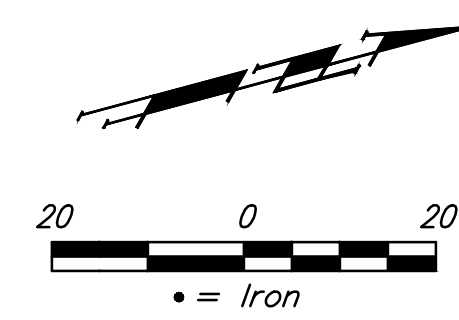

P.V.I.
 Elev. = 1348.90
 No V.C.

Baseline = Mantane Ct.

P.V.I.
 Elev. = 1351.50
 30' V.C.

WATER VALVE LOCATION TABLE

VALVE NUMBER	STREET	BASELINE STATION	OFFSET DISTANCE	OFFSET DIRECTION
V6	Mantane Cir.	5+48.68	23.00'	Rt.
V7	Mantane Cir.	7+00.69	39.73'	Rt.

Paving contractor will be responsible to operate all water valves on the project, in the presence of the inspector, to ensure accessibility to the valves, and that all valves (except blowoffs) are left in the "ON" position when the project is completed.

Subdivision Bench Marks

Street & Station	Location Description	Elevation
Mantane Cir. 5+48.68, 14.25' Rt.	Adjacent to Fire Hydrant adjacent to common front lot corner of Lots 28 & 29, Block C, Falcon Falls 3rd Add.	

NOTE: ROLL TYPE CURB & GUTTER (TYPE 2) TO BE CONSTRUCTED ON THE PAVEMENT SHOWN ON THIS SHEET. TOP OF CURB ELEVATIONS ARE GIVEN FOR FULL HEIGHT CURB (TYPE 4).

Baughman Company, P.A.
 ENGINEERING ARCHITECT PLANNING LANDSCAPE ARCHITECTURE
 Design/Arch/Draw/Title/Approval/Date/Sheet/Total
 Baughman

FALCON FALLS 3RD ADD. PH. 3A
MANTANE CIR.
 STREET IMPROVEMENTS