

Existing 8" Water to Remain  
(Sta. 33+44.79, 40.00' Lt. -  
Sta. 33+45.60, 21.10' Rt.)

**CAUTION!**  
Gas Crossing  
(x2)

NOTE: Water Probes Acquired by the City of Wichita. Existing Waterline Top of Pipe in Profile View Based on Nearest Water Probe

### WATER LINE 1

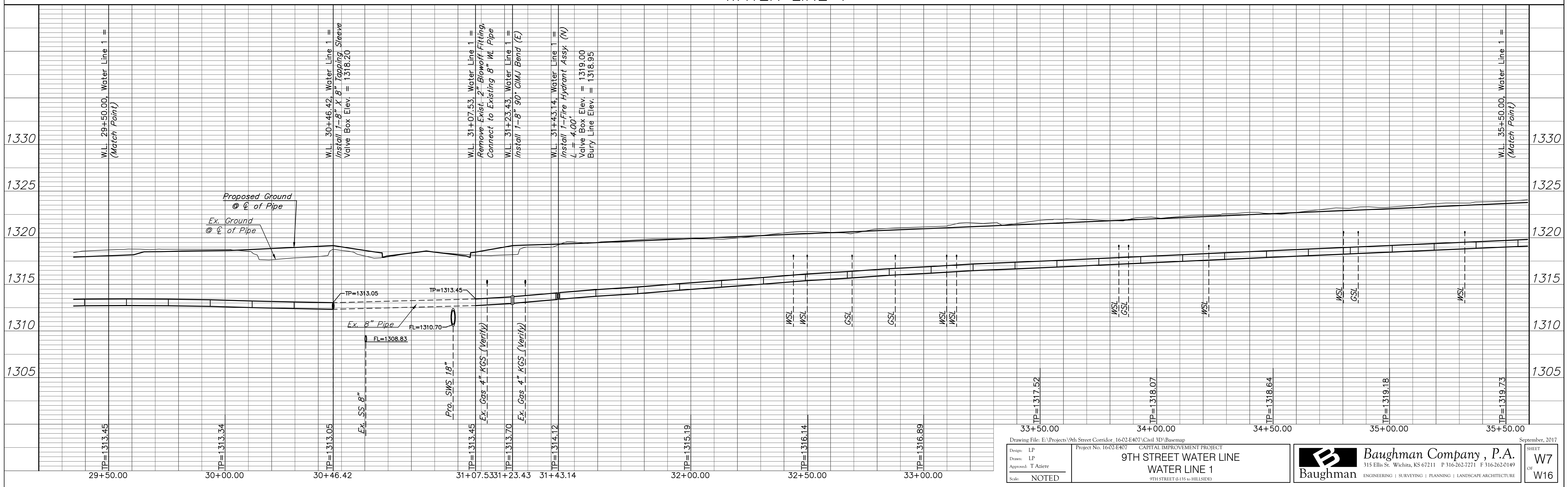

Drawing File: E:\Projects\9th Street Corridor 16-02-E407\Civil 3D\Basemap Design: LP Drawn: LP Approved: T Alieri Scale: NOTED		Project No. 16-02-E407 <b>CAPITAL IMPROVEMENT PROJECT</b> <b>9TH STREET WATER LINE</b> <b>WATER LINE 1</b> <small>9TH STREET (I-35 to HILLSIDE)</small>		September, 2017 <b>Baughman Company, P.A.</b> <small>315 Ellis St. Wichita, KS 67211 P 316-262-7271 F 316-262-0149</small> <b>Baughman</b> ENGINEERING   SURVEYING   PLANNING   LANDSCAPE ARCHITECTURE		SHEET <b>W7</b> OF <b>W16</b>
--	--	---	--	---	--	--