

I-135 9TH ST. EXIT RAMP DETOUR
Not to Scale

NOTE: Install VMS Advance Warning Sign in the Days Prior to Planned Closure of the Exit Ramp. To be Paid for Under the Bid Item - "Signing Elec. Portable Message"

NOTE: Prior to Ramp Closure, Mark Overhead Signs for the 9th Street Exit Ramp as CLOSED

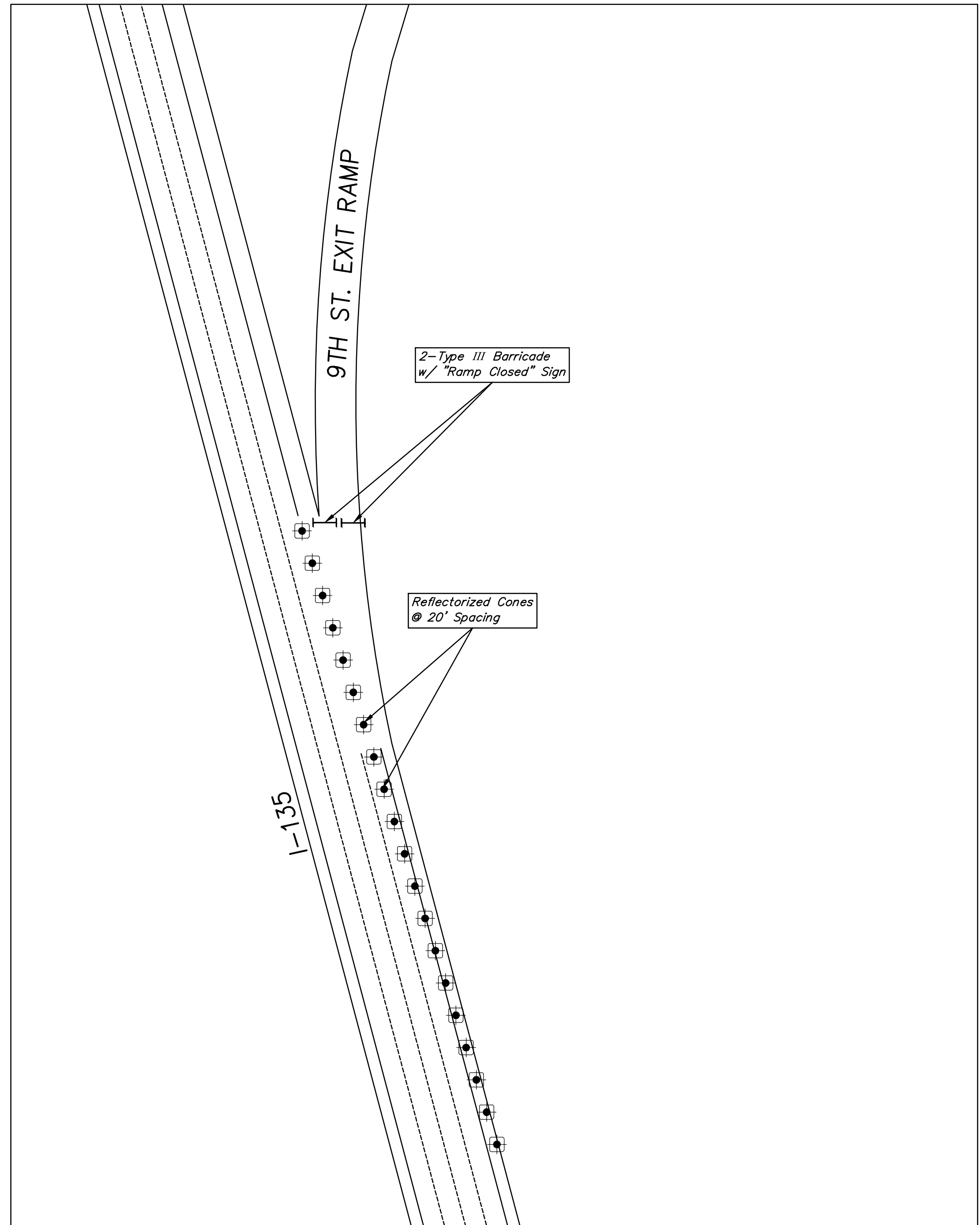

TRAFFIC CONTROL PLAN LEGEND

- DENOTES WORK ZONE
 - DENOTES TRAFFIC FLOW
 - DENOTES REFLECTORIZED CONES
 - DENOTES TUBULAR MARKERS
 - DENOTES TYPE III BARRICADE
 - DENOTES TRAFFIC SIGN
- NO SCALE

EXIT RAMP CLOSURE
1" = 50'