

BENCHMARK:

BM #8 - Chiseled "X" in the Sidewalk, 220' East of the Centerline of Volutsia and 40' North of the 9th Street Baseline.
Elev. = 1320.68 (NAVD 88)

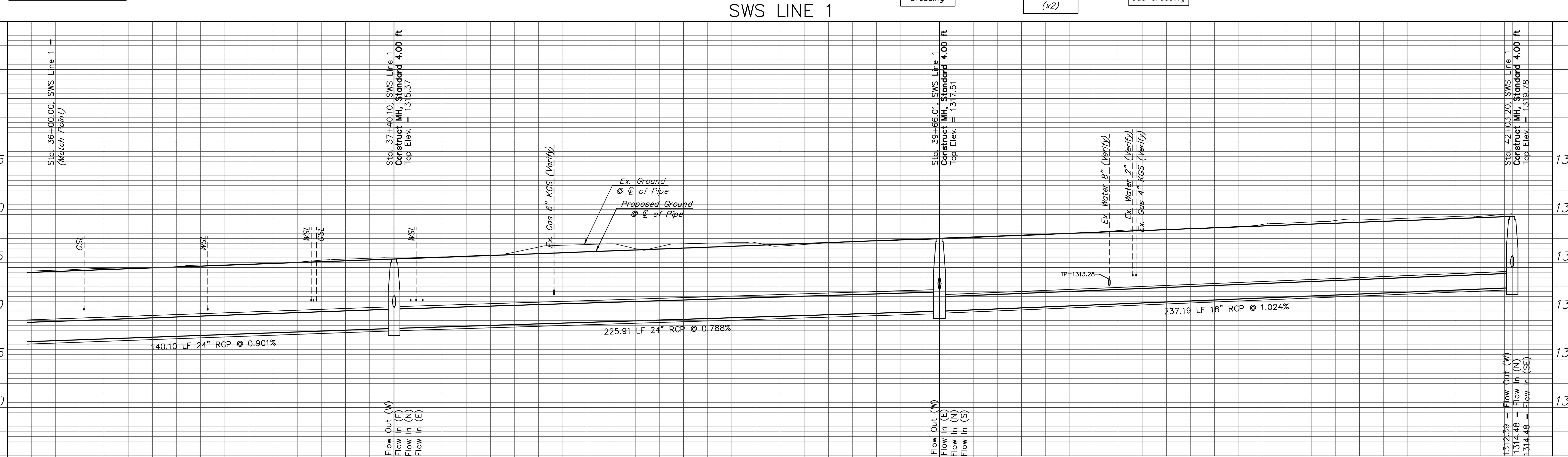
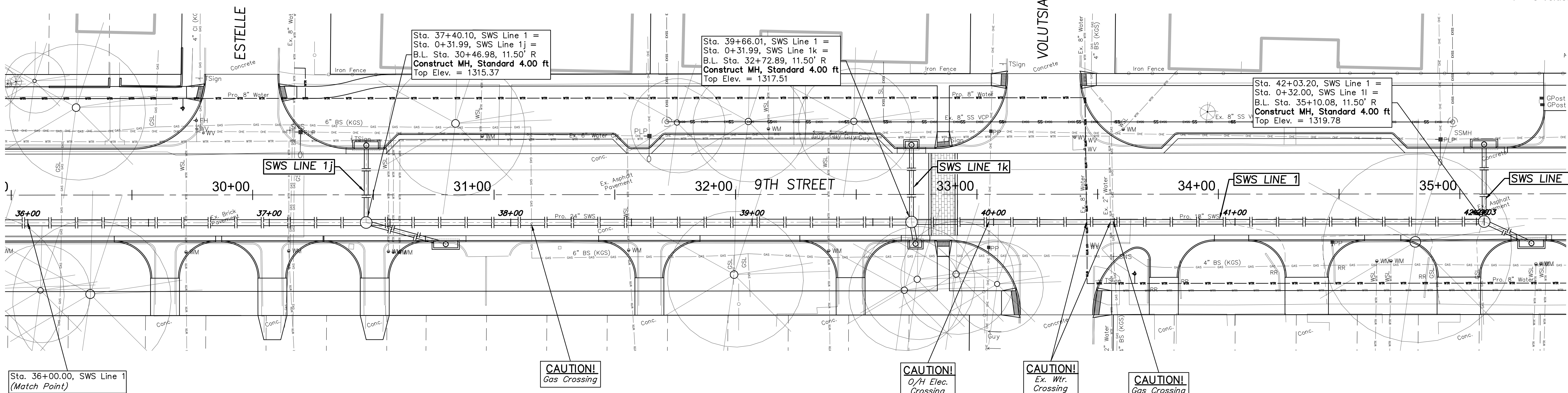
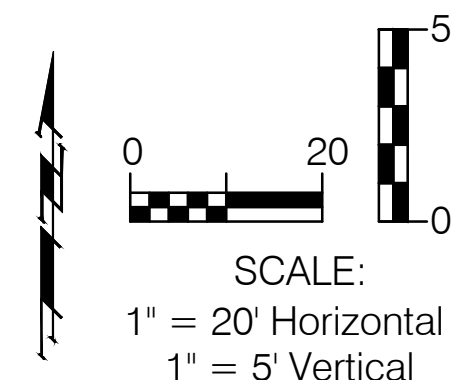

36+00.00	37+00.00	37+40.10	38+00.00	39+00.00	39+66.01	40+00.00	41+00.00	42+03.20
Sta. 36+00.00, SWS Line 1 (Match Point)		Sta. 37+40.10, SWS Line 1 Construct MH, Standard 4.00 ft Top Elev. = 1315.37			Sta. 39+66.01, SWS Line 1 Construct MH, Standard 4.00 ft Top Elev. = 1317.51			Sta. 42+03.20, SWS Line 1 Construct MH, Standard 4.00 ft Top Elev. = 1319.78
		1308.18 = Flow Out (W) 1308.18 = Flow In (E) 1310.34 = Flow In (N) 1310.34 = Flow In (E)			1309.96 = Flow Out (W) 1309.96 = Flow In (E) 1312.21 = Flow In (N) 1312.21 = Flow In (S)			1312.39 = Flow Out (W) 1314.48 = Flow In (N) 1314.48 = Flow In (SE)

September, 2017

Design File: E:\Projects\9th Street Corridor_16-02-E407\Civil 3D\Basemap
Project No. 16-02-E407 CAPITAL IMPROVEMENT PROJECT

9TH STREET DRAINAGE
SWS LINE 1
9TH STREET @ 135 to HILLSIDE

Scale: NOTED

Baughman Company, P.A.
315 Ellis St. Wichita, KS 67211 P 316-262-7271 F 316-262-0149
ENGINEERING | SURVEYING | PLANNING | LANDSCAPE ARCHITECTURE

SHEET 76 OF 110