

BENCHMARK:

BM #5 - Top of a the NE-most Bolt in the Base of the Sign Located on the Southeast Corner of the 9th & Grove Intersection, 40' East of the Centerline of Spruce and 46' South of the 9th Street Baseline.
Elev. = 1310.67 (NAVD 88)

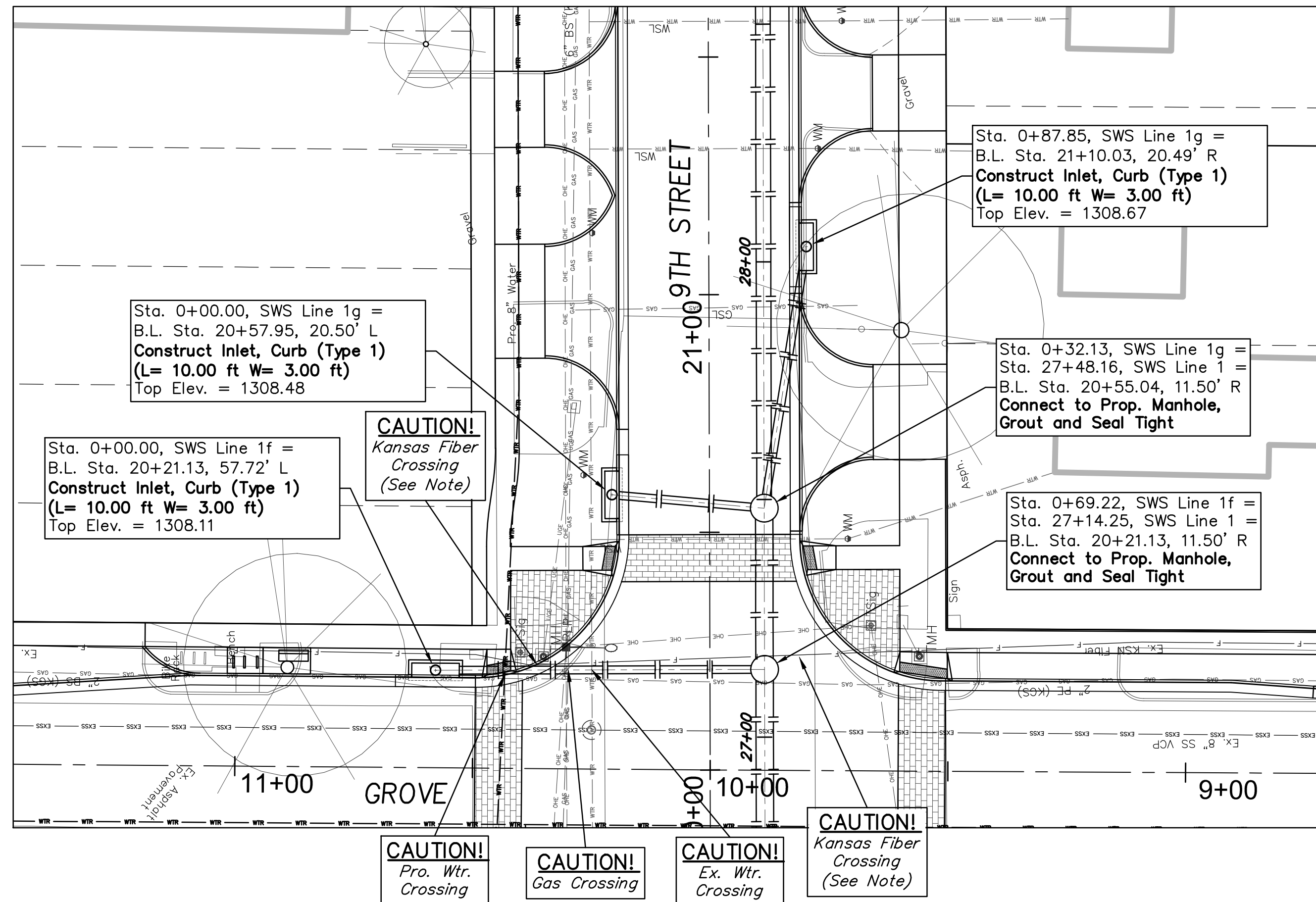
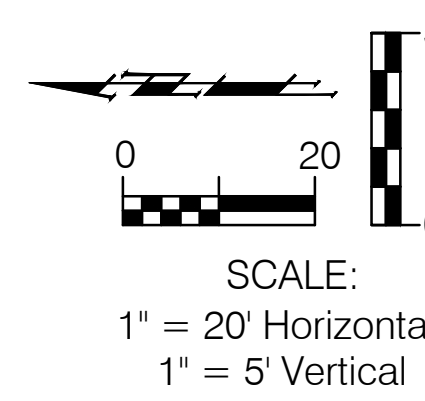

NOTE: Contractor to Contact Kansas Fiber Network upon Trenching prior to Installing SWS Structures & Pipe for SWS Line 1f. (See Contact Info on Notes Page)

SWS LINE 1f

SWS LINE 1g

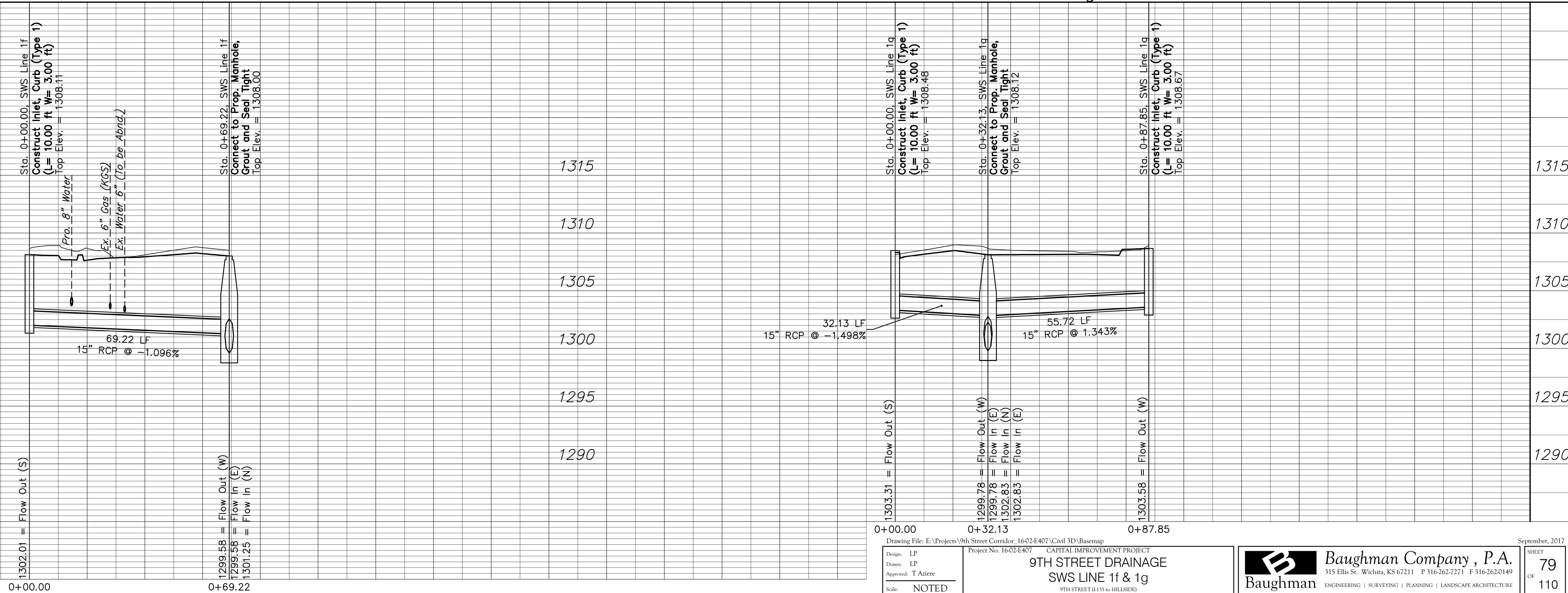

1303.31 = Flow Out (S)
1299.78 = Flow Out (W)
1299.78 = Flow In (E)
1302.83 = Flow In (N)
1302.83 = Flow In (E)
1303.58 = Flow Out (W)

0+00.00
0+32.13
0+87.85

Drawing File: E:\Projects\9th Street Corridor 16-02-E407\Civil 3D\Basemap
Project No. 16-02-E407
CAPITAL IMPROVEMENT PROJECT
9TH STREET DRAINAGE
SWS LINE 1f & 1g
9TH STREET @ 135 to HILLSIDE

Design: LP
Drawn: LP
Approved: T Aliche
Scale: NOTED