

MKEC

Wichita, KS • 316.684.9600

INDOOR FACILITY AND STADIUM IMPROVEMENTS
STRYKER SPORTS
WICHITA, KANSAS

EXISTING PARKING

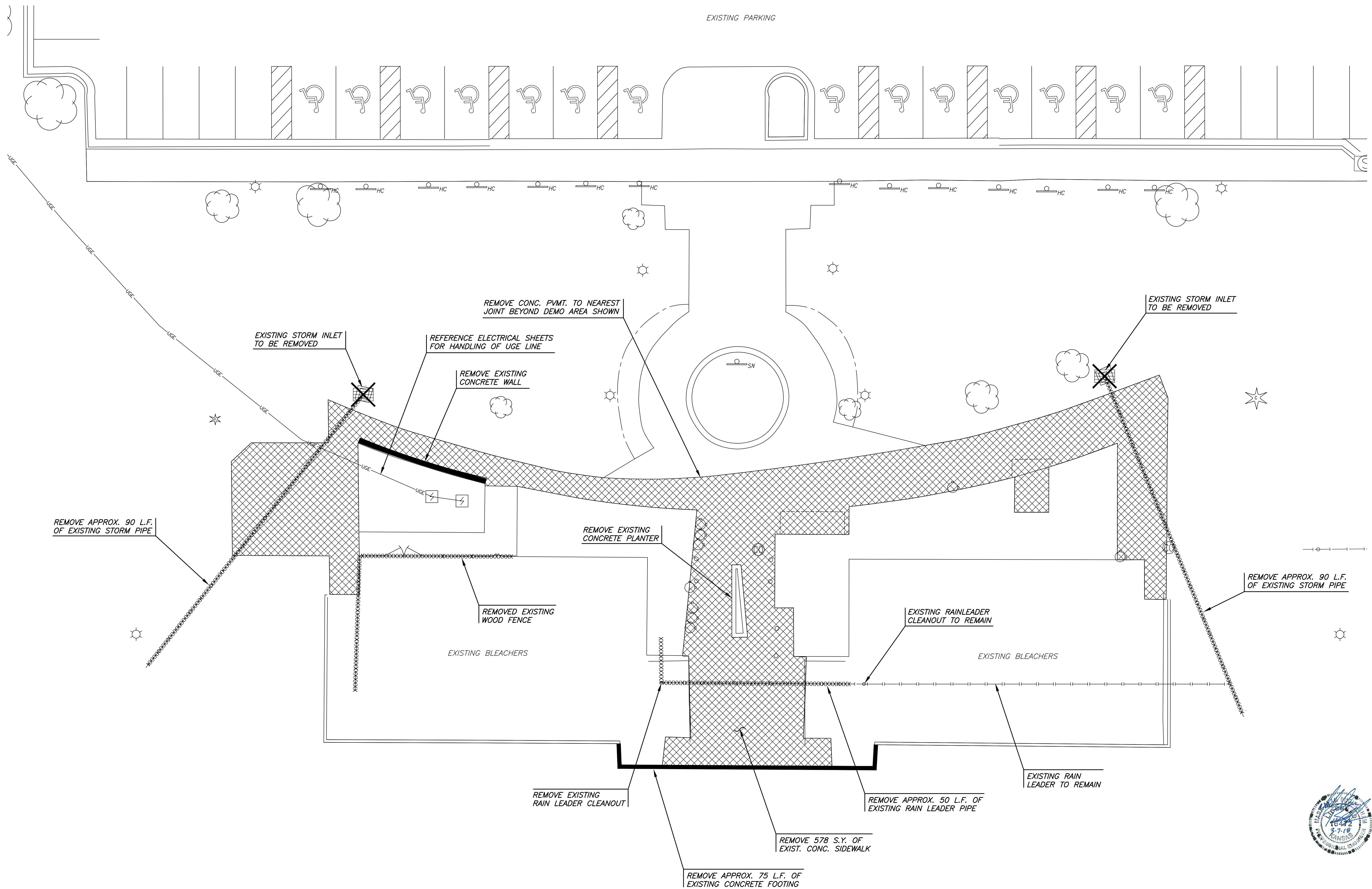

REMOVE APPROX. 90 L.F. OF EXISTING STORM PIPE

EXISTING STORM INLET TO BE REMOVED

REMOVE CONC. PVMT. TO NEAREST JOINT BEYOND DEMO AREA SHOWN

REFERENCE ELECTRICAL SHEETS FOR HANDLING OF UGE LINE

REMOVE EXISTING CONCRETE WALL

EXISTING STORM INLET TO BE REMOVED

REMOVE EXISTING CONCRETE PLANTER

REMOVED EXISTING WOOD FENCE

EXISTING BLEACHERS

EXISTING RAINLEADER CLEANOUT TO REMAIN

EXISTING BLEACHERS

REMOVE APPROX. 90 L.F. OF EXISTING STORM PIPE

REMOVE EXISTING RAIN LEADER CLEANOUT

REMOVE APPROX. 50 L.F. OF EXISTING RAIN LEADER PIPE

EXISTING RAIN LEADER TO REMAIN

REMOVE 578 S.Y. OF EXIST. CONC. SIDEWALK

REMOVE APPROX. 75 L.F. OF EXISTING CONCRETE FOOTING



LEGEND

- V— WATERLINE
- |— SANITARY SEWER
- |—|— STORMWATER SEWER
- UGE— UNDERGROUND ELECTRICAL
- G— GAS LINE
- — — EXISTING WALL TO BE REMOVED
- XXXXXXXXXXXXXXXXXXXXX PIPE AND FENCE TO BE REMOVED
- ⊗ SWS INLETS TO BE REMOVED
- ▣ EXISTING PAVEMENT TO BE REMOVED

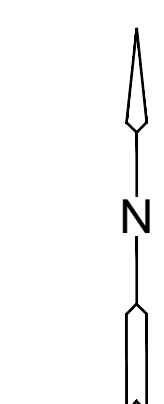

SCALE: 1"=10'
0 10 20

©2018 MKEC Engineering
All Rights Reserved
www.mkec.com
These drawings and their contents, including, but not limited to, all concepts, designs, & data are the exclusive property of MKEC Engineering (MKEC), and may not be used or reproduced in any way without the express consent of MKEC.

DEMOLITION PLAN

PROJECT NO.	1701010567	
DATE	03-07-18	
SCALE	1" = 10'	
DESIGNED	DRAWN	CHECKED
CRM	JWC	MAB

ISSUED FOR CONST.	03-07-18	
NO.	REVISION	DATE

SHEET NO.
SC4.0

I:\PROJECTS\2017\1701010567\CONV\STRYKER_17067_CADD\STRYKER_CIVIL\SC4\17067-SC400.DWG