

POND DATA
 Pond Bottom Elev. = 1322.00
 Static Pool Elev. = 1328.00
 100yr Water Surface = 1335.14
 Qin (100yr) = 40 c.f.s.
 Qout (100yr) = 23 c.f.s.

INSTALL 8.3 S.Y. HEAVY STONE
 RIP-RAP AS INDICATED.

TRIM & REMOVE TREES ONLY AS
 NECESSARY FOR CONSTRUCTION.
 SUBSIDIARY TO "SITE CLEARING
 AND RESTORATION".

REGRADE CHANNEL BETWEEN PONDS.
 (See Detail, this sheet)

INSTALL 50 S.Y. HEAVY STONE
 RIP-RAP OUTLET AS INDICATED.
 (See Detail this Sheet)

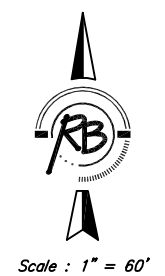

Southwest Passage Addition

Future Southwest
 Passage Addition

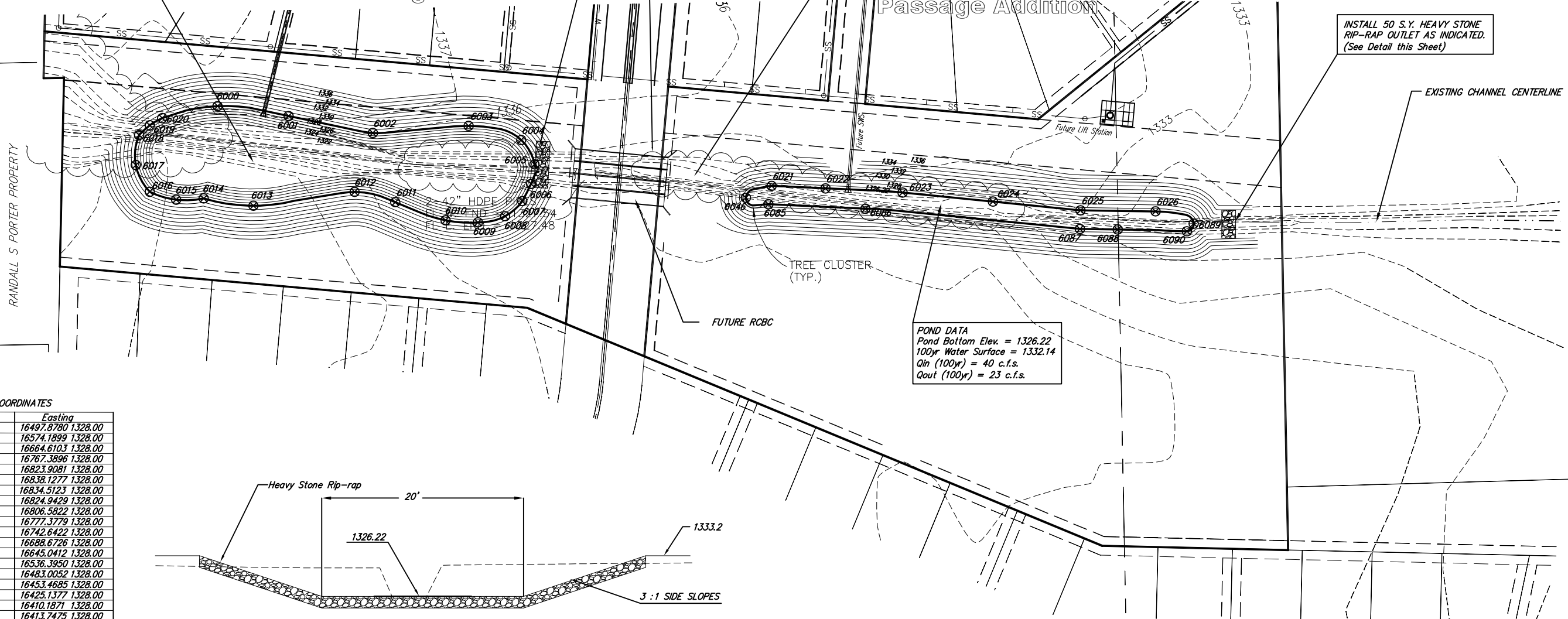

POND DATA
 Pond Bottom Elev. = 1326.22
 100yr Water Surface = 1332.14
 Qin (100yr) = 40 c.f.s.
 Qout (100yr) = 23 c.f.s.

POND COORDINATES

Number	Northing	Easting
6000	18966.6802	16497.8780 1328.00
6001	18955.9963	16574.1899 1328.00
6002	18937.8229	16664.6103 1328.00
6003	18945.4065	16767.3896 1328.00
6004	18930.2704	16823.9081 1328.00
6005	18904.1355	16838.1277 1328.00
6006	18883.1016	16834.5123 1328.00
6007	18864.6764	16824.9429 1328.00
6008	18848.4046	16806.5822 1328.00
6009	18841.7897	16777.3779 1328.00
6010	18844.0671	16742.6422 1328.00
6011	18863.5305	16688.6726 1328.00
6012	18874.5615	16645.0412 1328.00
6013	18859.6783	16536.3950 1328.00
6014	18867.5856	16483.0052 1328.00
6015	18866.2219	16453.4685 1328.00
6016	18874.6860	16425.1377 1328.00
6017	18903.4055	16410.1871 1328.00
6018	18935.5872	16413.7475 1328.00
6019	18946.0572	16425.1429 1328.00
6020	18953.7616	16438.5639 1328.00
6021	18881.0112	17092.6771 1326.22
6022	18878.3328	17150.4703 1326.22
6023	18873.8355	17233.2277 1326.22
6024	18864.1163	17330.2307 1326.22
6025	18854.7282	17424.2266 1326.22
6026	18853.6291	17504.7672 1326.22
6046	18868.2407	17064.9971 1326.22
6085	18861.3087	17089.2407 1326.22
6086	18856.4856	17193.3077 1326.22
6087	18834.7344	17423.6235 1326.22

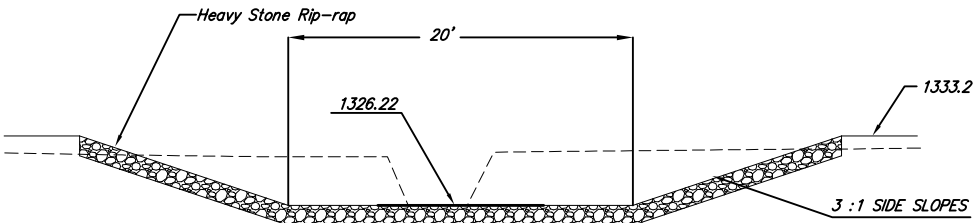

RIp-RAP OUTLET DETAILS

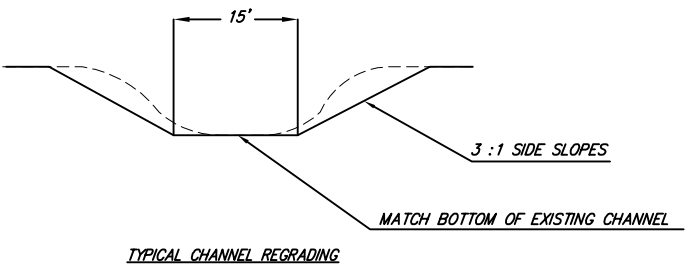

TYPICAL CHANNEL REGRAIDING

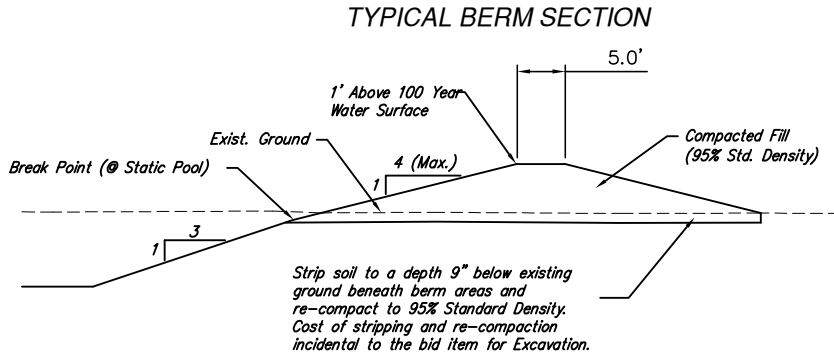

TYPICAL BERM SECTION

NOTE: THE POND SIDES ARE TO BE SCARIFIED A MINIMUM OF 8 INCHES, MOISTURE CONDITIONED AND RECOMPACTED TO A MINIMUM OF 95 PERCENT OF STANDARD PROCTOR DENSITY (ASTM D-698) FROM MINUS 3 TO PLUS 3 PERCENT OF OPTIMUM MOISTURE CONTENT. ADDITIONALLY, ALL GYPSUM/CALICHE SEAMS, SANDY CLAY AND CLAY SHALE ENCOUNTERED SHOULD BE OVER-EXCAVATED A MINIMUM OF 1 FOOT AND REPLACED WITH CLAY. MINIMUM PI OF THE SOIL USED FOR THE POND LINER IS 30.

AS PER STIPULATION OF THE NWP 39 GRANTED BY THE U.S. ARMY CORP OF ENGINEERS FOR THIS PROJECT, "ANY DEBRIS OR TRASH REMOVAL IN THE CHANNEL MUST BE COMPLETED WITH A RUBBER TIRE EXCAVATOR."

**SOUTHWEST PASSAGE ADDITION
 POND DETAILS
 WICHITA, KANSAS**

Ruggles & Bohm, P.A.
 Engineering, Surveying, Land Planning

824 North Main
 Wichita, Kansas 67203
 www.rbkansas.com

(316) 264-8008
 (316) 264-4621 fax
 E-mail: info@rbkansas.com

DESIGN: KWL
 DRAWN: JDM
 REVIEW: [blank]
 UTILITY: [blank]

PROJECT NUMBER: 468-84230

DATE: Nov. 09, 2008

SHEET
 2
 OF
 14