

P.O.T.  
 1. P.K. NAIL ON WEST LINE S.W. 1/4 4-27S.-2E.  
 2. C PROP IMPROVEMENTS STA. 66+53.93  
 3. CHISELED "+" ON FACE OF CONCRETE WALL 66.8 E.  
 4. 40 P NAIL & DISC IN P.P. 100.55 S.W.  
 5. 40 P NAIL & DISC IN P.P. 161.05 N.N.W.

FHWA REGION NO.	STATE	PROJECT NO.	YEAR	SHEET NO.	TOTAL SHEETS
7	KS.	87-U-1362-01	1993	13	149

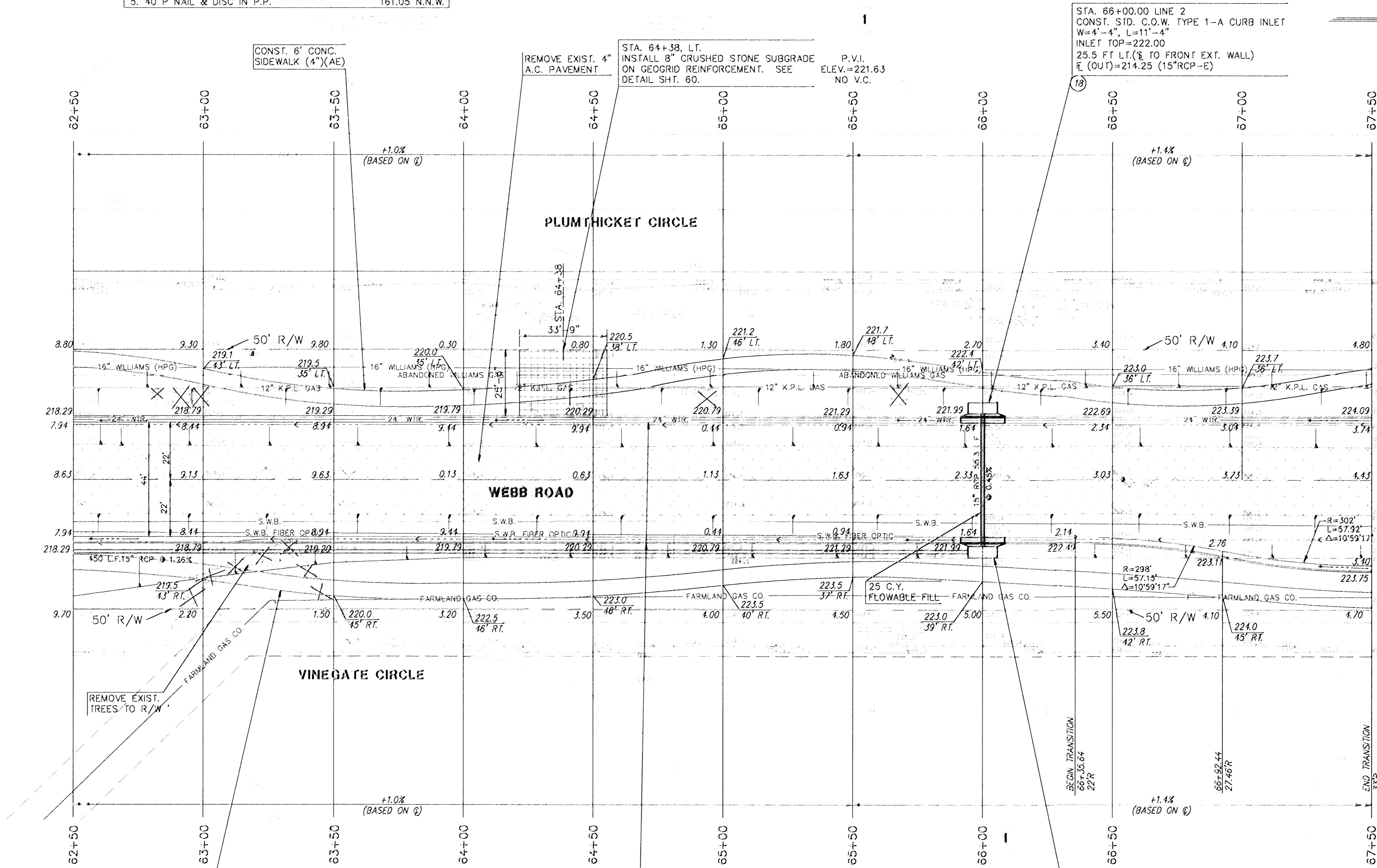

STA. 66+00.00 LINE 2  
 CONST. STD. C.O.W. TYPE 1-A CURB INLET  
 W=4'-4", L=11'-4"  
 INLET TOP=222.00  
 25.5 FT LT. (3 TO FRONT EXT. WALL)  
 E (OUT)=214.25 (15"RCP-E)

SCALE: 1"=20'

Q = S

REMOVE EXIST. TREES TO R/W

CONST. 6' CONC. SIDEWALK (4")(AE)

CONST. CURB & GUTTER KDOT TYPE 1  
 STA. 62+50 TO STA. 67+50

P.V.I. ELEV.=221.63  
 NO V.C.

STA. 66+00.00 LINE 2  
 CONST. STD. C.O.W. TYPE 1-A CURB INLET  
 W=4'-4", L=11'-4"  
 INLET TOP=222.00  
 25.5 FT RT. (3 TO FRONT EXT. WALL)  
 E (IN)=214.00(15"RCP-W)  
 E (OUT)=213.90(15"RCP-S)

LEGEND  
 [Symbol] PAVEMENT, DRIVEWAY AND/OR SIDEWALK REMOVAL

KANSAS DEPARTMENT OF TRANSPORTATION

**WEBB ROAD**  
**62+50 TO 67+50**

PROJECT NO. 87-U-1362-01 SEDGWICK CO.  
**MID-KANSAS ENGINEERING CONSULTANTS, INC.**  
 WICHITA, KANSAS

FARMLAND INDUSTRIES, INC. 1-(918)-333-4111  
 KANSAS GAS & ELECTRIC (K.G.&E.) 264-1141  
 KPL GAS SERVICE CO. 263-7511  
 CITY OF WICHITA WATER DEPARTMENT 263-4303  
 SOUTHWESTERN BELL TELEPHONE CO. 1-571-2811  
 WILLIAMS PIPELINE 524-4390

BM #4 RAILROAD SPIKE IN EAST FACE OF POWER POLE  
 46' LT., STA. 65+65.00 ELEV.=223.863

DESIGNED BY: GJA CHECKED BY: DLH & KJS  
 DRAWN BY: DLM DATE: SHEET 13 OF 149