

FHWA REGION NO.	STATE	PROJECT NO.	YEAR	SHEET NO.	TOTAL SHEETS
7	KS.	87-U-1362-01	1993	11	149

SCALE: 1"=20'

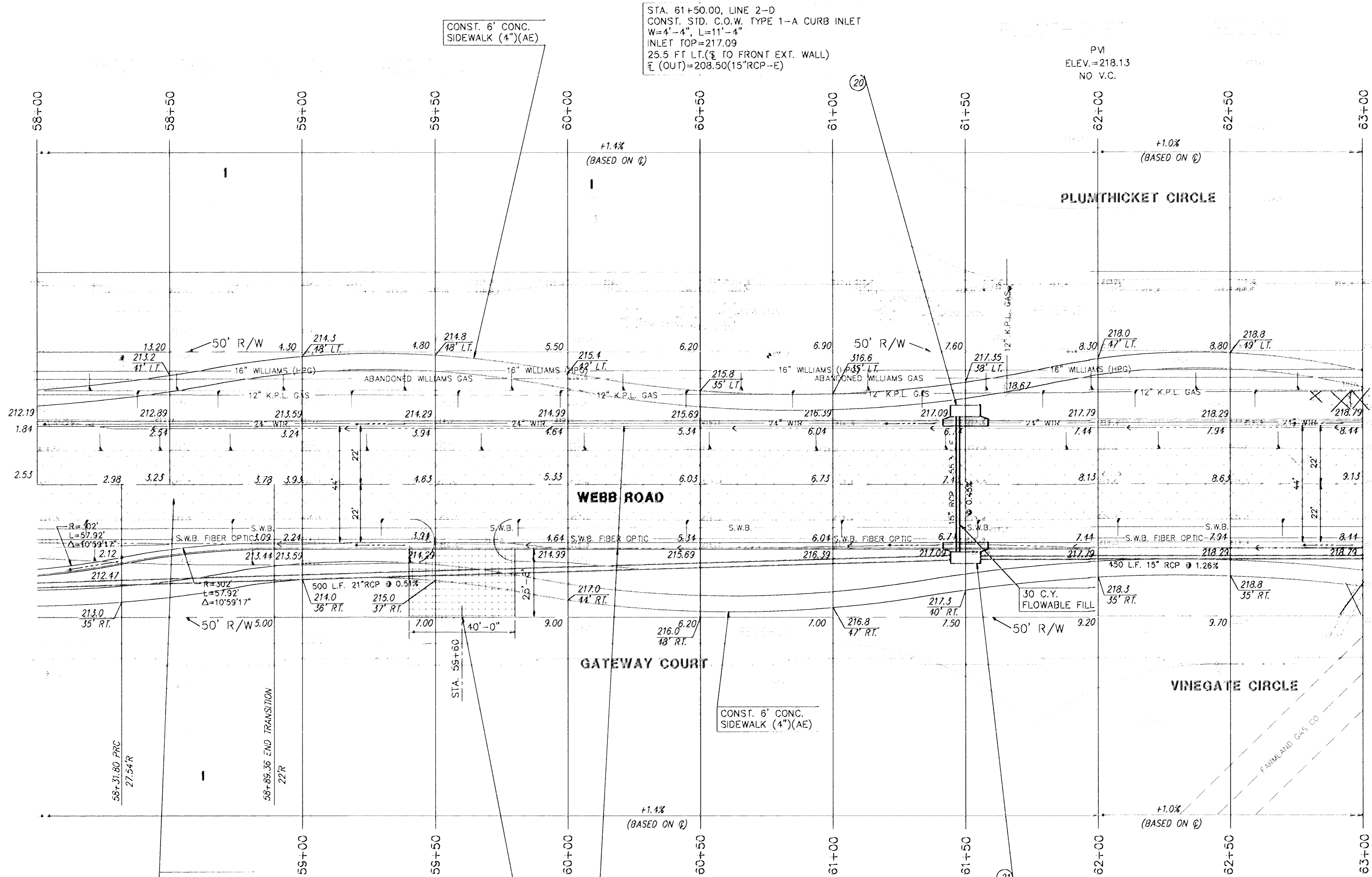

STA. 61+50.00, LINE 2-D
 CONST. STD. C.O.W. TYPE 1-A CURB INLET
 W=4'-4", L=11'-4"
 INLET TOP=217.09
 25.5 FT LT. (S TO FRONT EXT. WALL)
 FL (OUT)=208.50(15"RCP-E)

PM
 ELEV.=218.13
 NO V.C.

WEBB ROAD

GATEWAY COURT

PLUMTHICKET CIRCLE

VINEGATE CIRCLE

REMOVE EXIST. 4"
 A.C. PAVEMENT

STA. 59+60, RT.
 INSTALL 8" CRUSHED STONE SUBGRADE
 ON GEOGRID REINFORCEMENT. SEE
 DETAIL SH. 60.

CONST. 6" CONC.
 SIDEWALK (4")(AE)

STA. 61+50.00, LINE 2 & LINE 2-D
 CONST. STD. C.O.W. TYPE 1-A CURB INLET
 W=4'-4", L=11'-4"
 INLET TOP=217.10
 25.5 FT RT. (S TO FRONT EXT. WALL)
 FL (IN)=208.25(15"RCP-W)
 FL (IN)=208.25(15"RCP-N)
 FL (OUT)=207.75(21"RCP-S)

PM
 ELEV.=218.13
 NO V.C.

LEGEND
 PAVEMENT, DRIVEWAY AND/OR
 SIDEWALK REMOVAL.

FARMLAND INDUSTRIES, INC. 1-(913)-333-4111
 KANSAS GAS & ELECTRIC (K.G.&E.) 264-1141
 KPL GAS SERVICE CO. 263-7511
 CITY OF WICHITA WATER DEPARTMENT 268-4908
 SOUTHWESTERN BELL TELEPHONE CO. 1-571-2611
 WILLIAMS PIPELINE 524-4390

BM #3 RAILROAD SPIKE IN EAST FACE OF POWER POLE
 74' LT., STA. 60+67 ELEV.=219.623

CONST. COMB. CURB &
 GUTTER KDOT TYPE 1
 STA. 58+00 TO
 STA. 63+00

KANSAS DEPARTMENT OF TRANSPORTATION

WEBB ROAD
58+00 TO 63+00

PROJECT NO. 87-U-1362-01 SEDGWICK CO.

MID-KANSAS ENGINEERING CONSULTANTS, INC.
 WICHITA, KANSAS

DESIGNED BY: GJA	CHECKED BY: DLH & KJS
DRAWN BY: DLM	DATE: SHEET 11 OF 149