

Revised: See Bottom of Sheet.

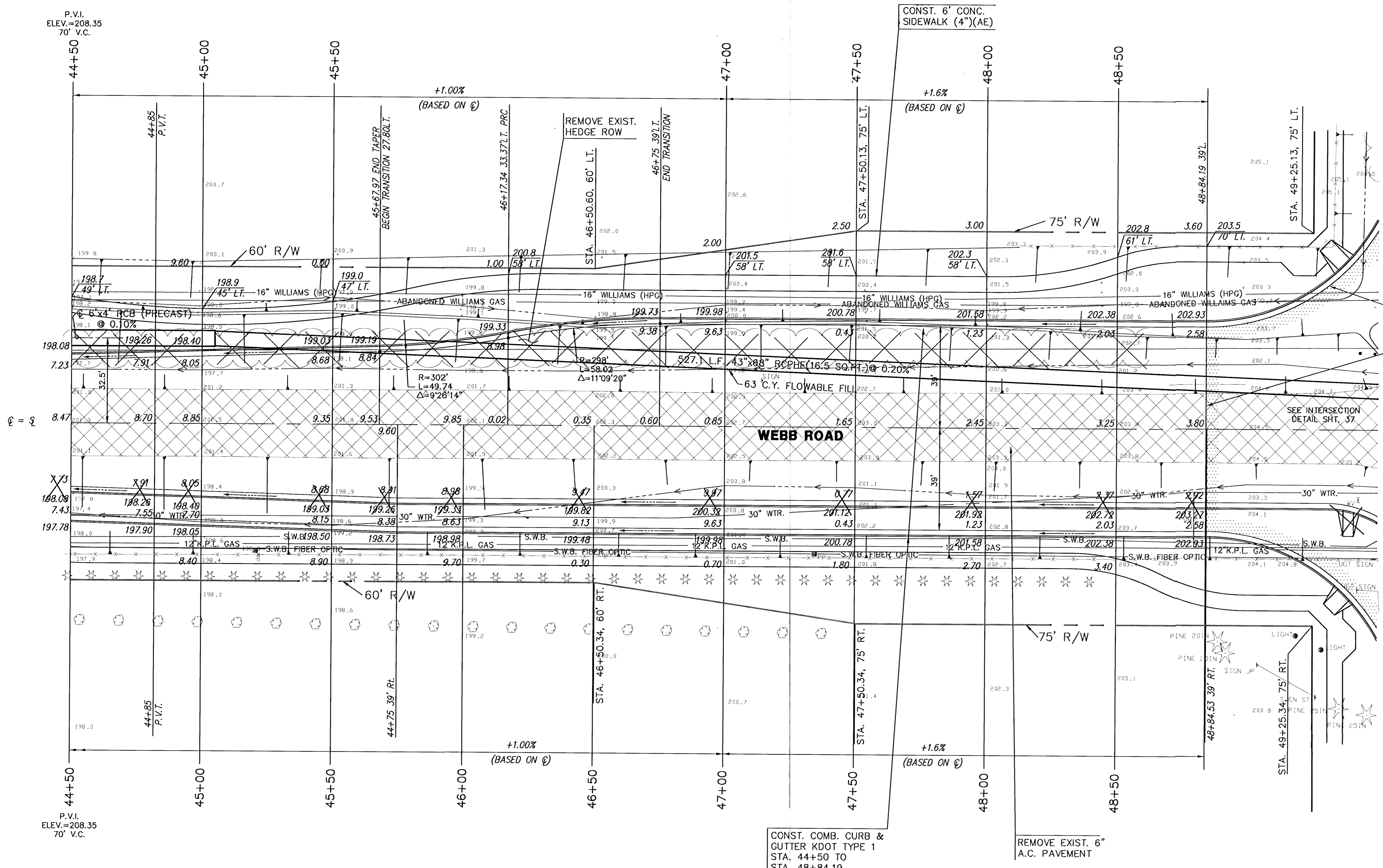
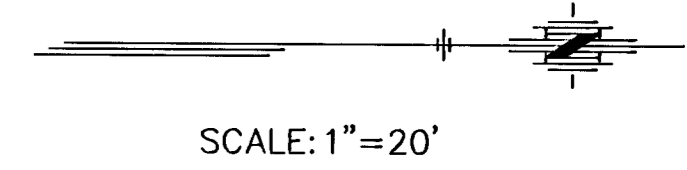

CONST. 10" REINF. CONC. PAVEMENT

CONST. COMB. CURB & GUTTER KDOT TYPE 1 STA. 44+50 TO STA. 48+84.19

REMOVE EXIST. 6" A.C. PAVEMENT

LEGEND
 PAVEMENT, DRIVEWAY AND/OR SIDEWALK REMOVAL.

STATION	OFFSET	EXISTING ELEV.	PROPOSED ELEV.	NOTES
48+79	37'R	203.30	203.30	W.M.

CITY OF WICHITA WATER DEPARTMENT 268-4908
 KANSAS GAS & ELECTRIC (K.G.&E.) 264-1141
 KPL GAS SERVICE CO. 263-7511
 RURAL WATER DISTRICT 832-0213
 SOUTHWESTERN BELL TELEPHONE CO. 1-571-2611
 WILLIAMS PIPELINE 524-4390

REVISED 11/01/93
 REVISED 8/13/93

KANSAS DEPARTMENT OF TRANSPORTATION

WEBB ROAD
44+50 TO 49+50

PROJECT NO. 87-U-1362-01 SEDGWICK CO.

MID-KANSAS ENGINEERING CONSULTANTS, INC.
 WICHITA, KANSAS

DESIGNED BY:	GJA	CHECKED BY:	DLH & KJS
DRAWN BY:	DLM	DATE:	SHEET 5 OF 149