

FHWA REGION NO.	STATE	PROJECT NO.	YEAR	SHEET NO.	TOTAL SHEETS
7	KS.	87-U-1362-01	1993	17	149

SCALE: 1"=20'

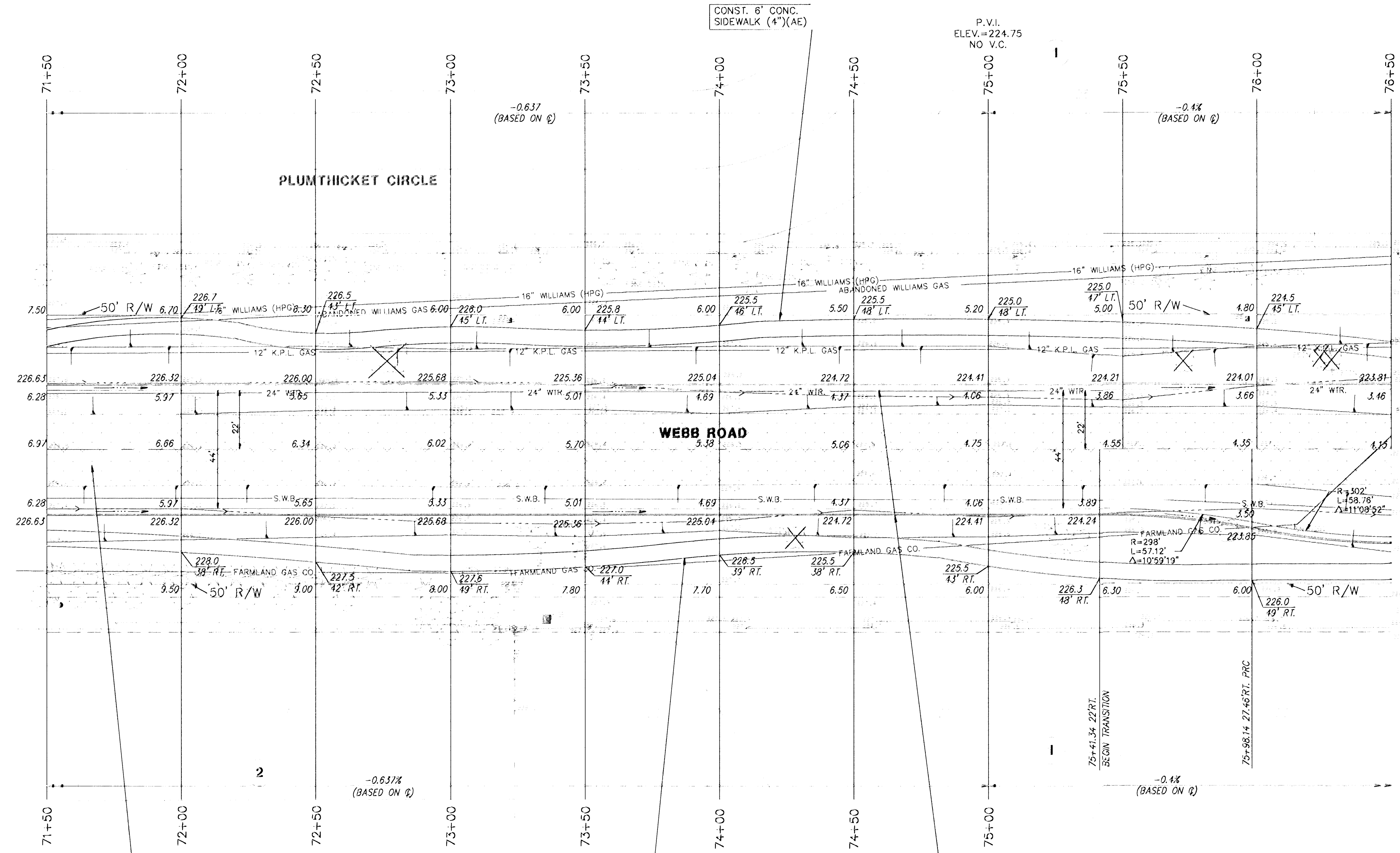

LEGEND  
 [Symbol] PAVEMENT, DRIVEWAY AND/OR SIDEWALK REMOVAL.

REMOVE EXIST. 4" A.C. PAVEMENT

CONST. 6" CONC. SIDEWALK (4") (AE)

P.V.I. ELEV.=224.75 NO V.C.  
 CONST. COMB. CURB & GUTTER KDOT TYPE 1 STA. 71+50 TO STA. 76+50

KANSAS DEPARTMENT OF TRANSPORTATION  
**WEBB ROAD**  
**71+50 TO 76+50**  
 PROJECT NO. 87-U-1362-01 SEDGWICK CO  
**MID-KANSAS ENGINEERING CONSULTANTS, INC.**  
 WICHITA, KANSAS

DESIGNED BY:	GJA	CHECKED BY:	DLH & KJS
DRAWN BY:	DLW	DATE:	SHEET 17 OF 149

FARMLAND INDUSTRIES, INC. 1(918)333-4111  
 KANSAS GAS & ELECTRIC (K.G.&E.) 264-1141  
 KPL GAS SERVICE CO. 263-7511  
 CITY OF WICHITA WATER DEPARTMENT 268-4908  
 SOUTHWESTERN BELL TELEPHONE CO. 1-571-2611  
 WILLIAMS PIPELINE 524-4390