

STATE	PROJECT NO.	YEAR	SHEET NO.	TOTAL SHEETS
KANSAS	87 N-0673-01	2017	71	99

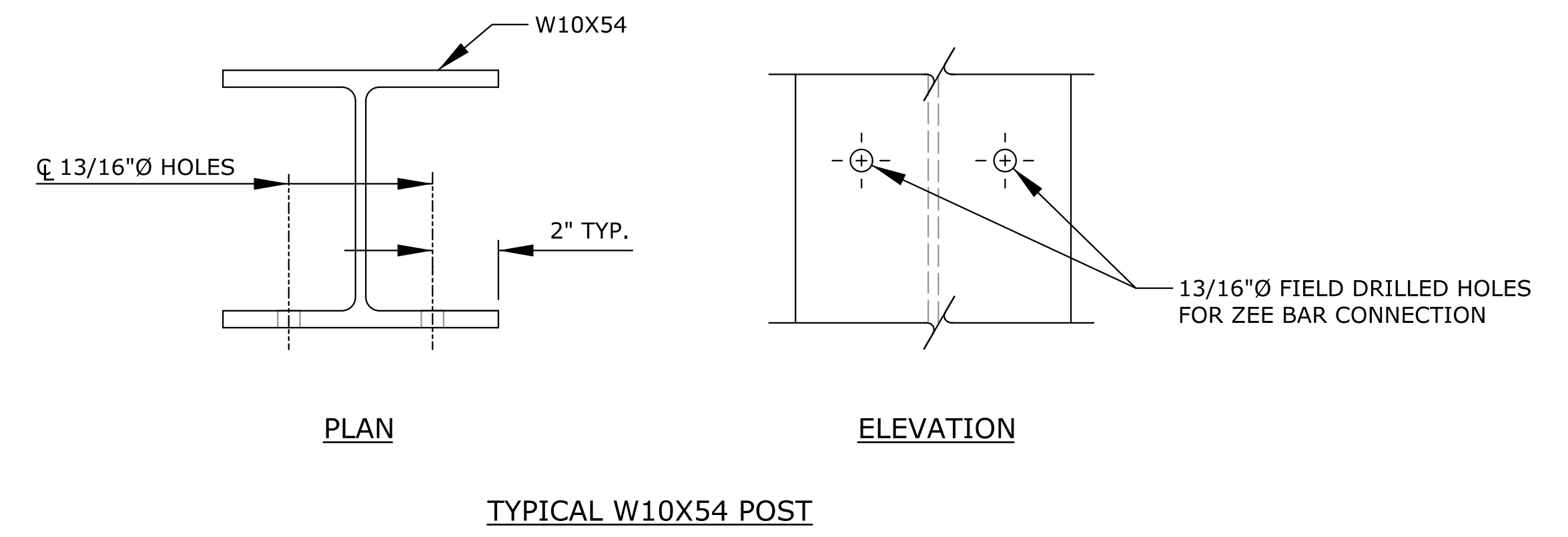
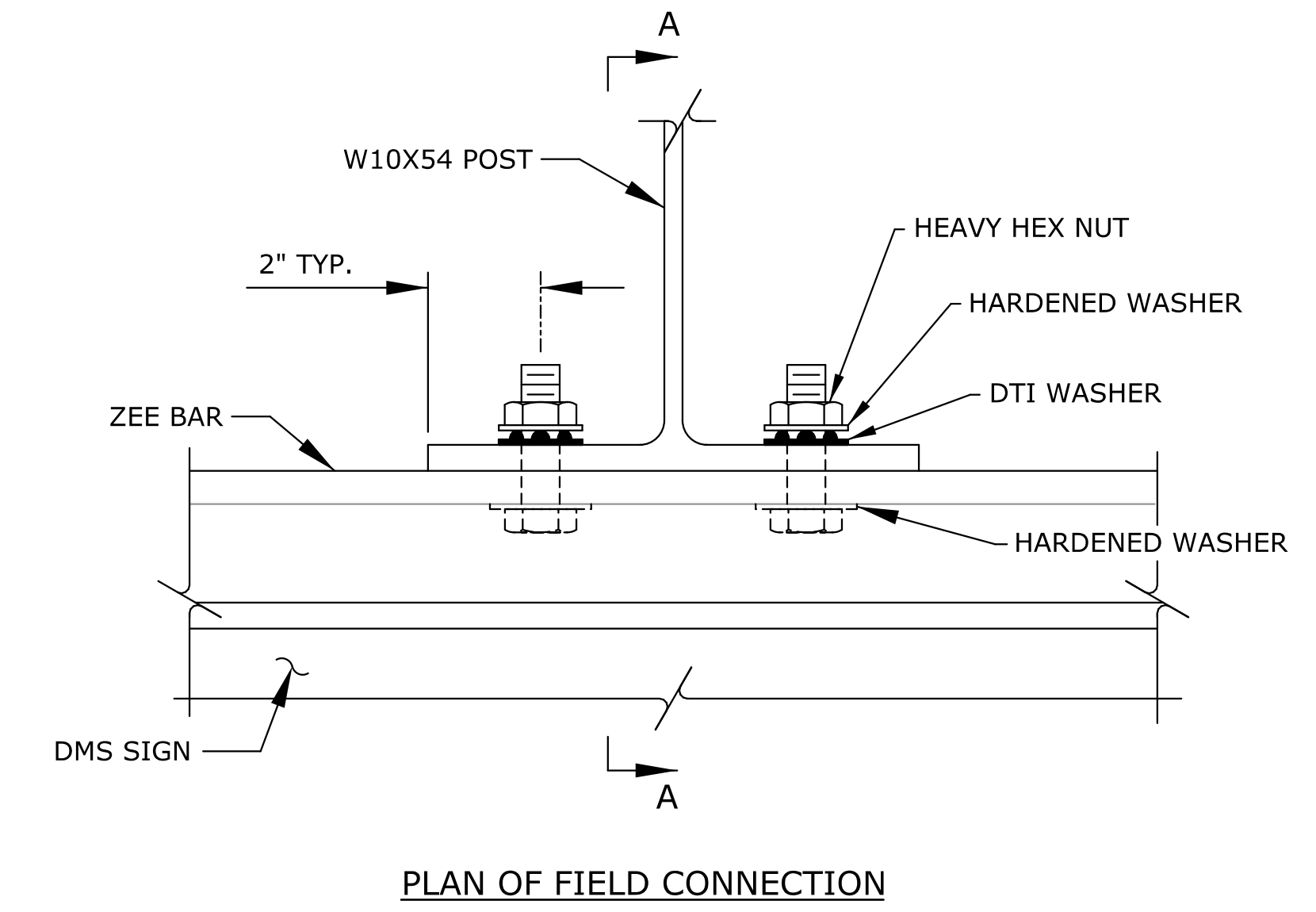
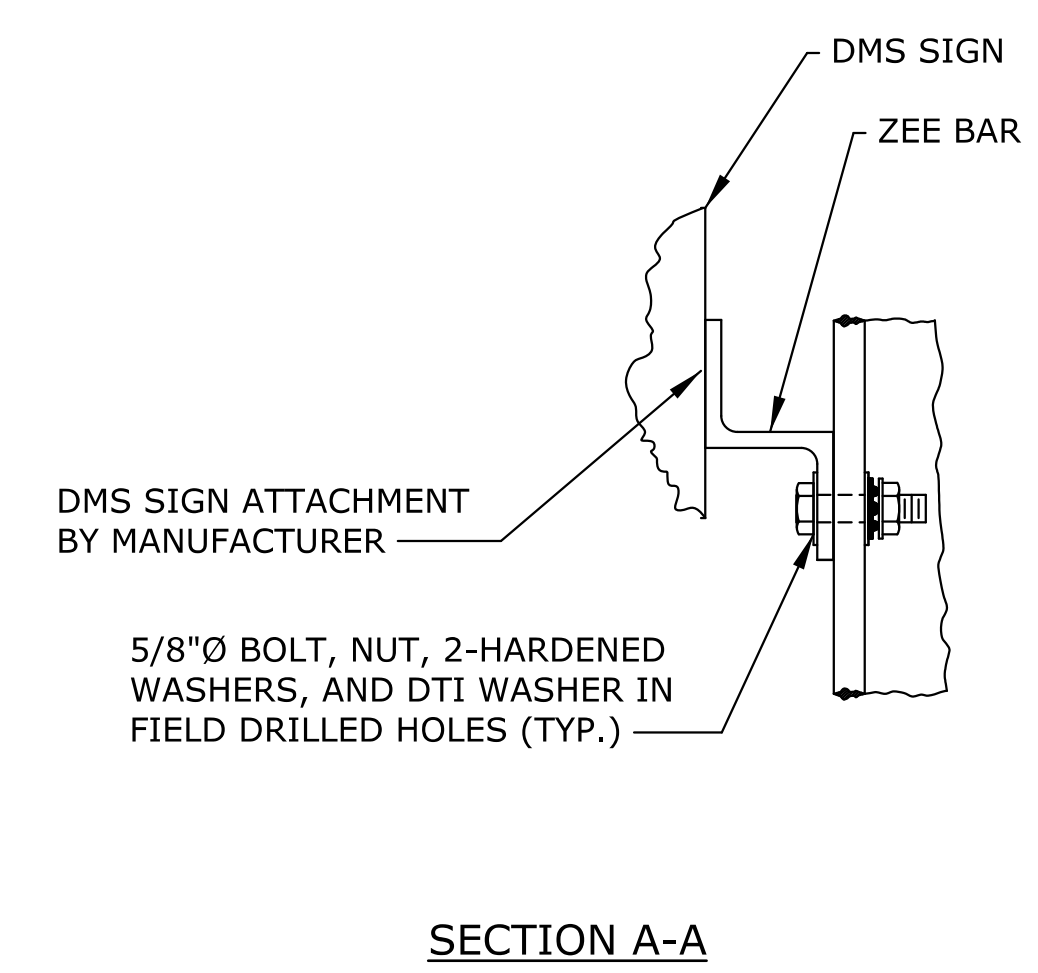
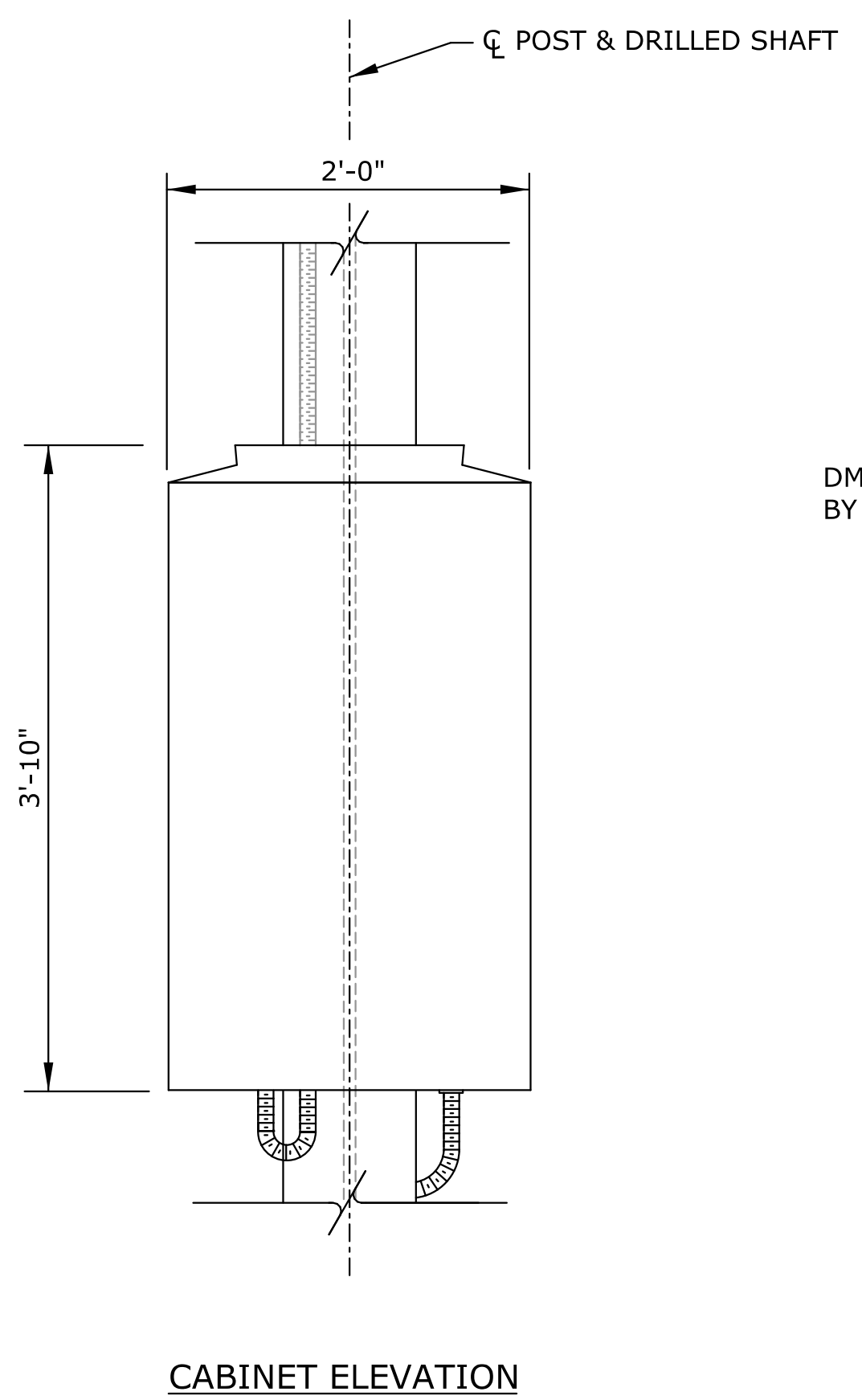
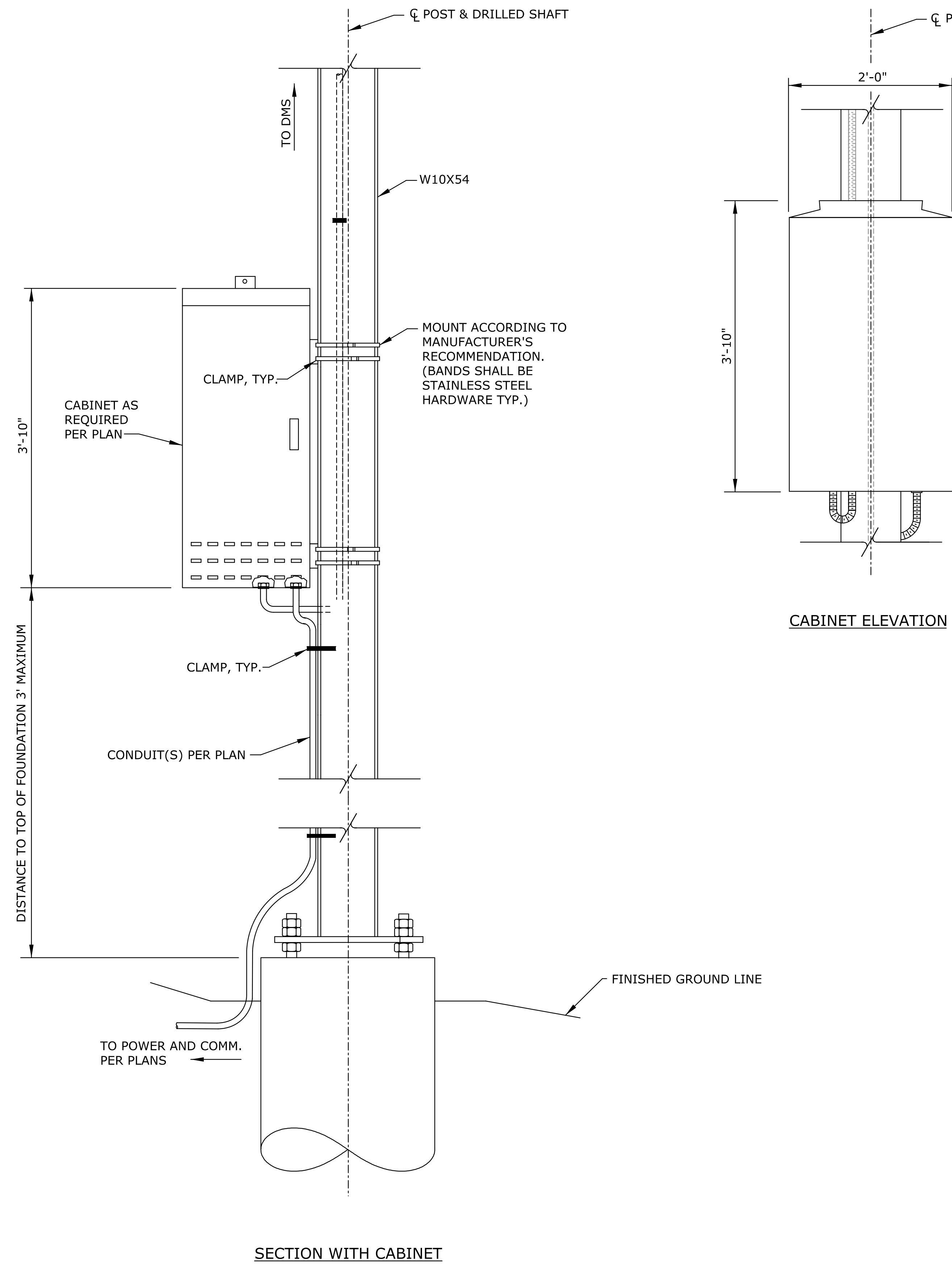

- CABINET INSTALLATION NOTES:**
1. INSTALL CABINET ON POST ONLY AS IDENTIFIED ON THE PLANS.
  2. ALL CONNECTIONS TO ENCLOSURE AND THE SIGN SHALL BE LIQUID-TIGHT CONNECTIONS.
  3. INSTALL LOCK WASHERS ON ALL CABINET CONDUIT FITTINGS.
  4. MAXIMUM WEIGHT OF CABINET = 400 LBS

KANSAS DEPARTMENT OF TRANSPORTATION

**GROUND-MOUNTED DMS  
STRUCTURE DETAILS  
SHEET 2 OF 2**

APP'D DESIGNED	SCALE DESIGN CK.	DATE DETAIL CK.
-------------------	---------------------	--------------------

KD0T Graphics Certified 09-14-2017

Drawn By : examples  
 File : C-DMS-ITS-502.dgn  
 Plotted : 14-NOV-2017 10:55

KD0T Graphics Certified