

INDEX OF SHEETS

SHEET NO.	1	TITLE SHEET
	2	GENERAL NOTES & TYPICAL SECTIONS
	3-6	PLAN & PROFILE SHEETS
	7	INTERSECTION DETAILS
	8	STORM SEWER PLAN & PROFILE
	9-12	WATER MAIN REPLACEMENT
	13-14	JOINTING DETAILS
	15	CURB & GUTTER & COMBINED CURB & GUTTER
	16	VALLEY GUTTER DETAILS
	16A	STANDARD DRIVE ENTRANCES FULL HEIGHT CURB
	17	SIDEWALK AND STEPS
	18	CONCRETE END SECTIONS
	19	REINFORCED CONCRETE MANHOLE
	20	PRECAST MANHOLES
	21	TYPE 22 CURB INLET
	22	TYPE 22 PRECAST INLET
	22A	DROP INLET DETAILS
	23	REINFORCING STEEL FOR INLETS & MANHOLES
	24	SCHEDULE OF INLETS & MANHOLES
	25	SUMMARY OF QUANTITIES
	26-30	TEMPORARY PROJECT WATER POLLUTION CONTROL
	31	SUMMARY OF SEEDING QUANTITIES
	32-34	TRAFFIC SIGNAL INSTALLATION
	35	TRAFFIC SIGNAL QUANTITIES
	36-39	TRAFFIC SIGNAL DETAILS
	40-45	TRAFFIC SIGNAL SPECIFICATIONS
	46-47	PAVEMENT MARKING PLAN
	48	TYPICAL MISC. PAVEMENT MARKING DETAIL SHEET
	49	SUMMARY & RECAPITULATION OF PAVEMENT MARKING QUANTITIES
	50	SUMMARY OF QUANTITIES (SURFACING)
	51	TEMPORARY TRAFFIC SIGNAL PLAN
	52	TRAFFIC CONTROL GENERAL NOTES
	53-56	CONSTRUCTION SEQUENCING
	57	SUMMARY OF DEVICES & RECAPITULATION OF QUANTITIES
	58-59	TRAFFIC CONTROL
	60-75	CROSS SECTIONS

STATE OF KANSAS
DEPARTMENT OF TRANSPORTATION

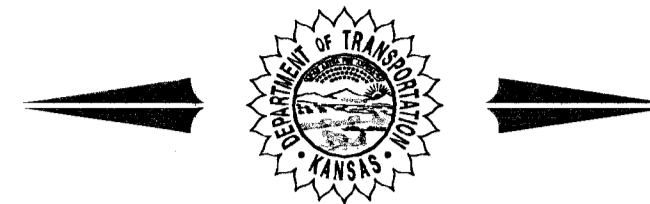

INTERSECTION IMPROVEMENT PLAN
AT
OLIVER STREET AND PAWNEE AVENUE

FEDERAL AID PROJECT

CITY OF WICHITA, KANSAS
SEDCWICK COUNTY

POPULATION 311,746

Project # 472-82910/448-89081

OCA # 706800/634725

FHWA REG. NO.	STATE	PROJECT NO.	YEAR	SHEET NO.	TOTAL SHEETS
7	KANSAS	87 N-0092-01	1999	1	75

PROJ. NO. 87 N-0092-01
STP 87 N-009(201)

- GRADING
- SURFACING
- SEEDING
- TRAFFIC SIGNALIZATION
- PAVEMENT MARKINGS

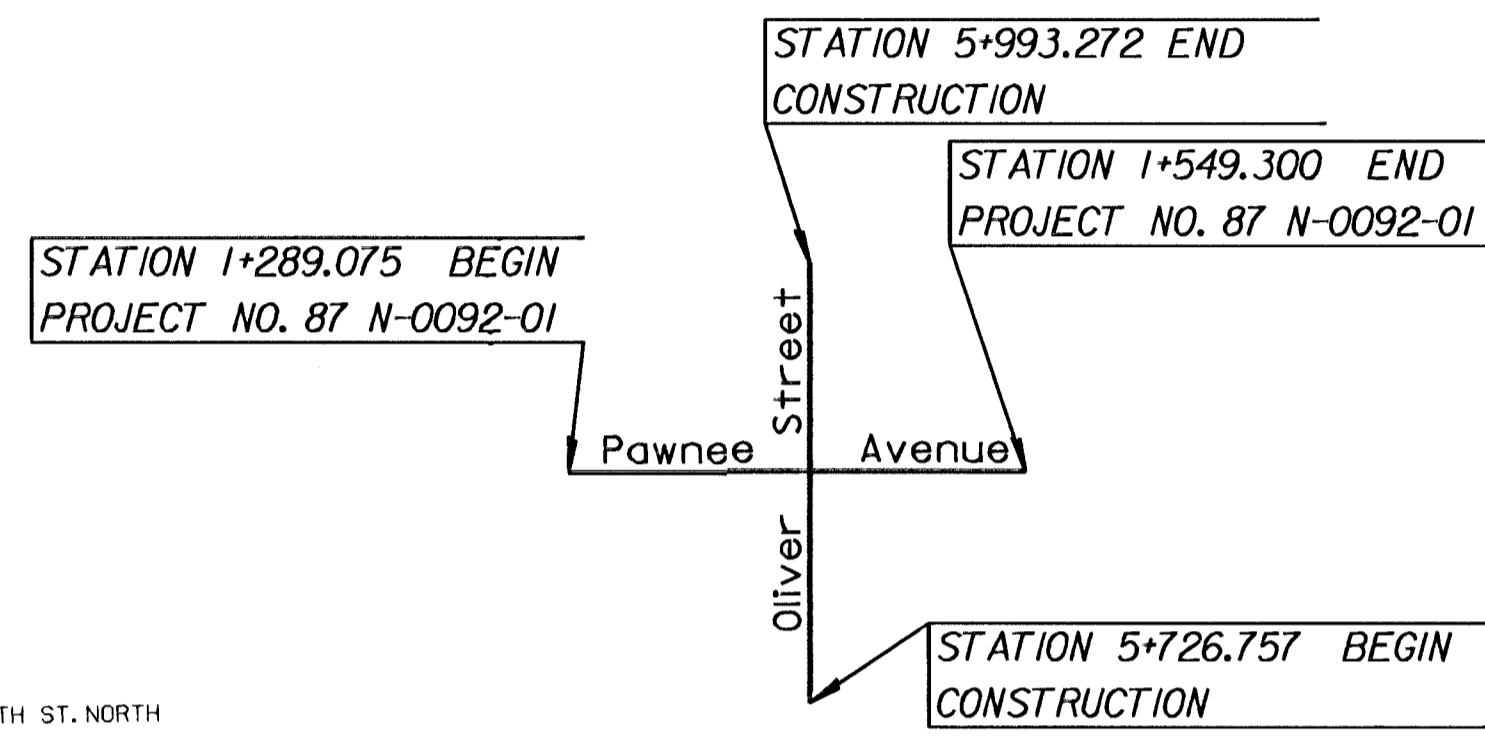

Section Corner Ties

N/4 Corner, Sec. 1, T28S, R1E
3/4" Pipe Found
1. Chiseled "x" in top of curb 9.342 m North
2. Chiseled "x" in top of curb 8.059 m South
3. Chiseled "x" in top of curb 10.586 m South-Southwest

Northeast Corner, Sec. 2, T28S, R1E
3/4" Pipe Found
1. South side Sign (Liquor) 25.183 m North-Northeast
2. Nail & washer North side of power pole 29.834 m North-Northwest
3. Nail & washer West side of power pole 26.515 m South-Southeast

E/4 Corner, Sec. 35, T28S, R1E
3/4" Pipe Found
1. Southwest corner traffic light base 14.554 m Northeast
2. Northwest corner traffic light base 15.423 m Southeast
3. Northeast corner traffic light base 17.130 m Southwest
4. Southeast corner traffic light base 16.032 m Northwest

E/4 Corner, Sec. 2, T28S, R1E
3/4" Pipe Found
1. PK nail w/ washer North side of power pole 13.320 m East
2. Gas line marker 18.379 m Northwest

3/4" I.D. PIPE FOUND
N/4 COR., SEC. 1, T28S, R1E

3/4" I.D. PIPE FOUND
E/4 COR., SEC. 2, T28S, R1E

Note: Traffic shall be carried thru construction.
Note: For Construction Sequence See Sh. No. 50-53

All dimensions shown, without an S suffix, are in millimeters. All elevations shown are in meters.

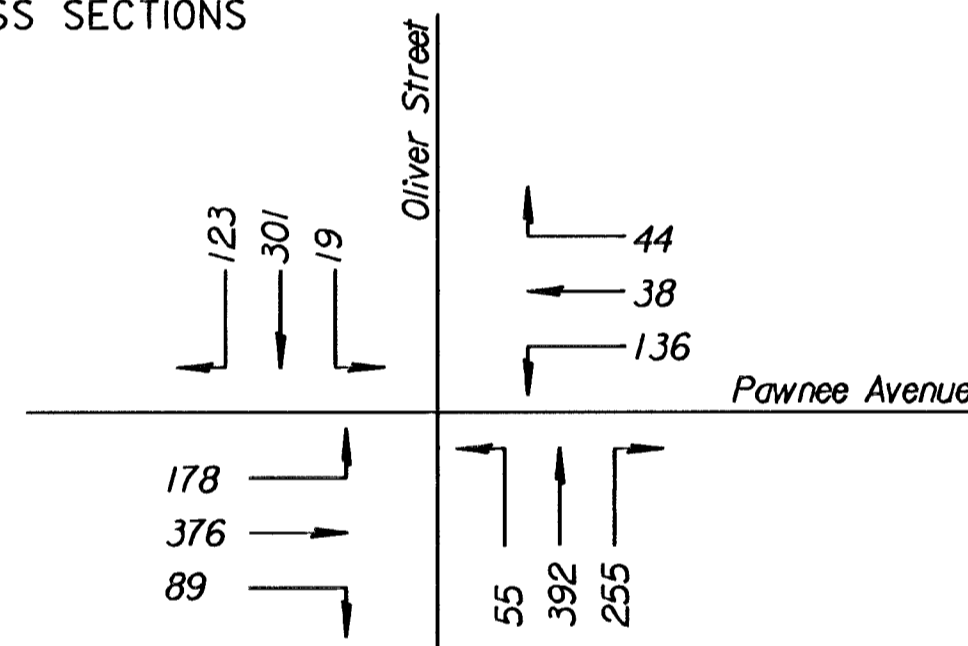

P.M. PEAK HOUR
4:45 P.M. TO 5:45 P.M.

DESIGN DESIGNATION

	PAWNEE AVENUE	OLIVER STREET
AADT (1997)	14,968	14,700
AADT (2018)		
DHV	0%	0%
D	60% WB	40% SB
T	1%	1%
V	65 km/h	65 km/h
C of A	None	None
Clear Zone	0.45 m	0.45 m

CONVENTIONAL SIGNS

COUNTY LINE	-----	CENTER LINE OF PROJECT	-----
CITY LIMITS	-----	TERRACE	-----
STATE OR NATIONAL LINE	-----	CULVERTS	-----
TOWNSHIP, SECTION or GRANT LINE	-----	DROP INLET & STORM SEWER	-----
PROPERTY LINE	-----	ACCESS CONTROL	-----
HIGHWAY FENCE	-----	POWER POLE	-----
EXISTING FENCE	-----	TELEPHONE POLE	-----
GUARD FENCE	-----	MARSH	-----
CONSTRUCTION LIMITS	-----	HEDGE	-----
RIGHT OF WAY LINE	-----	TREES	-----
TRAVELED WAY	-----	PROFILE ELEVATION	-----
RAILROADS	-----	STREAM or CREEK	-----

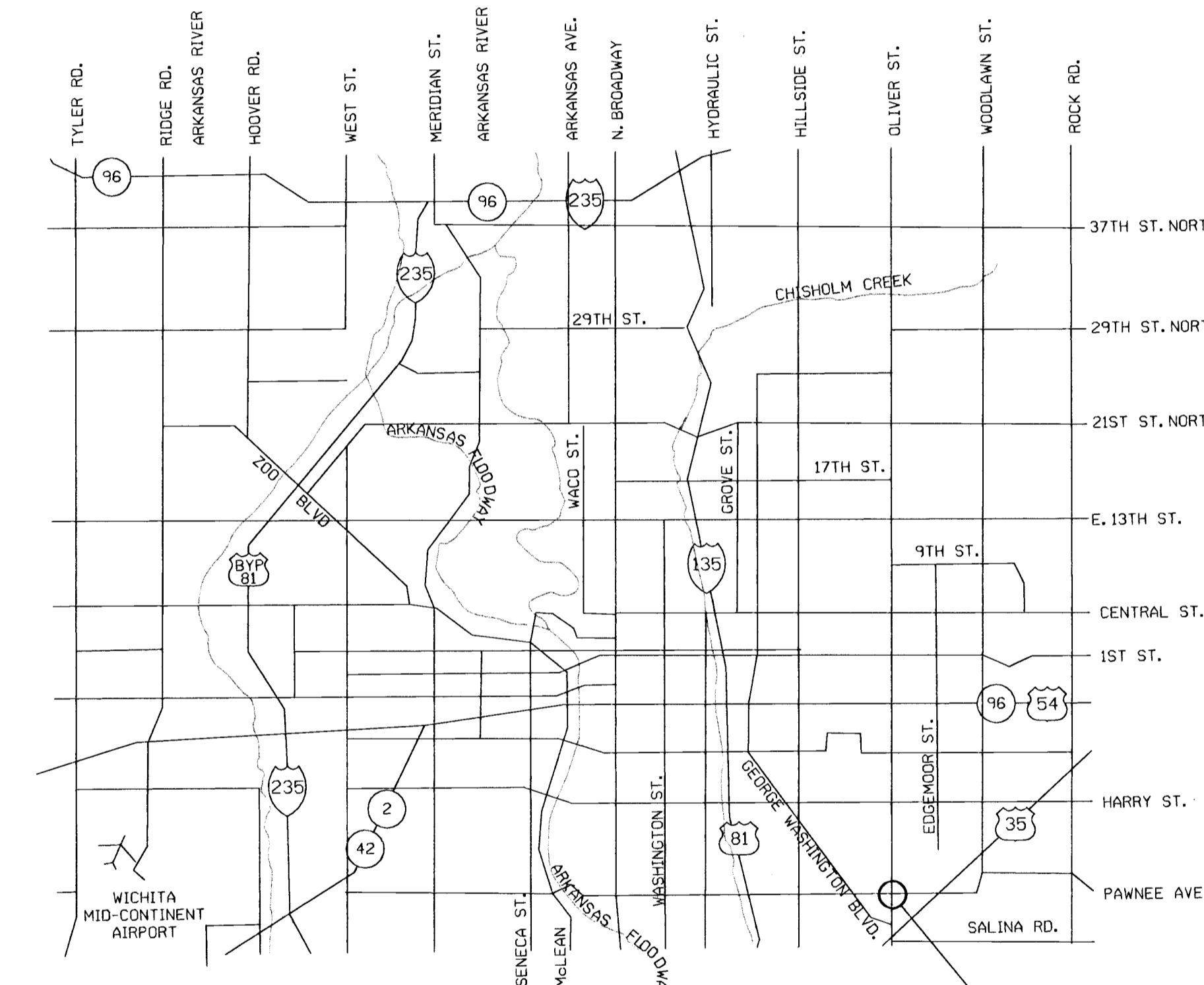

VICINITY MAP
NOT TO SCALE

Scale 1 : 4 000



P.O. BOX 1304
2319 NORTH JACKSON
JUNCTION CITY, KANSAS 66411
(913) 762-5040
FAX 913-762-7144

Sam Malinowsky
SAM MALINOWSKY
PROFESSIONAL ENGINEER
12595



RECOM. FOR APPROVAL-DATE

CHIEF, BUREAU OF LOCAL PROJECTS
KANSAS DEPARTMENT OF TRANSPORTATION

APPROVED - DATE

STATE TRANSPORTATION ENGINEER
KANSAS DEPARTMENT OF TRANSPORTATION

RECOM. FOR APPROVAL-DATE

CITY ENGINEER

APPROVED - DATE

GROSS LENGTH OF PROJECT	260.225 m
EXCEPTIONS	m
ADDITIONS	0
NET LENGTH OF PROJECT	260.225 m
NET LENGTH OF BRIDGES	0.00 m
NET LENGTH OF ROAD	260.225 m

BENCHMARK #1: CITY OF WICHITA BENCHMARK, BRASS CAP IN CONCRETE AT THE NORTHEAST CORNER OF OLIVER AND PAWNEE INTERSECTION. 15.85 m NORTH AND 12.802 m EAST OF CENTERLINE OF BOTH. 5.243 m EAST OF WEST FACE INLET, 0.548 m NORTH OF EAST-WEST SIDEWALK. 4.481 m NORTHEAST OF TRAFFIC LIGHT POLE. 4.359 m NORTHEAST OF CENTER STREET LIGHT POLE. 0.366 m WEST OF NORTH-SOUTH SIDEWALK.

U.S.G.S. ELEV. = 398.850
WICHITA ELEV. = 36.926

THIS PROJECT IS IN THE CITY OF WICHITA DATUM USING METRIC CONVERSION.

DATE	BY
6-96	R. SCOTT
7-96	J. OLSON
7-96	J. OLSON
7-96	S. MALINOWSKY
	K&W VALLEY ENGINEERING, L. PREEM

SURVEYED	R. SCOTT
PLOTTED	J. OLSON
INKED	J. OLSON
DESIGNED	S. MALINOWSKY
SOLAD	K&W VALLEY ENGINEERING, L. PREEM

Drawn By: J. Olson
DGN File: 1827 \ 1827TTL
Plotted: 5-31-00