

BENCHMARK:
 City of Wichita Benchmark Disk at
 South End of Hubguard on the SW
 Cor. of R.C.B.C., West Side of Rock
 Road, 706' North-northwest of the
 Northwest Corner of Lot 44, Block
 A, Rocky Ford Addition,
 Elev. = 1368.14 NAVD88

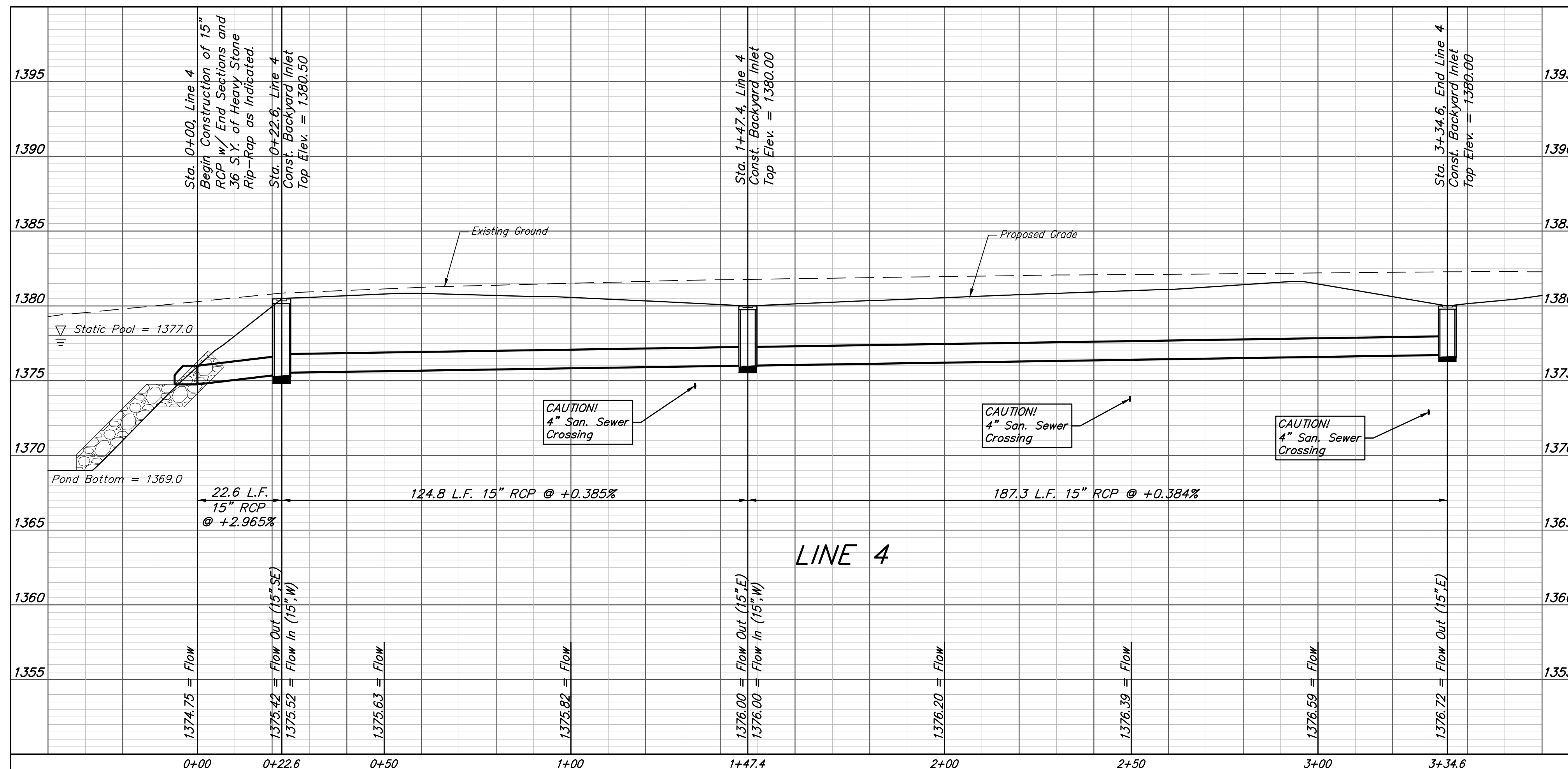
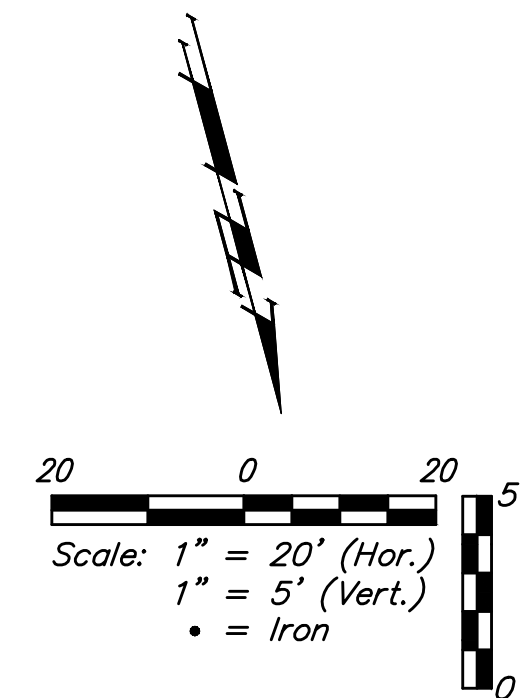
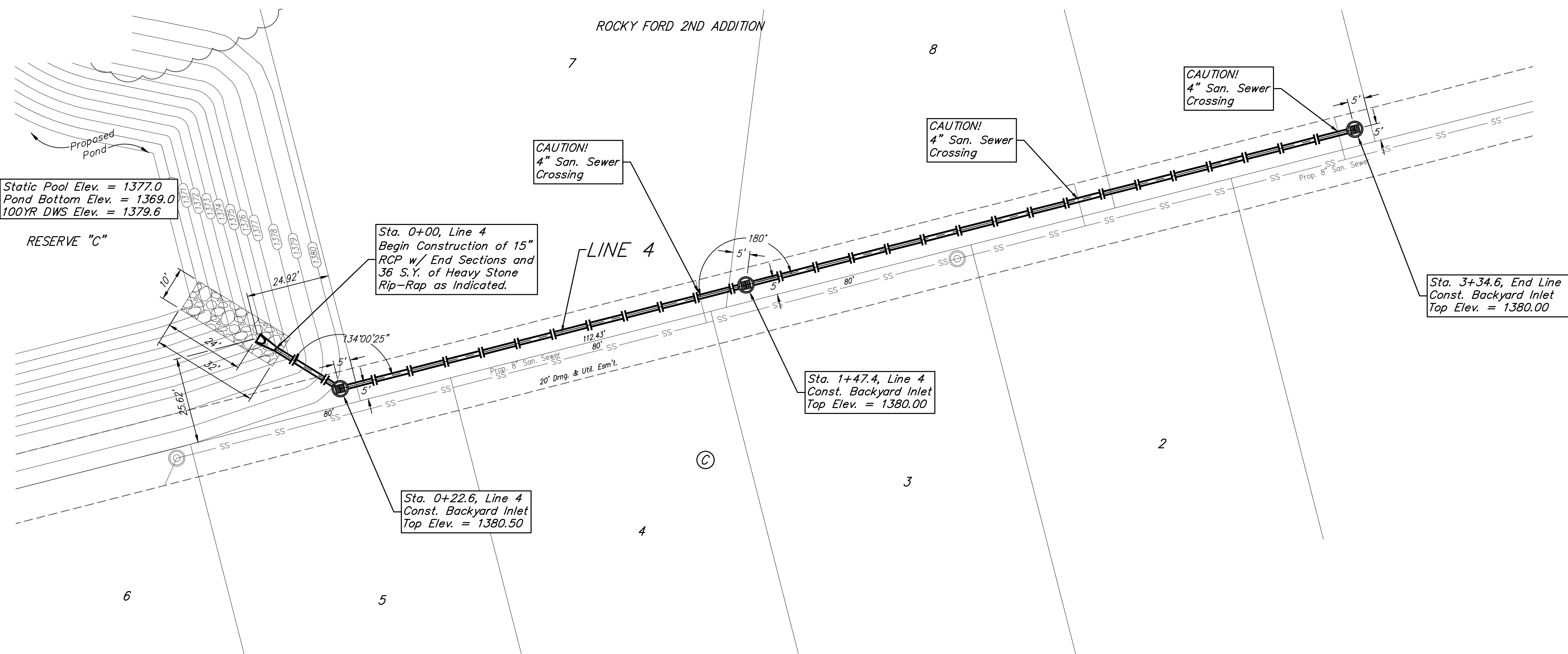

Baughman		Rocky Ford 2nd Addition	
		LINE 4	
		STORMWATER DRAIN #433	
Baughman Company, P.A. 315 Ellis St. Wichita, KS 67211 P 316-262-7271 F 316-262-0149 ENGINEERING SURVEYING PLANNING LANDSCAPE ARCHITECTURE			
PROJECT NUMBER 468-85285	DESIGN AEG	DRAWN JAK	
REVISIONS:	APPROVED	DATE 5/01/18	
	SCALE Noted	SHEET	5 OF 21