

J:\PROJECTS\2017\1701010567\_COW\_STRYKER\_170567\_CAD\SH1505\_CIVIL\LANDSCAPE\17567-05-7000.DWG  
 PLOTTED: Wednesday, May 02, 2018 @ 01:24PM

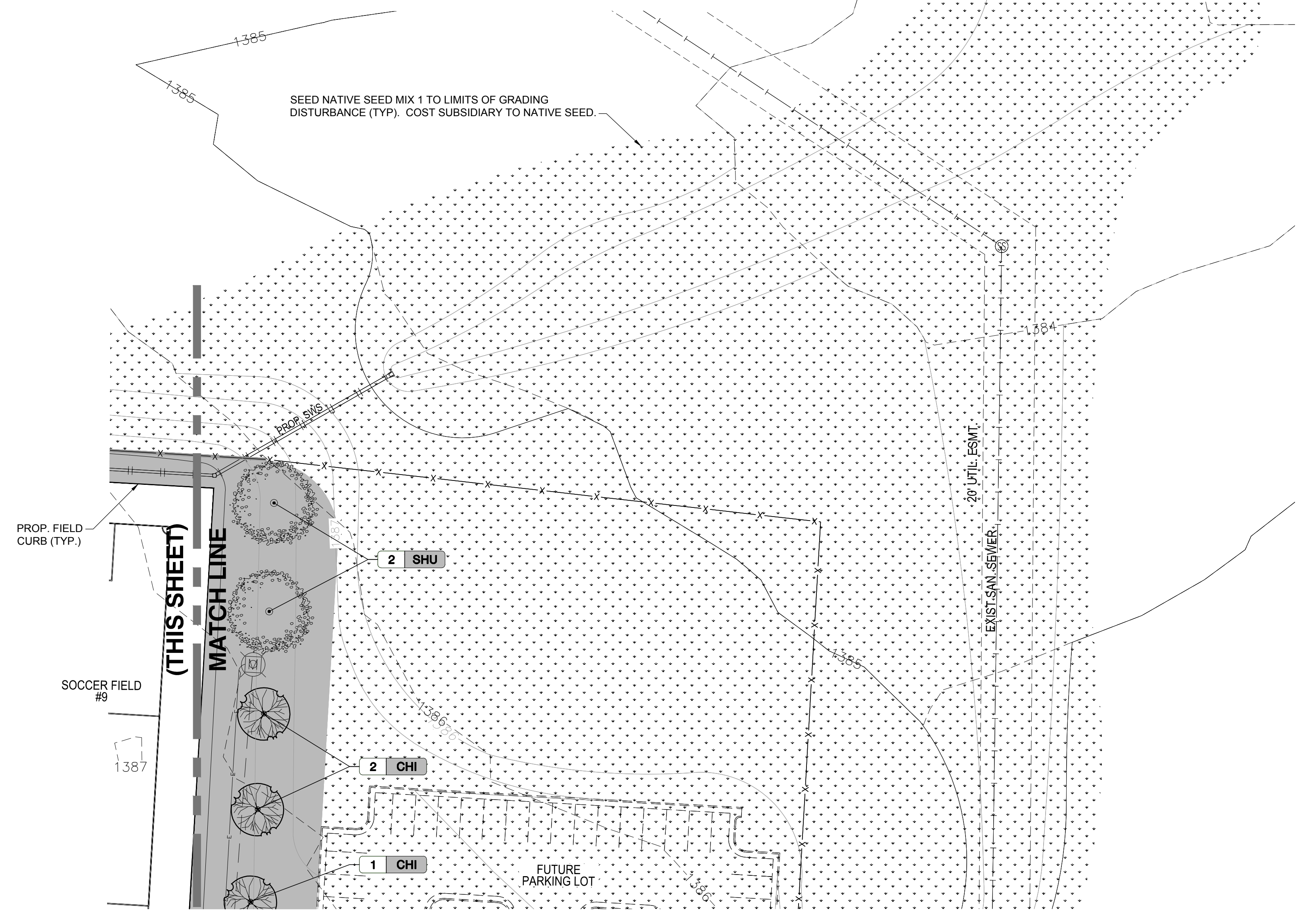

**LEGEND**

- FESCUE SOD
- FESCUE SEED
- NATIVE SEED MIX 1
- NATIVE SEED MIX 2
- EXISTING SANITARY SEWER
- EXISTING GAS LINE
- EXISTING WATER LINE
- EXISTING STORM SEWER
- PROPOSED STORM SEWER
- PROPOSED ELEC. CONDUIT
- PROPOSED CONTOURS
- EXISTING CONTOURS

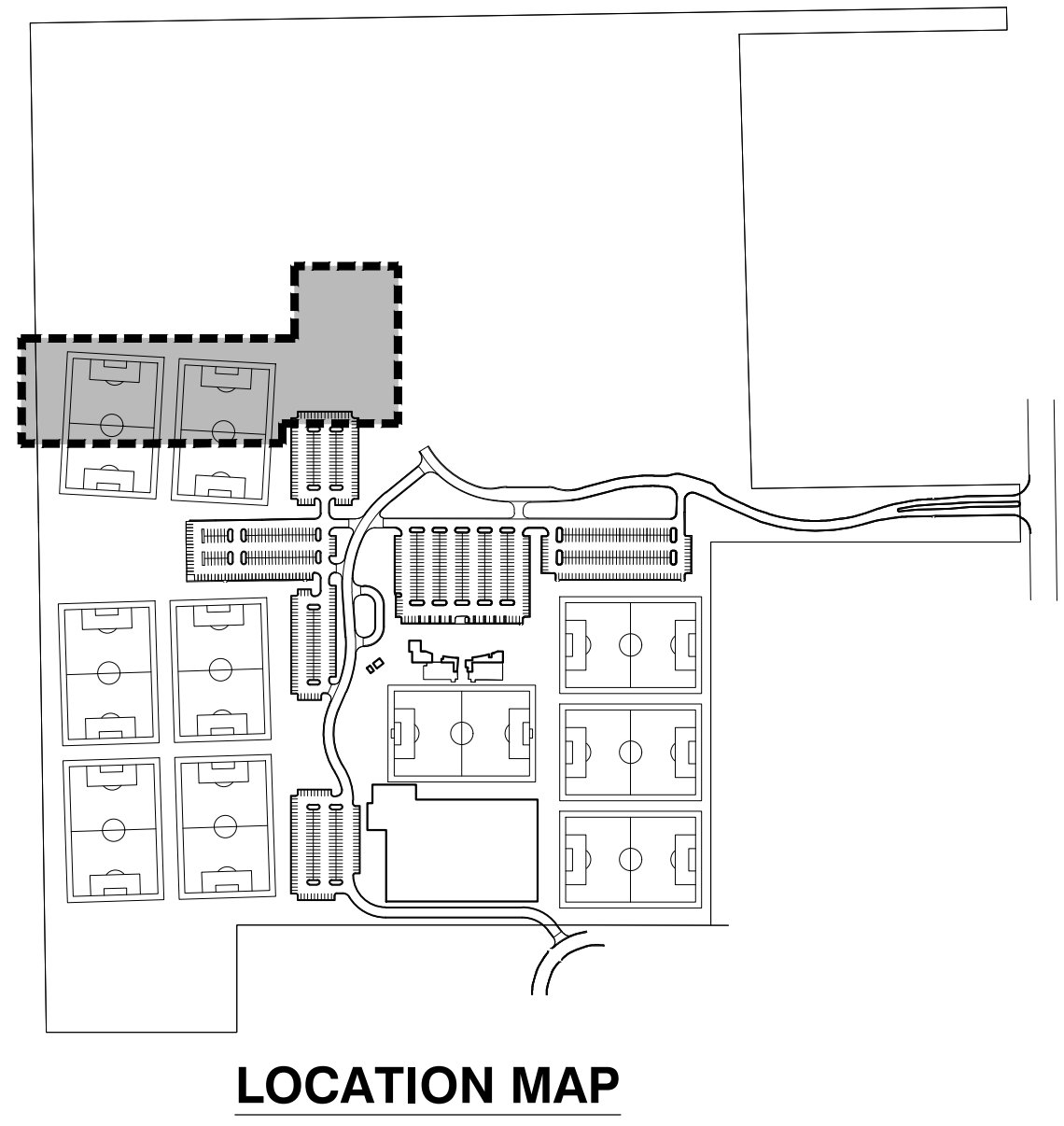
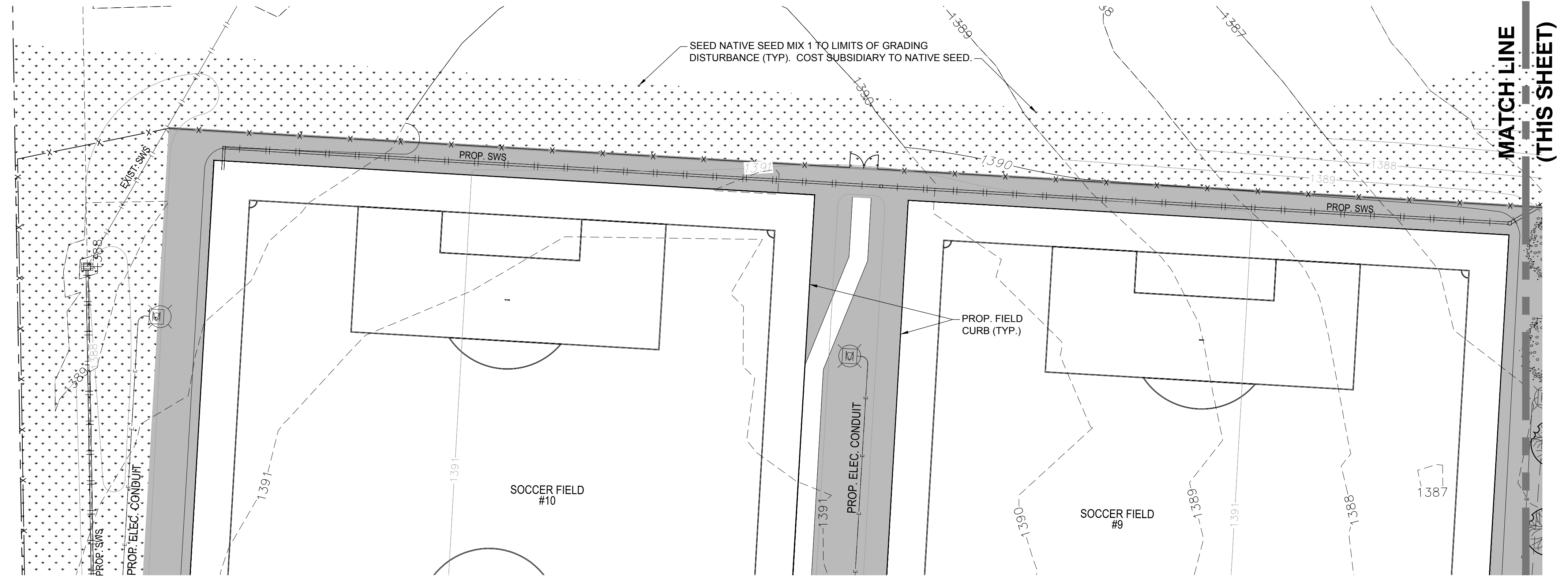
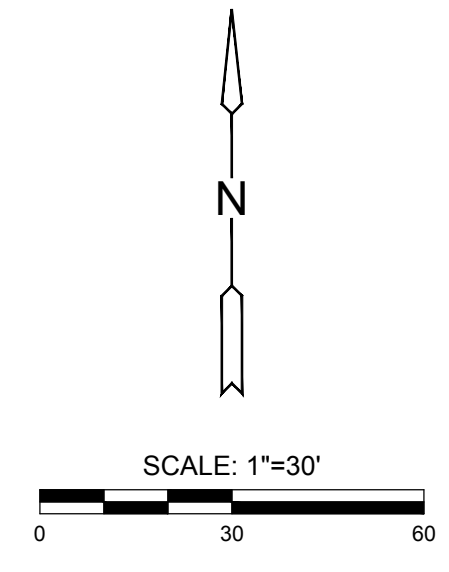

PAVING, LANDSCAPE & UTILITIES FOR  
**STRYKER SPORTS**  
 WICHITA, KANSAS



©2018  
 MKEC Engineering  
 All Rights Reserved  
 www.mkec.com  
 These drawings and their contents, including, but not limited to, all concepts, designs, & ideas are the exclusive property of MKEC Engineering (MKEC), and may not be used or reproduced in any way without the express consent of MKEC.

**LANDSCAPE SHEET 1**

PROJECT NO.	1701010567
DATE	MAY 2, 2018
SCALE	1" = 30'
DESIGNED	RKO
DRAWN	RKO
CHECKED	MAB
0 ISSUED FOR CONST.	05-02-18
NO. REVISION	DATE
SHEET NO.	53 OF 102