

## GENERAL NOTES:

- The Contractor shall give all property owners and/or tenants of developed property abutting the project limits a minimum of ten (10) days advance notice prior to start of construction. See Project Special Provisions for additional notification requirements.
- Contractor will be required to provide a minimum advance notice of seventy-two (72) hours to utility companies prior to excavation or working adjacent to utilities. Kansas One-Call: 687-2470
- Existing utilities and their locations, as shown on the plan, represent the best information obtainable at the time of design. The Contractor shall be aware that construction will occur in close proximity to existing utilities, and any conflicts with such utilities shall be reported to the Engineer. The Contractor should also be aware that some utility lines within the Project corridor may have been abandoned in place as new lines are installed. Contractor shall be responsible for notifying the affected utility to determine the status of said lines.
- The Water Department shall field locate water valves one time during construction when requested by the Contractor. It shall be the Contractor's responsibility to preserve such field locations during the construction process. Water valves, water valve boxes or fire hydrant damaged during construction shall be repaired by the Contractor at his own expense.
- All project waste including any trees, milled asphalt, rubble from miscellaneous structures, abandoned pipes, excess excavation & etc. shall be disposed of on sites to be provided by the Contractor. These sites shall be approved by the Engineer as to suitability, appearance and site location. Locations that, in the opinion of the Engineer, will leave an unsightly appearance will not be approved. All disposal sites must be approved by the Kansas Department of Health and Environment. Material either stockpiled or disposed of in a flood plain would require a Kansas State Board of Agriculture permit. Any material dumped in waters of the United States or wetlands is subject to U.S. Corps. of Engineers permitting regulations. Any material buried or stockpiled beyond approved construction limits would require additional archaeological investigations unless buried in a previously approved borrow location.
- Prior to bidding the project, each bidder shall visit the site and satisfy himself of surface & subsurface conditions. Each bidder shall also fully inform himself as to the extent of the scope of work to be performed. Each bidder shall also be aware that no additional compensation will be awarded for extra work that should have been evaluated prior to bidding.
- Irons and monuments found are shown on the Plans. The Contractor shall be responsible for notifying the Engineer prior to excavation or clearing operations that will endanger said irons so that accurate ties can be determined for resetting. The Contractor shall be responsible for replacing shown property irons that are damaged or removed during construction. The Contractor shall procure a licensed Land Surveyor to locate and re-install the property iron.
- The Contractor shall be responsible for implementing erosion control methods during construction to prevent unnecessary silt/sediment discharge through downstream properties and/or storm sewer systems. The Contractor shall install and maintain erosion controls as directed by the Engineer. These controls may include, but not limited to: hay bales; silt fences; temporary seeding, Excelsior I Erosion Control Blanket (Curlex), or approved equal, or other controls necessary to inhibit sediment runoff during construction.
- The Contractor shall not start work on the Project until the Project Inspector is assigned and is present on site. Any work done without inspection will be required to be uncovered for inspection. Staking and inspection for this Project will be the responsibility of the City of Wichita.
- The Contractor shall comply with all applicable safety regulations and City of Wichita Specifications and Standards.
- The Contractor shall be responsible for all traffic control measures to facilitate construction. All Construction Zone markings and signage shall conform to the latest version of the Manual on Uniform Traffic Control Devices (MUTCD) as published by the US Dept. of Transportation, Federal Highway Administration. All costs associated with construction markings and signage shall be SUBSIDIARY to the lump sum Bid Item "Traffic Control".
- The Contractor shall protect utility lines that cross or abut the Project corridor. For larger lines, the Contractor's method of supporting the utility structure shall be provided to the Engineer, as well as the affected Utility Company's representative for review and approval. Any shutdown of a utility line that may be required by construction of this Project shall be coordinated with the said affected utility.
- Adjacent Buildings, Structures, Parking Lots, Driveways, etc. other than those shown for replacement shall be protected from damage during construction of this Project.
- Trees that require trimming for the Project construction shall not be done with a back hoe, but only by approved methods concurrent with standard tree trimming methods. All Tree Trimming Operations shall be considered as SUBSIDIARY to "Site Clearing" bid item.
- The Contractor shall remove and stockpile in a central location for the inspector to take to the Central Maintenance Facility, 801 S. McLean, all regulatory signs, street name signs, information signs, and etc. that conflict with the proposed construction.
- A full depth saw cut of the existing surface courses or the existing total pavement thickness shall be provided at the locations where proposed construction abuts an existing surface course or pavement for which partial removal of that surface or pavement is required. Sawed joint to facilitate removal within three (3) feet of existing joints will not be permitted and for such instances the limits of removal shall extend to the existing joint. Such saw cuts will not be paid for directly and this cost shall be considered SUBSIDIARY to the pavement removal.
- All Elevations shown are based on NAVD 88 Datum.
- Valve Boxes and Water Meters within the Project Limits shall be adjusted to match Final Grade.
- Existing Power & Light poles may require bracing during certain phases of the Project. The Contractor shall be responsible for coordinating the pole bracing with Randy Truitt with Westar at 261-6521 at least 3 weeks prior to beginning construction.

# Left Turn Lane and Decel Lane Paving Improvements to serve GODDARD SCHOOL 2ND ADDITION Lot 1, Block 1 CITY OF WICHITA, KANSAS

Gary Janzen, P.E. City Engineer  
Project Number  
472-84754  
OCA Number  
766419

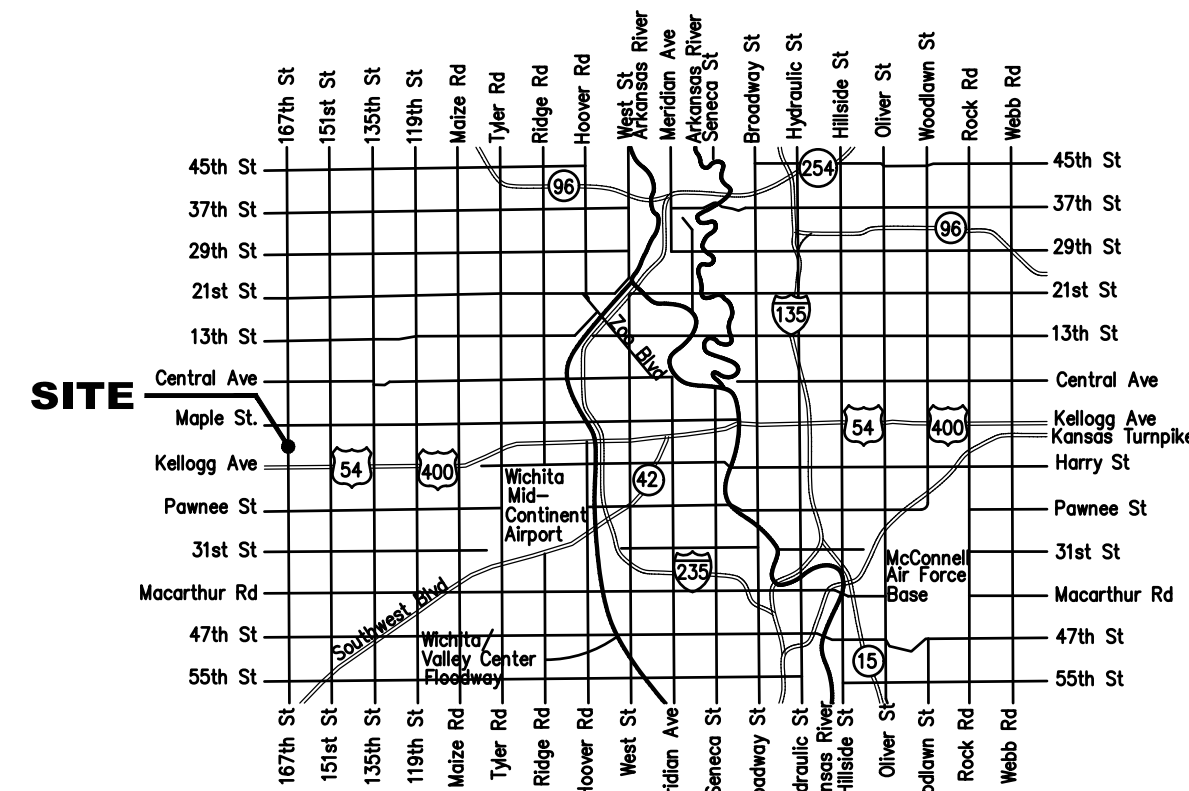

## VICINITY MAP

## SHEET INDEX

- Title Sheet
- Typical Pavement Sections
- 167th Street Paving Plans
- Drive Entrance Details
- Marking Plan
- Traffic Control Plan
- Detour Plan
- Cross Sections & Volume Table
- Erosion Control Plan
- BMP Details

## UTILITY CONTACTS

OWNER	CONTACT	TELEPHONE
Kansas One-Call	-	1-800-344-7233
Cox Communications (Cable)	James Walburn	316-260-7491
AT&T	Jason Edwards	316-268-2102
Westar Energy	Ken McLemore	316-648-9190
Kansas Gas Service	Joe Bridgewater	316-832-3158
City of Wichita Water	Greg Lolley	316-268-4545
City of Wichita Storm Water	Kelly Fleming	316-268-4545
City of Wichita Traffic	Brian Coon	316-268-4448
Conoco Phillips Pipeline	Andre Martinez	316-655-5058
KPC Pipeline	Adam Cowart	620-886-0082

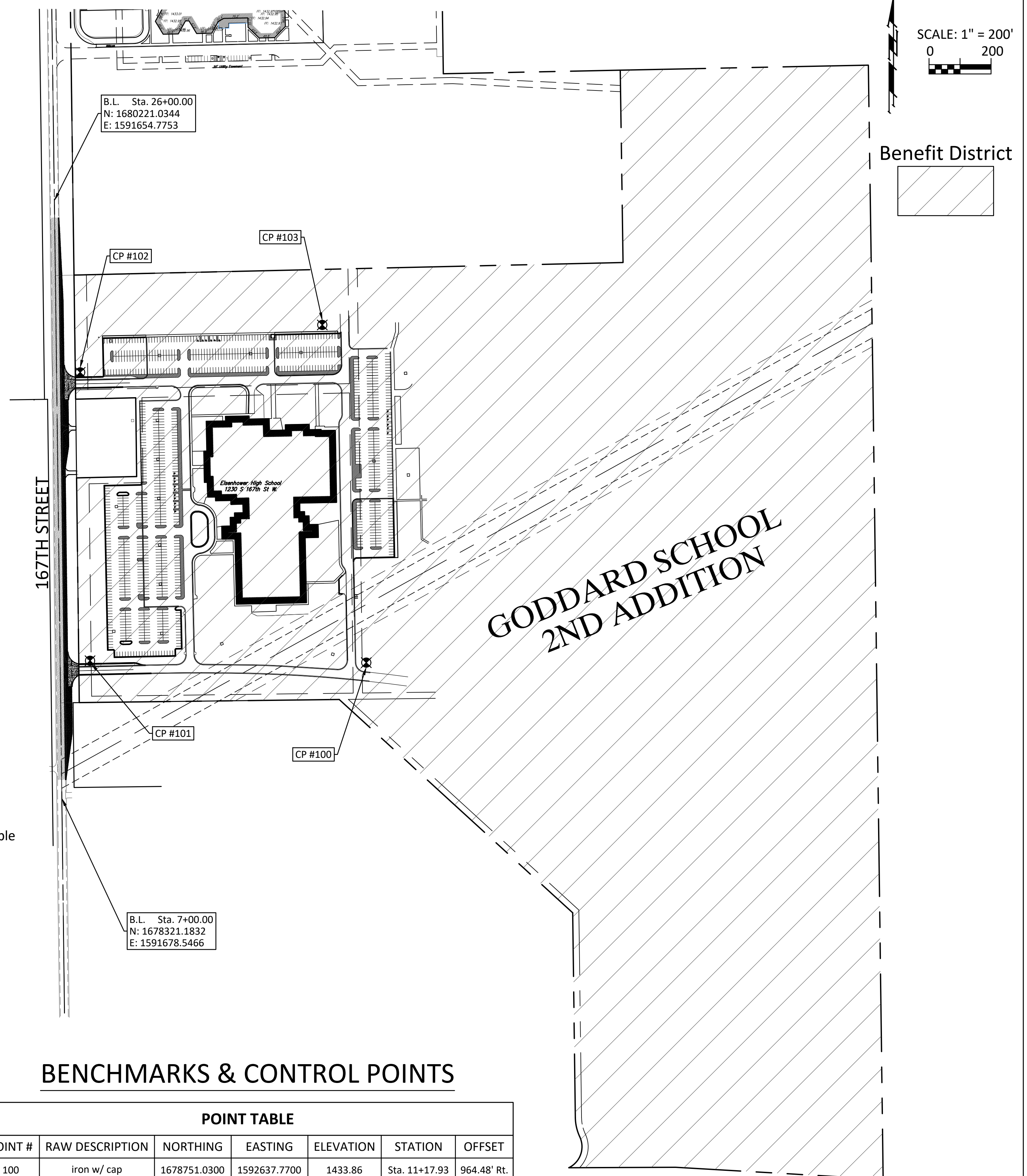

## BENCHMARKS & CONTROL POINTS

POINT TABLE						
POINT #	RAW DESCRIPTION	NORTHING	EASTING	ELEVATION	STATION	OFFSET
100	iron w/ cap	1678751.0300	1592637.7700	1433.86	Sta. 11+17.93	964.48' Rt.
101	iron w/ cap	1678760.5000	1591768.9500	1436.44	Sta. 11+38.16	95.84' Rt.
102	iron w/ cap	1679672.7400	1591738.1100	1436.06	Sta. 20+50.71	76.31' Rt.
103	iron w/ cap	1679831.1300	1592552.0100	1433.38	Sta. 21+99.01	892.11' Rt.

