

BENCHMARKS:

BM #1 - City of Wichita Bench Mark Disc, 42' North and 41' West of Centerlines Hydraulic and 55th St. South. Sta. 63+56.1, 41' Lt. Elev. = 76.19 (City Datum)

P.V.I. No V.C. ELEV.=75.20

P.V.I. No V.C. ELEV.=74.23

P.V.I. 50' V.C. ELEV.=73.50

Poles to be Temporarily Braced During Storm Water Sewer Construction. Coordinate with Westor. (Provide at Least 2 Weeks Notice)

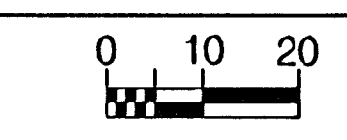

SCALE: 1" = 20'

| FINA REGION NO. | STATE | PROJECT NO. | FISCAL YEAR | SHEET NO. | TOTAL SHEETS |
|-----------------|--------|--------------|-------------|-----------|--------------|
| 7 | KANSAS | 87 N-0303-01 | 2003 | 13 | 143 |

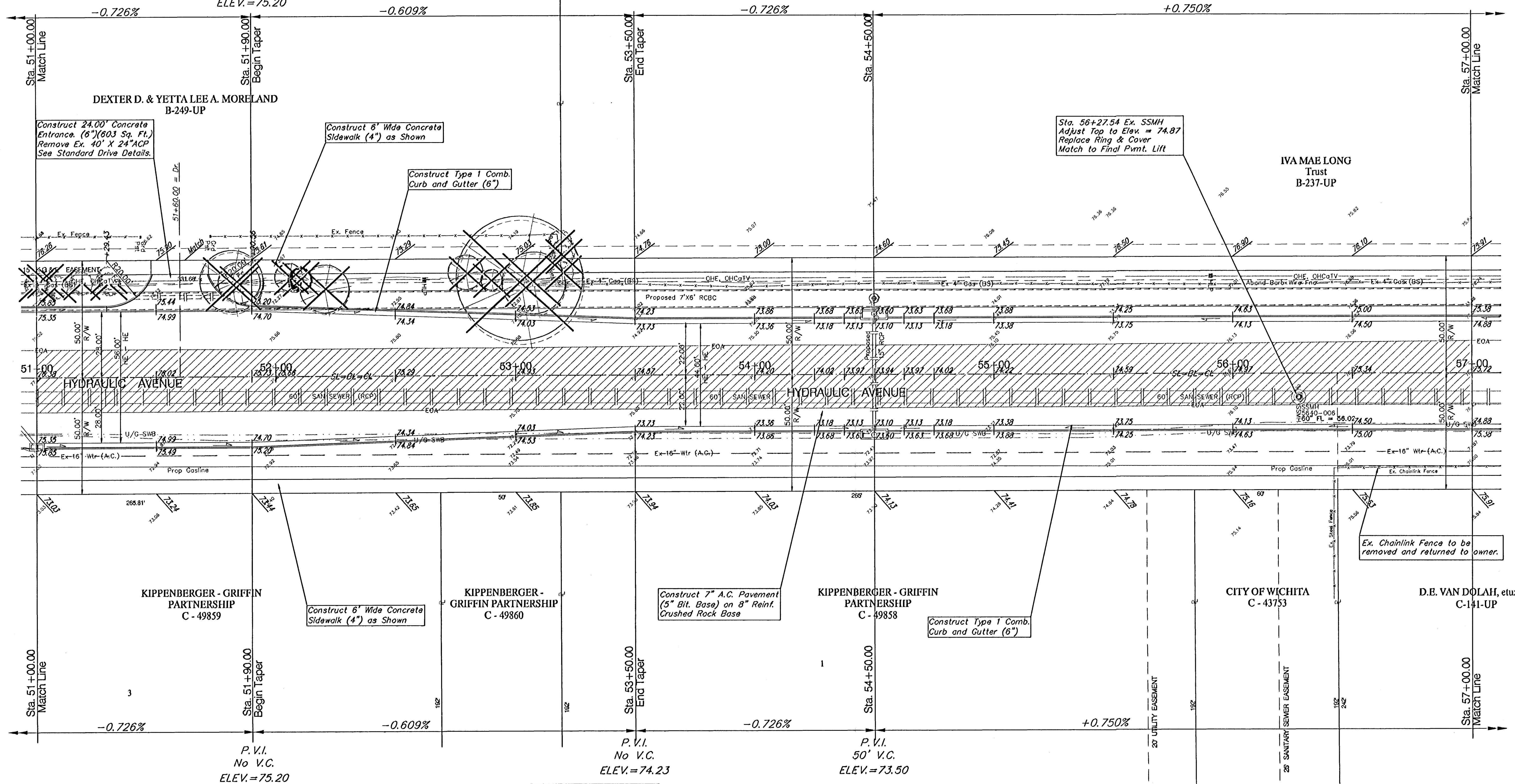

Note:
Trees/Shrubs to be removed are marked thus:

Note:
Pavement, Sidewalks, and Etc. To Be Removed Are Indicated By:

| | | |
|-----------------------------|---------------------|---|
| PROJECT NUMBER 472-83902 | SHEET NAME PAV02 | ENGINEERING DIRECTORY F:\Eng\Hydraulic_phs2\ Pav |
| DESIGN JFB | DRAWN TCA | DATE Aug 03 |
| APPROVED JFB/KK | SCALE 1"=20' | BAUGHMAN NO. 99-09-B451 |

STREET & SWS IMPROVEMENTS
PAVING PLAN
HYDRAULIC AVE PAVING - SOUTH OF 57th STREET SOUTH TO 47th STREET SOUTH

BAUGHMAN COMPANY, P.A.
ENGINEERING, SURVEYING, & PLANNING
310-262-7271 • 315 ELLIS • WICHITA, KANSAS 67211

SHEET 13 OF 143