

BENCHMARKS:

BM #1 - City of Wichita Bench Mark Disc, 42' North and 41' West of Centerlines Hydraulic and 55th St. South. Sta. 63+56.1, 41' Lt. Elev. = 76.19 (City Datum)

FEMA REGION NO.	STATE	PROJECT NO.	FISCAL YEAR	SHEET NO.	TOTAL SHEETS
7	KANSAS	87 N-0303-01	2003	25	143

End 55th Street Construction

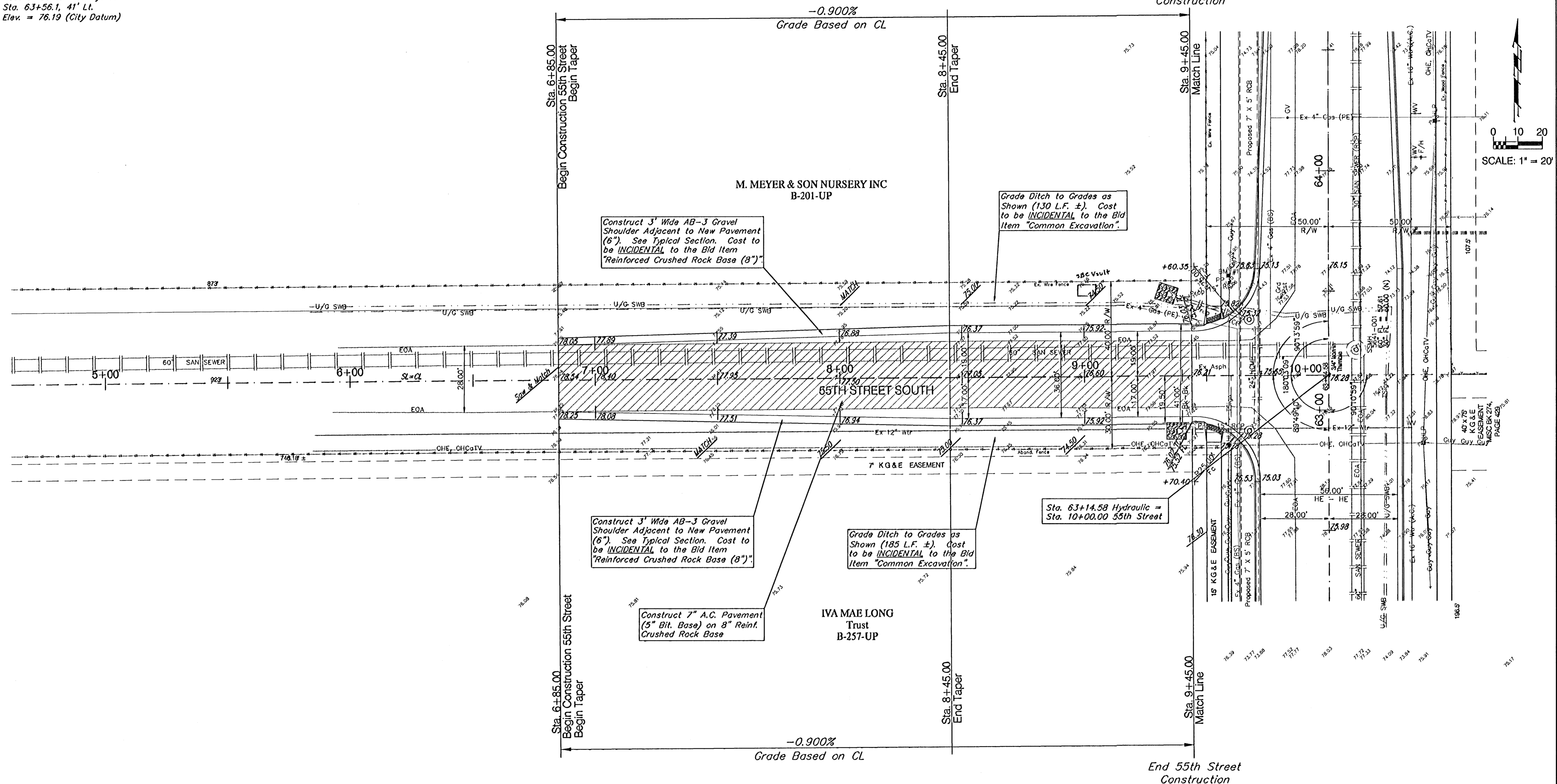

Construct 3' Wide AB-3 Gravel Shoulder Adjacent to New Pavement (6"). See Typical Section. Cost to be INCIDENTAL to the Bid Item "Reinforced Crushed Rock Base (8)".

Grade Ditch to Grades as Shown (130 L.F. ±). Cost to be INCIDENTAL to the Bid Item "Common Excavation".

Construct 3' Wide AB-3 Gravel Shoulder Adjacent to New Pavement (6"). See Typical Section. Cost to be INCIDENTAL to the Bid Item "Reinforced Crushed Rock Base (8)".

Grade Ditch to Grades as Shown (185 L.F. ±). Cost to be INCIDENTAL to the Bid Item "Common Excavation".

Construct 7" A.C. Pavement (5" Bit. Base) on 8" Reint. Crushed Rock Base

Sta. 63+14.58 Hydraulic = Sta. 10+00.00 55th Street

Note:
Pavement, Sidewalks, and Etc. To Be Removed Are Indicated By:

Note:
Trees/Shrubs to be removed are marked thus:



PROJECT NUMBER 472-83902		SHEET NAME PAV14		ENGINEERING DIRECTORY P:\Eng\Hydraulic_phs2\Pav	
DESIGN JFB	DRAWN TCA	APPROVED JFB/KK	DATE Aug 03	SCALE 1"=20'	BAUGHMAN NO. 99-09-E451

STREET & SWS IMPROVEMENTS
PAVING PLAN
HYDRAULIC AVE PAVING - SOUTH OF 57th STREET SOUTH TO 47th STREET SOUTH

BAUGHMAN COMPANY, P.A.
ENGINEERING, SURVEYING, & PLANNING
318-282-7271 • 315 ELLIS • WICHITA, KANSAS 67211

SHEET
25
OF
143