

\*\* - Exposed Rebar Steel from End of Pre-cast RCBC Section. 1'-0" Min into Outlet Structure.

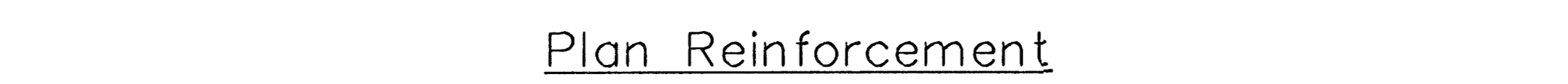

Bar No.	D1	D2	E1	H1	H2	H3	H4	H5	H6	V1	V2	V3
Quant	255	23	2	8	8	4	4	8	8	144	8	66
Length	5'0"	3'8"	16'5"	49'2"	***	29'6"	4'0"	34'9"	***	***	7'11"	7'2"

\*\*\* - See Bending Diagram

