

BENCHMARKS:
 BM #3 - RR Spike in West face of HLP, East side of Hydraulic, at House No. 5300 south. Sta. 82+33.6, 41' Rt. Elev. = 79.63 (City Datum)

0 10 20
 SCALE: 1" = 20'

FEMA REGION NO.	STATE	PROJECT NO.	FISCAL YEAR	SHEET NO.	TOTAL SHEETS
7	KANSAS	87-N-0303-01	2003	77	143

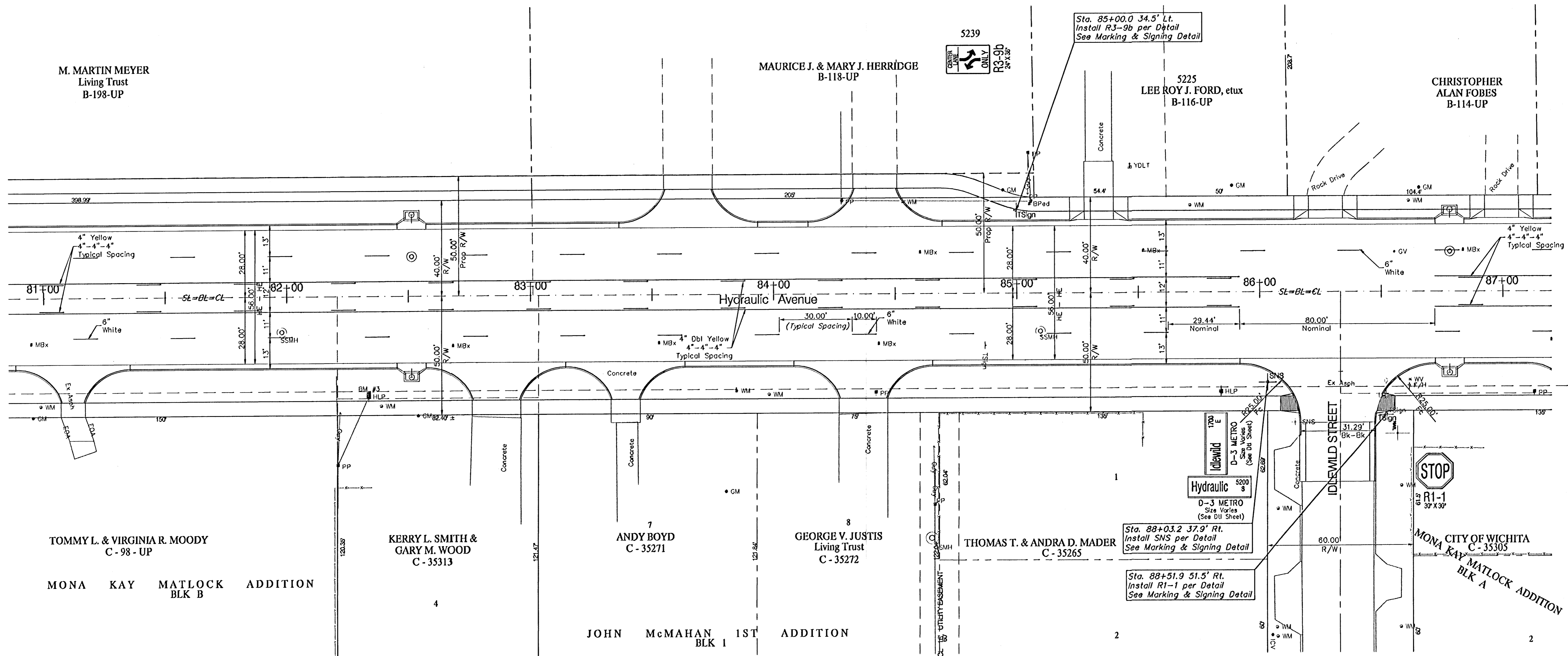

PROJECT NUMBER 472-83902		SHEET NAME Mark07		ENGINEERING DIRECTORY F:\Eng\Hydraulic phs2\Traffic		CAPITAL IMPROVEMENT PROJECT PAVEMENT MARKING PLAN HYDRAULIC AVE PAVING - SOUTH OF 57th STREET SOUTH TO 47th STREET SOUTH		BAUGHMAN COMPANY, P.A. ENGINEERING, SURVEYING, & PLANNING 318-282-7271 • 315 ELLIS • WICHITA, KANSAS 67211		SHEET 77 OF 143
DESIGN JFB	DRAWN TCA	APPROVED JFB/KK	DATE March 04	SCALE 1"=20'	BAUGHMAN NO 99-09-E451					