

BENCHMARKS:
 BM #6 - RR Spike in West face of HLP, East side of Hydraulic, south of Fairhaven St.
 west of the entrance to Yellow Trucking Co. Sta. 105+13.3, 39.6' Rt.
 Elev. = 83.23 (City Datum)

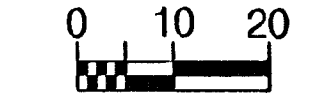

FEMA REGION NO.	STATE	PROJECT NO.	FISCAL YEAR	SHEET NO.	TOTAL SHEETS
7	KANSAS	87 N-0303-01	2003	81	143

SCALE: 1" = 20'

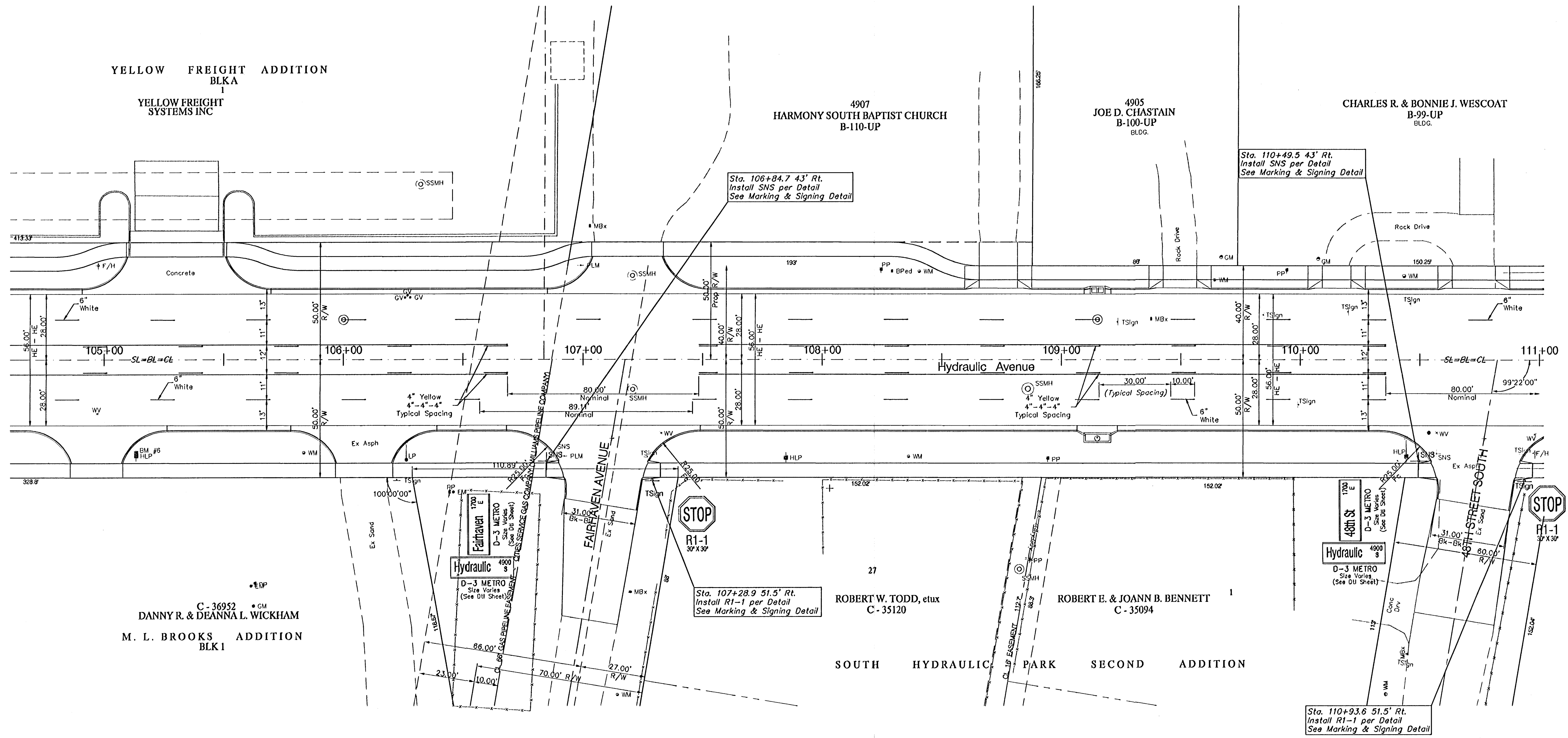

PROJECT NUMBER 472-83902		SHEET NAME Mark11		ENGINEERING DIRECTORY E:\Eng\Hydraulic_phs2\Traffic		CAPITAL IMPROVEMENT PROJECT	
DESIGN JFB	DRAWN TCA	APPROVED JFB/KK	DATE March 04	SCALE 1"=20'	BAUGHMAN NO 99-09-E451	PAVEMENT MARKING PLAN	
HYDRAULIC AVE PAVING - SOUTH OF 57th STREET SOUTH TO 47th STREET SOUTH						BAUGHMAN COMPANY, P.A. ENGINEERING, SURVEYING, & PLANNING 316-282-7211 • 316 ELLIS • WICHITA, KANSAS 67211	

SHEET
81
OF
143