

BENCHMARKS:
 BM #7 - City of Wichita bench Mark Disc on signal pole base 40.4' south and 57.5' East of centerlines of Hydraulic & 47th St. South.
 Sta. 115+07.4, 57.5' Rt. Elev. = 84.99 (City Datum)

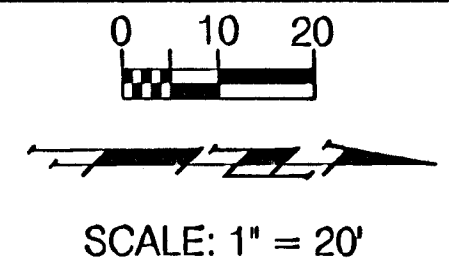

FWA REGION NO.	STATE	PROJECT NO.	FISCAL YEAR	SHEET NO.	TOTAL SHEETS
7	KANSAS	87-N-0303-01	2003	82	143

CHECK FOR UTILITY EASEMENT HERE

UNIFIED SCHOOL DISTRICT NO. 259
 B-111-UP

DANIEL J. MERLE M. HEINZ
 B-101-UP

STEVEN P. & CONNIE S. LEE
 B-102-UP

JACK PEARCE INC, etal
 B - 12523

BILLIE M. TUCKER, etux
 B - 12522

Sta. 112+50.0 34.0' Lt.
 Install R3-9b per Detail
 See Marking & Signing Detail

Sta. 114+00.0 33.8' Lt.
 Install R2-1 per Detail
 See Marking & Signing Detail

Sta. 111+22.5 34' Rt.
 Install S1-1 per Detail
 Install W16-9p per Detail
 See Marking & Signing Detail

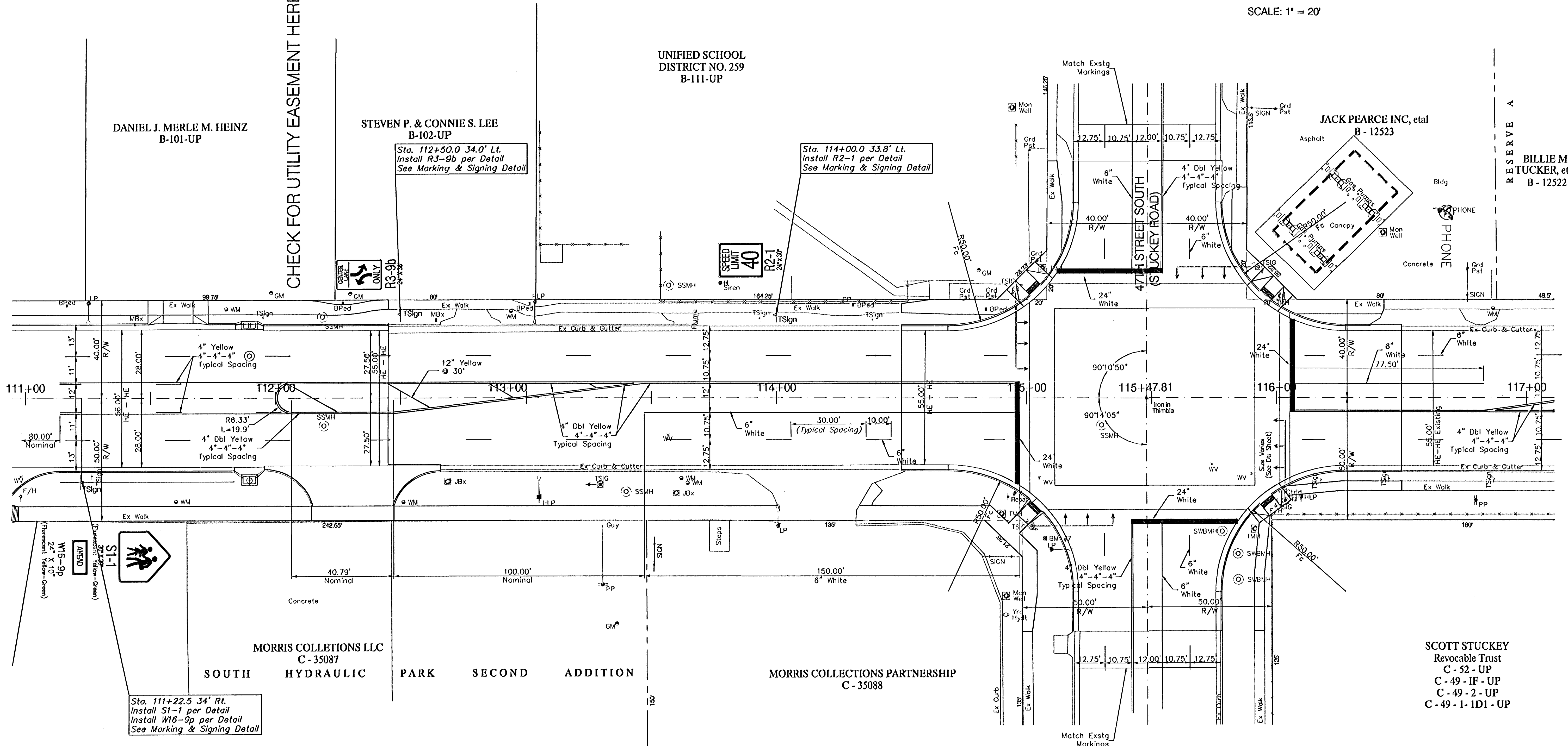

PROJECT NUMBER 472-83902		SHEET NAME Mark12		ENGINEERING DIRECTORY F:\Eng\Hydraulic_phs2\Traffic	
DESIGN JFB	DRAWN TCA	APPROVED JFB/KK	DATE March 04	SCALE 1"=20'	BAUGHMAN NO 99-09-E451

CAPITAL IMPROVEMENT PROJECT
PAVEMENT MARKING PLAN
 HYDRAULIC AVE PAVING - SOUTH OF 57th STREET SOUTH TO 47th STREET SOUTH

BAUGHMAN COMPANY, P.A.
 ENGINEERING, SURVEYING, & PLANNING
 316-282-7271 • 315 ELLIS • WICHITA, KANSAS 67211

SHEET
82
OF
143