

| FINA REGION NO. | STATE | PROJECT NO. | FISCAL YEAR | SHEET NO. | TOTAL SHEETS |
|-----------------|--------|-------------|-------------|-----------|--------------|
| 7 | KANSAS | 87N-0303-01 | 2003 | 102 | 143 |

Contractor shall maintain two way traffic the full length of the project at all times except for localized flagging at individual locations during working hours. Flagging operations to conform to the latest addition of the MUTCD.

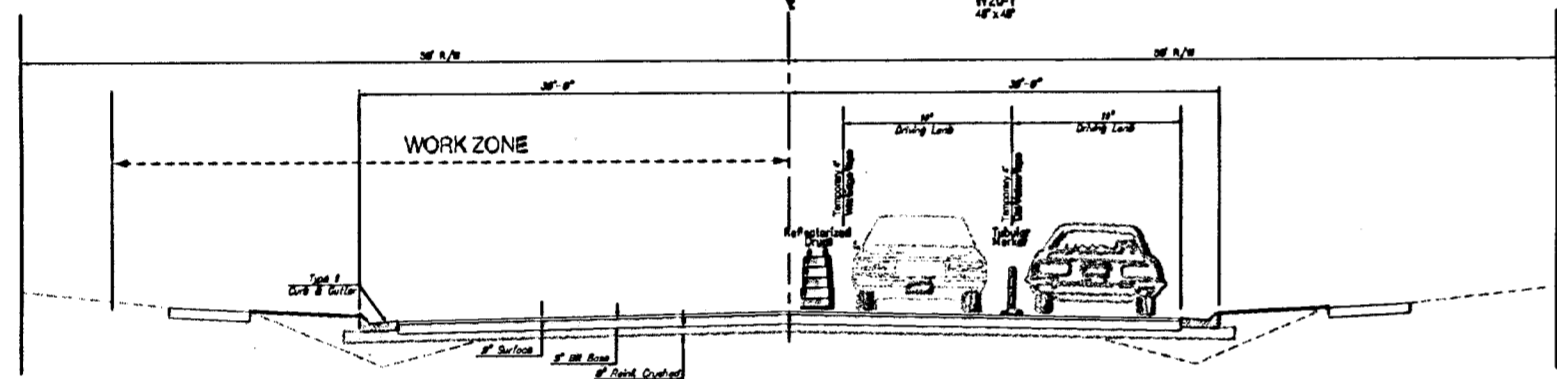

PHASE VI (Looking North)
Continue Construction of Roadway - West Side Hydraulic South of 57th Street to 50th Street

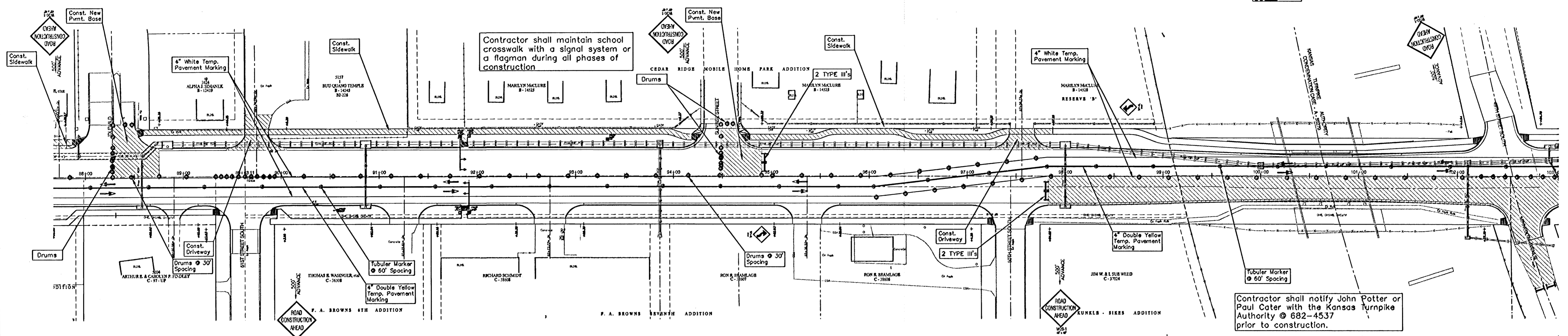
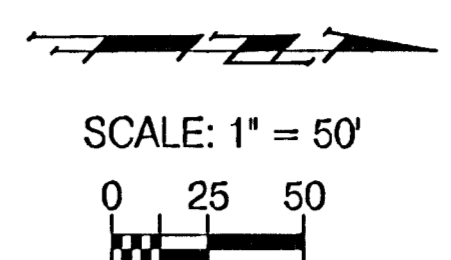
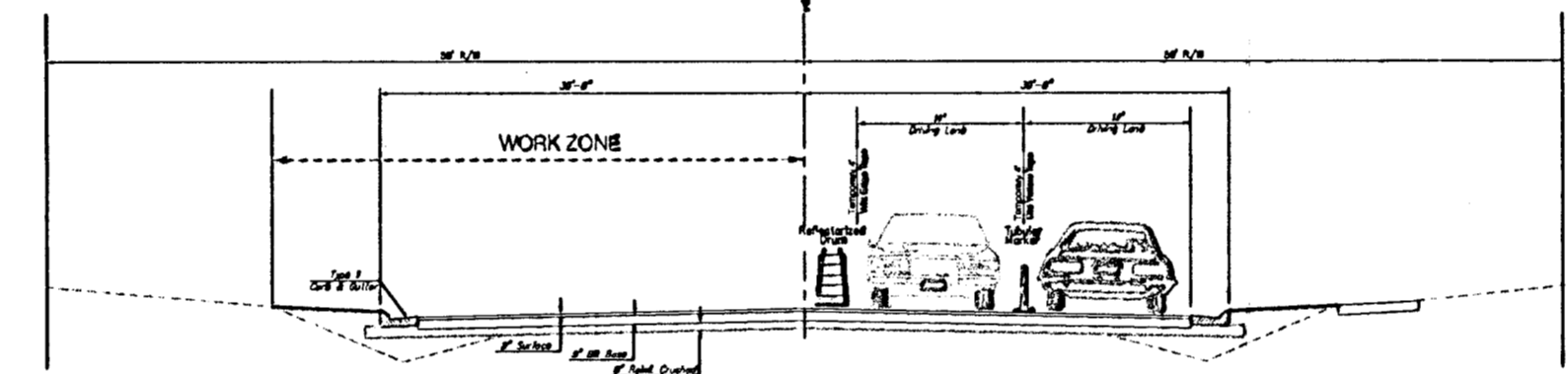

PHASE VI (Looking South)
Construct Roadway - East Side Hydraulic North of 50th Street to Center of 47th Street
Construct P.A.C. Pavement on 8' Base

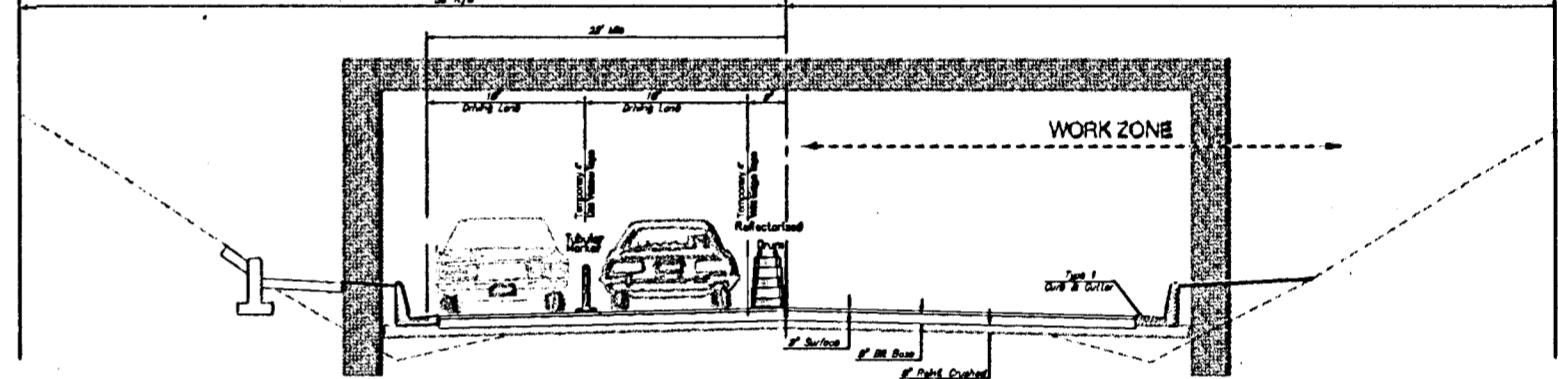

PHASE VI (Looking North)
Construct Roadway - East Side Hydraulic Under the Kansas Turnpike Bridge
Construct P.A.C. Pavement on 8' Base

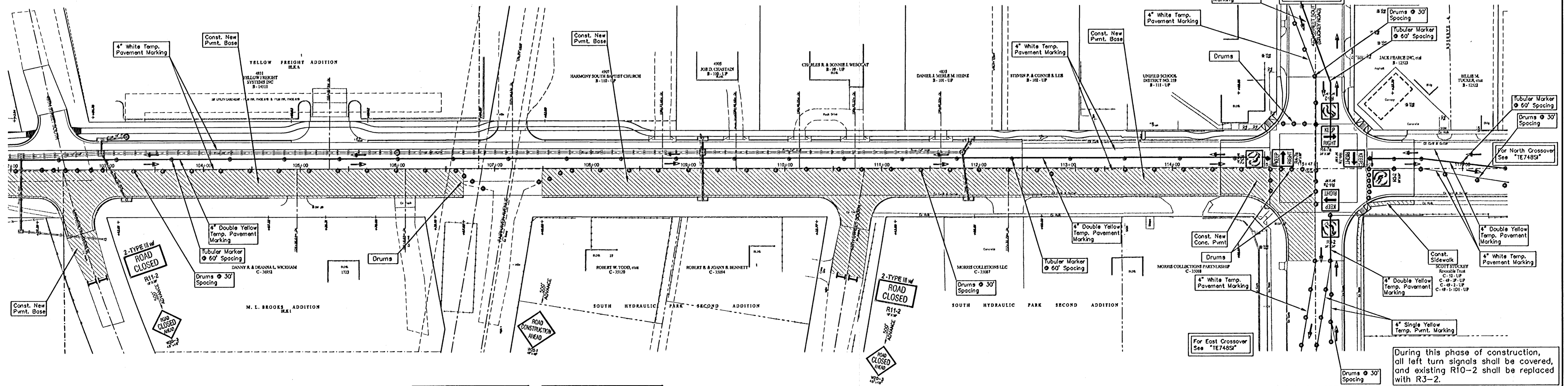

Contractor shall either maintain or temporarily relocate all street name signs within project limits at all times during construction.

Contractor shall maintain access to all businesses and residences during construction.

Contractor shall maintain all drainage ways during construction.

During this phase of construction, all left turn signals shall be covered, and existing R10-2 shall be replaced with R3-2.

| | | | | | | | | | |
|-----------------------------|----------------|------------------------|------------------|---|---------------------------|---|--|---|---------------------------|
| PROJECT NUMBER 472 83902 | | SHEET NAME Conseq14 | | ENGINEERING DIRECTORY P.Eng/Hydraulic_ph2/Conseq | | STREET & SWS IMPROVEMENTS Construction Sequencing Plan Phs VI HYDRAULIC AVE PAVING - SOUTH OF 57th STREET SOUTH TO 47th STREET SOUTH | | BAUGHMAN COMPANY, P.A. ENGINEERING, SURVEYING, & PLANNING 316-282-7271 • 315 ELLIS • WICHITA, KANSAS 67211 | SHEET 102 OF 143 |
| DESIGN Azire | DRAWN Staff | APPROVED JFB | DATE March 04 | SCALE 1"=50' | BAUGHMAN NO 99-09-E451 | | | | |