

BENCHMARKS:
 BM #1: C.O.W. benchmark disk.
 56' E and 55' N of CL 135th
 St. W. & 13th St. N.
 Elev. = 167.83 (City Datum)

BM #2: 60D nail in HLP, 800'
 W & 31' N of the NE cor.,
 NW1/4, Sec. 13, T-27-S,
 R-2-W.
 Elev. = 162.68 (City Datum)

P.V.I.
 Elev. = 160.70
 121.34' V.C.

Scale: 1" = 20'
 • = Iron

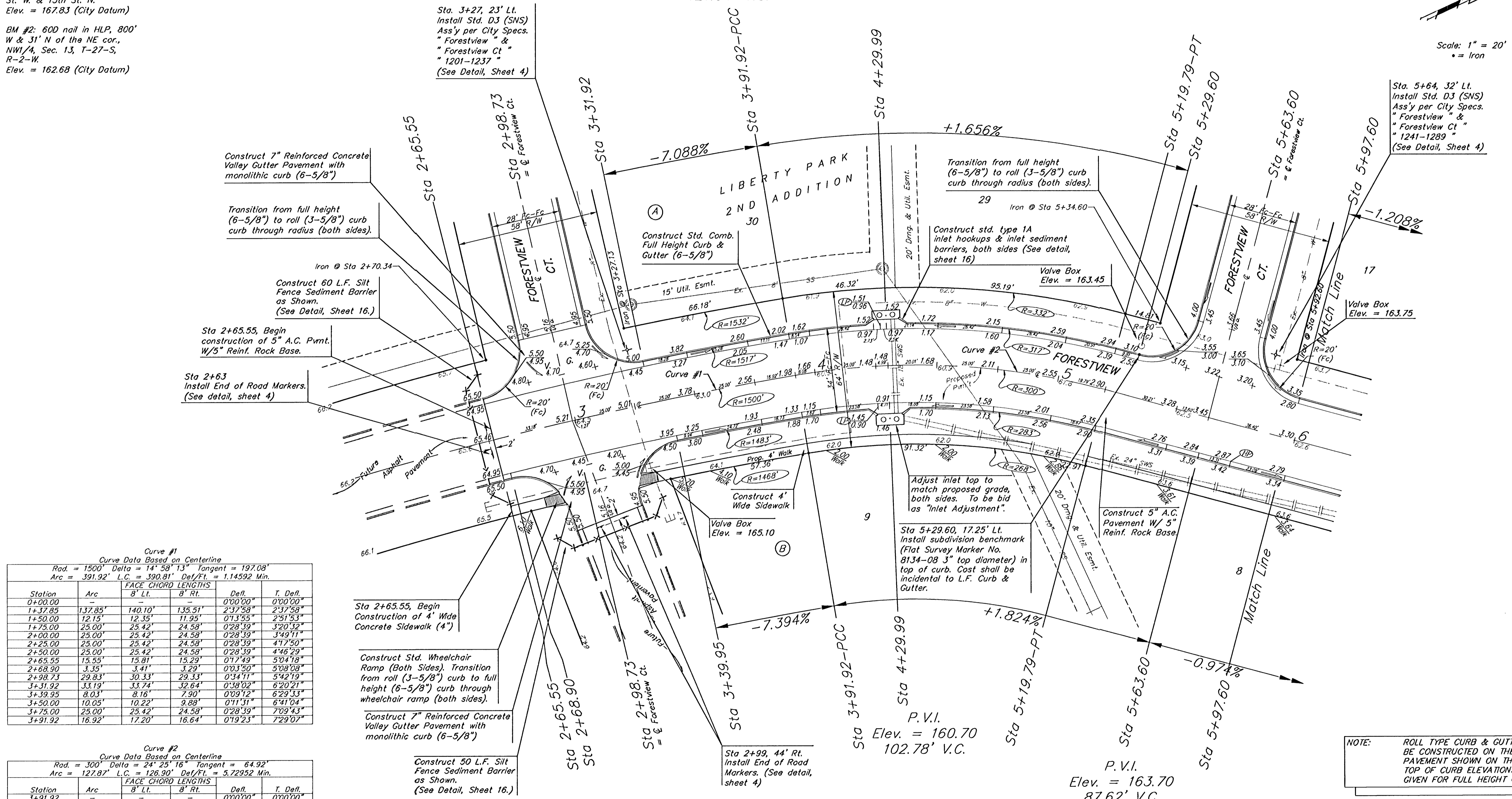

Curve #1
 Curve Data Based on Centerline

Rad. = 1500' Delta = 14° 58' 13" Tangent = 197.08'
 Arc = 391.92' L.C. = 390.81' Del/Ft. = 1.14592 Min.

| Station | Arc | FACE CHORD LENGTHS | | Defl. | T. Defl. |
|---------|---------|--------------------|---------|----------|----------|
| | | 8' Lt. | 8' Rt. | | |
| 0+00.00 | - | - | - | 0'00"00" | 0'00"00" |
| 1+37.85 | 137.85' | 140.10' | 135.51' | 2'37"58" | 2'37"58" |
| 1+50.00 | 12.15' | 12.35' | 11.95' | 0'13"55" | 2'51"53" |
| 1+75.00 | 25.00' | 25.42' | 24.58' | 0'28"39" | 3'20"32" |
| 2+00.00 | 25.00' | 25.42' | 24.58' | 0'28"39" | 3'49"11" |
| 2+25.00 | 25.00' | 25.42' | 24.58' | 0'28"39" | 4'17"50" |
| 2+50.00 | 25.00' | 25.42' | 24.58' | 0'28"39" | 4'46"29" |
| 2+65.55 | 15.55' | 15.81' | 15.29' | 0'17"49" | 5'04"18" |
| 2+68.90 | 3.35' | 3.41' | 3.29' | 0'03"50" | 5'08"08" |
| 2+98.73 | 29.83' | 30.33' | 29.33' | 0'34"11" | 5'42"19" |
| 3+31.92 | 33.19' | 33.74' | 32.64' | 0'38"02" | 6'20"21" |
| 3+39.95 | 8.03' | 8.16' | 7.90' | 0'09"12" | 6'29"33" |
| 3+50.00 | 10.05' | 10.22' | 9.88' | 0'11"31" | 6'41"04" |
| 3+75.00 | 25.00' | 25.42' | 24.58' | 0'28"39" | 7'09"43" |
| 3+91.92 | 16.92' | 17.20' | 16.64' | 0'19"23" | 7'29"07" |

Curve #2
 Curve Data Based on Centerline

Rad. = 300' Delta = 24° 25' 16" Tangent = 64.92'
 Arc = 127.87' L.C. = 126.90' Del/Ft. = 5.72952 Min.

| Station | Arc | FACE CHORD LENGTHS | | Defl. | T. Defl. |
|---------|--------|--------------------|--------|----------|-----------|
| | | 8' Lt. | 8' Rt. | | |
| 3+91.92 | - | - | - | 0'00"00" | 0'00"00" |
| 4+00.00 | 8.08' | 8.75' | 7.41' | 0'46"17" | 0'46"17" |
| 4+25.00 | 25.00' | 27.08' | 22.91' | 2'23"14" | 3'09"32" |
| 4+50.00 | 25.00' | 27.08' | 22.91' | 2'23"14" | 5'32"46" |
| 4+75.00 | 25.00' | 27.08' | 22.91' | 2'23"14" | 7'56"00" |
| 5+00.00 | 25.00' | 27.08' | 22.91' | 2'23"14" | 10'19"15" |
| 5+19.79 | 19.79' | 21.44' | 18.14' | 1'53"23" | 12'12"38" |

NOTE: ROLL TYPE CURB & GUTTER TO BE CONSTRUCTED ON THE PAVEMENT SHOWN ON THIS SHEET. TOP OF CURB ELEVATIONS ARE GIVEN FOR FULL HEIGHT CURB.

LIBERTY PARK 2ND ADDITION - PHASE I
FORESTVIEW
 Sta 3+39.95 to Sta 5+97.60

BAUGHMAN COMPANY P.A.
 ENGINEERING, SURVEYING, & PLANNING
 316-202-7271 • 315 ELLIS • WICHITA, KANSAS 67211

PROJECT NUMBER: _____ SHEET: **7** OF **27**

DESIGN: NBW DRAWN: TMS APPROVED: _____ DATE: 4/30/03 SCALE: Noted