

BENCHMARKS:
 BM #1: C.O.W. benchmark disk
 56' E and 55' N of CL 135th
 St. W. & 13th St. N.
 Elev. = 167.83 (City Datum)

BM #2: 600 nail in HLP, 800'
 W & 31' N of the NE cor.,
 NW1/4, Sec. 13, T-27-S,
 R-2-W.
 Elev. = 162.68 (City Datum)

Curve #3
 Curve Data Based on Centerline
 Rad. = 350' Delta = 39° 56' 27" Tangent = 127.18'
 Arc = 243.98' L.C. = 239.07' Del/Ft. = 4.91116 Min.

Station	Arc	FACE CHORD LENGTHS		Defl.	T. Defl.
		8' Lt.	8' Rt.		
8+28.36	-	-	-	0°00'00"	0°00'00"
8+44.36	16.00'	17.14'	14.86'	1°18'35"	1°18'35"
9+10.81	66.45'	71.09'	61.61'	5°26'21"	6°44'55"
9+48.91	38.10'	40.80'	35.36'	3°07'07"	9°52'02"
9+50.00	1.09'	1.17'	1.01'	0°05'21"	9°57'23"
9+75.00	25.00'	26.78'	23.21'	2°02'47"	12°00'10"
10+00.00	25.00'	26.78'	23.21'	2°02'47"	14°02'57"
10+25.00	25.00'	26.78'	23.21'	2°02'47"	16°05'44"
10+50.00	25.00'	26.78'	23.21'	2°02'47"	18°08'30"
10+72.34	22.34'	23.93'	20.74'	1°49'43"	19°58'13"

Scale: 1" = 20'
 • = Iron

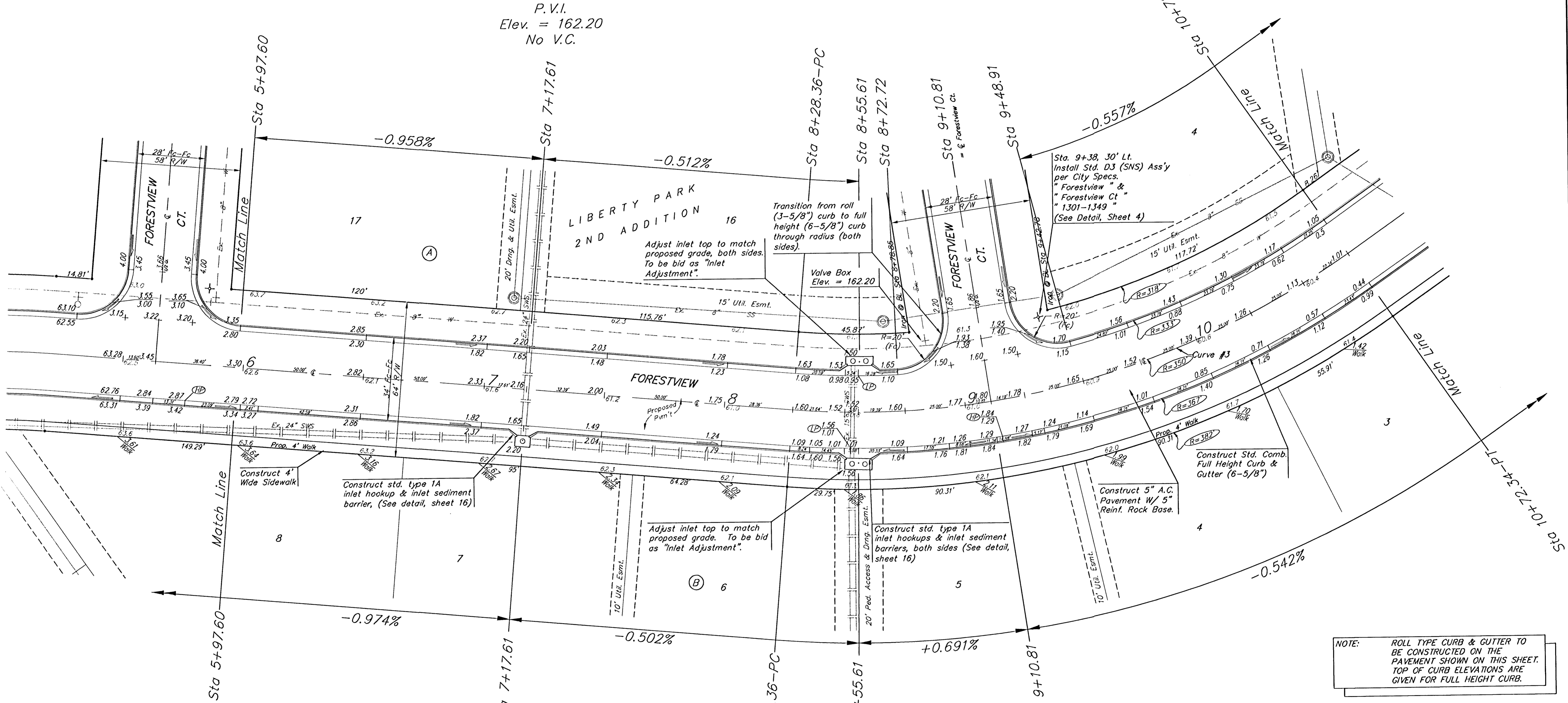

P.V.I.
 Elev. = 162.20
 No V.C.

P.V.I.
 Elev. = 162.20
 No V.C.

P.V.I.
 Elev. = 161.50
 40.66' V.C.

P.V.I.
 Elev. = 161.90
 40' V.C.

NOTE: ROLL TYPE CURB & GUTTER TO BE CONSTRUCTED ON THE PAVEMENT SHOWN ON THIS SHEET. TOP OF CURB ELEVATIONS ARE GIVEN FOR FULL HEIGHT CURB.

LIBERTY PARK 2ND ADDITION - PHASE I
FORESTVIEW
 Sta 8+97.60 to Sta 10+72.34

BAUGHMAN COMPANY P.A.
 ENGINEERING, SURVEYING, & PLANNING
 316-262-7271 • 315 ELLIS • WICHITA, KANSAS 67211

PROJECT NUMBER: _____ SHEET: **8** OF **27**

DESIGN: NBW DRAWN: TMS APPROVED: _____ DATE: 4/30/03 SCALE: Noted

LibertyPark 2nd 02-10-E623