

BENCHMARKS:
 BM #1: C.O.W. benchmark disk
 56' E and 55' N of CL 135th
 St. W. & 13th St. N.
 Elev. = 167.83 (City Datum)

BM #2: 60D nail in HLP, 800'
 W & 31' N of the NE cor.,
 NW1/4, Sec. 13, T-27-S,
 R-2-W.
 Elev. = 162.68 (City Datum)

Curve #4
 Curve Data Based on Centerline
 Rad. = 250' Delta = 6° 39' 16" Tangent = 14.53'
 Arc = 29.04' L.C. = 29.02' Def/Ft. = 6.87443 Min.

Station	Arc	FACE CHORD LENGTHS		Defl.	T. Defl.
		8' Lt.	8' Rt.		
0+00.00	-	-	-	0'00'00"	0'00'00"
0+29.04	29.04'	28.09'	-	3'19'38"	3'19'38"

Curve #6
 Curve Data Based on Centerline
 Rad. = 250' Delta = 6° 39' 16" Tangent = 14.53'
 Arc = 29.04' L.C. = 29.02' Def/Ft. = 6.87443 Min.

Station	Arc	FACE CHORD LENGTHS		Defl.	T. Defl.
		8' Lt.	8' Rt.		
0+00.00	-	-	-	0'00'00"	0'00'00"
0+29.04	29.04'	29.95'	-	3'19'38"	3'19'38"

Curve #5
 Curve Data Based on Centerline
 Rad. = 250' Delta = 6° 39' 16" Tangent = 14.53'
 Arc = 29.04' L.C. = 29.02' Def/Ft. = 6.87443 Min.

Station	Arc	FACE CHORD LENGTHS		Defl.	T. Defl.
		8' Lt.	8' Rt.		
0+00.00	-	-	-	0'00'00"	0'00'00"
0+29.04	29.04'	28.09'	-	3'19'38"	3'19'38"

Curve #7
 Curve Data Based on Centerline
 Rad. = 250' Delta = 6° 39' 16" Tangent = 14.53'
 Arc = 29.04' L.C. = 29.02' Def/Ft. = 6.87443 Min.

Station	Arc	FACE CHORD LENGTHS		Defl.	T. Defl.
		8' Lt.	8' Rt.		
0+00.00	-	-	-	0'00'00"	0'00'00"
0+29.04	29.04'	29.95'	-	3'19'38"	3'19'38"

P.V.I.
 Elev. = 169.00
 25.34' V.C.

Scale: 1" = 20'
 • = Iron

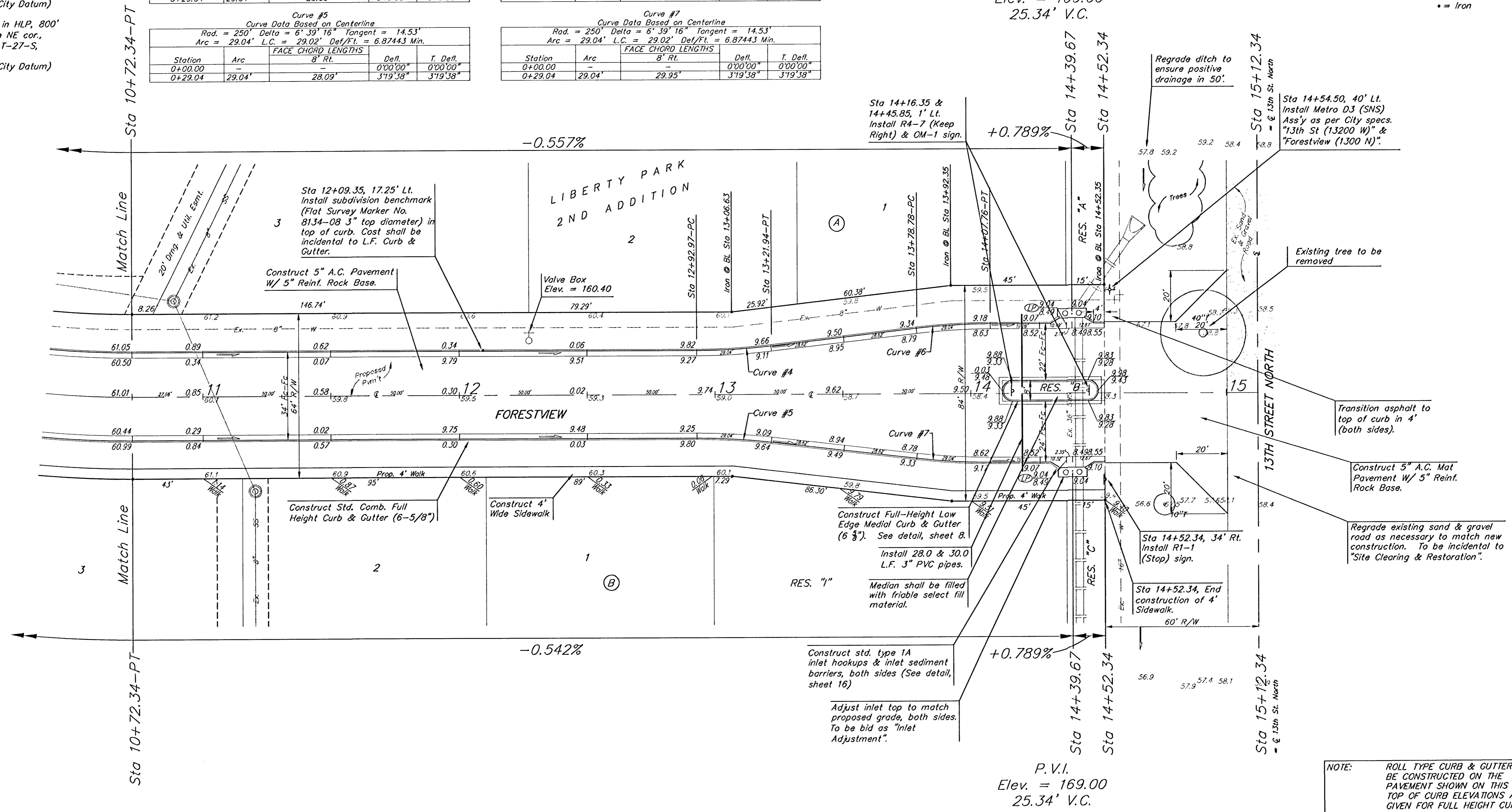

NOTE: ROLL TYPE CURB & GUTTER TO BE CONSTRUCTED ON THE PAVEMENT SHOWN ON THIS SHEET. TOP OF CURB ELEVATIONS ARE GIVEN FOR FULL HEIGHT CURB.

LIBERTY PARK 2ND ADDITION - PHASE I
FORESTVIEW
 Sta 10+72.34 to Sta 15+12.34

BAUGHMAN COMPANY P.A.
 ENGINEERING, SURVEYING, & PLANNING
 316-282-7271 • 312 ELLIS • WICHITA, KANSAS 67211

PROJECT NUMBER: _____ SHEET: **9**

DESIGN: NGW DRAWN: TMS APPROVED: _____ DATE: 4/30/03 SCALE: Noted

LibertyPark/Src3 02-10-E423