

SUBDIVISION BENCH MARKS				
NO.	STREET AND STATION	FROM CL	DESCRIPTION	ELEVATIONS
6	ZIMMERLY ST., STA. 19+75.11	17.5' RT	TOP OF CURB AT END OF RETURN, ZIMMERLY ST.	

NOTE: CONTRACTOR SHALL INSTALL SUBDIVISION BENCH MARKS ("FLAT SURVEY MARKERS NO. 8134-08 3" TOP DIAMETER" PROVIDED BY KANSAS BLUE PRINT CO., INC.) COSTS TO BE CONSIDERED SUBSIDIARY TO CONSTRUCTION OF COMBINED CURB AND GUTTER.

WOODLAND LAKES ESTATES
THIRD ADDITION

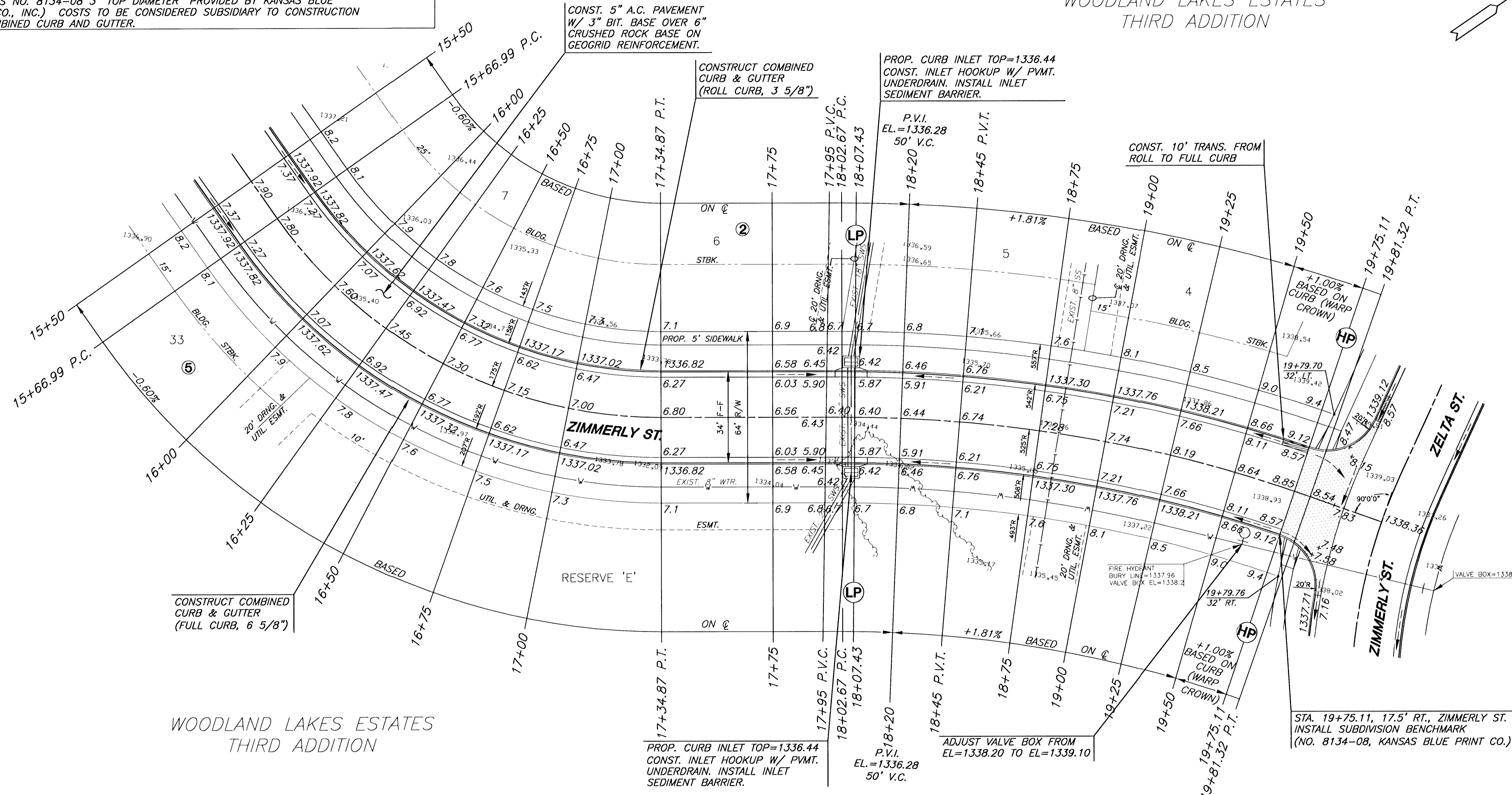
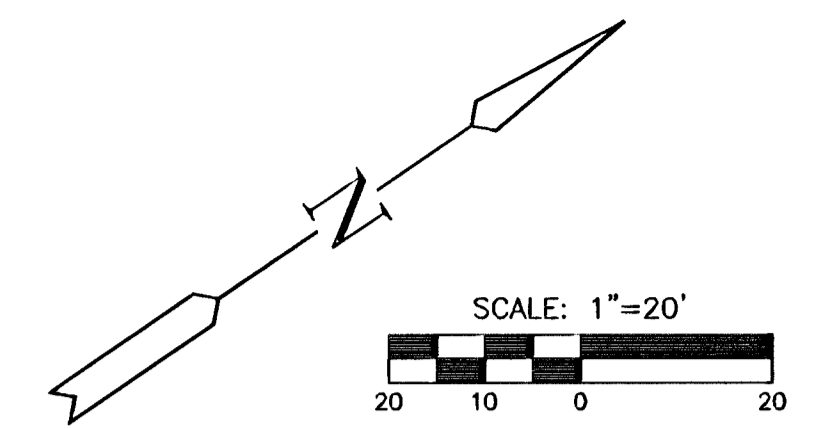

WOODLAND LAKES ESTATES
THIRD ADDITION

CURVE TABLE					
$\Delta = 54^{\circ}57'40''$ R = 175.00' T = 91.02' L = 167.87' LC = 161.51'					
CURVE DATA BASED ON CENTERLINE $\Delta / 2 = 27^{\circ}28'50''$					
STATION	ARC	CHORD LENGTH		DEFLECTION	TOTAL DEFLECTION
		' Off Ltcb	' Off Rtcb		
15+66.99	-	-	-	00°00'00"	00°00'00"
15+75.00	8.01'	7.23'	8.79'	01°18'41"	01°18'41"
16+00.00	25.00'	22.55'	27.41'	04°05'33"	05°24'14"
16+25.00	25.00'	22.55'	27.41'	04°05'33"	09°29'47"
16+50.00	25.00'	22.55'	27.41'	04°05'33"	13°35'20"
16+75.00	25.00'	22.55'	27.41'	04°05'33"	17°40'53"
17+00.00	25.00'	22.55'	27.41'	04°05'33"	21°46'27"
17+25.00	25.00'	22.55'	27.41'	04°05'33"	25°52'00"
17+34.86	9.86'	8.90'	10.82'	01°36'50"	27°28'50"

Def/Ft = 9.82213 Min.

CURVE TABLE					
$\Delta = 19^{\circ}29'49''$ R = 525.00' T = 90.20' L = 178.65' LC = 177.79'					
CURVE DATA BASED ON CENTERLINE $\Delta / 2 = 09^{\circ}44'55''$					
STATION	ARC	CHORD LENGTH		DEFLECTION	TOTAL DEFLECTION
		' Off Ltcb	' Off Rtcb		
18+02.67	-	-	-	00°00'00"	00°00'00"
18+25.00	22.33'	23.05'	21.61'	01°13'07"	01°13'07"
18+50.00	25.00'	25.81'	24.19'	01°21'51"	02°34'58"
18+75.00	25.00'	25.81'	24.19'	01°21'51"	03°56'49"
19+00.00	25.00'	25.81'	24.19'	01°21'51"	05°18'40"
19+25.00	25.00'	25.81'	24.19'	01°21'51"	06°40'31"
19+50.00	25.00'	25.81'	24.19'	01°21'51"	08°02'22"
19+75.00	25.00'	25.81'	24.19'	01°21'51"	09°24'13"
19+81.32	6.32'	6.52'	6.12'	00°20'42"	09°44'55"

Def/Ft = 3.27404 Min.

NOTES:
1. TOP OF CURB ELEVATIONS SHOWN ARE FOR FULL CURB.
2. CONTRACTOR SHALL REMOVE ALL TREES WITHIN ROAD R/W.

LEGEND
+ STREET SIGN & SIGN LOCATION (SEE SIGN ASSEMBLY TABLE FOR TYPE & STATION OF SIGN)

MKEC
ENGINEERING CONSULTANTS
411 N. WEBB ROAD
WICHITA, KS. 67204
316-684-9600

**WOODLAND LAKES THIRD ADDITION
ZELTA PHASE**
PROJECT NAME

PAVING PLANS - ZIMMERLY STREET
SHEET TITLE

DFL	JAS	ASH
DESIGN BY:	DRAWN BY:	CHECKED BY:
JULY 2003	02172E10	17 / 42
DATE	JOB NO.	SHEET OF