

SUBDIVISION BENCH MARKS				
NO.	STREET AND STATION	FROM CL	DESCRIPTION	ELEVATIONS
7	ZIMMERLY CT., STA. 13+69.73	14.5' RT.	TOP OF CURB AT ZIMMERLY CT.	

NOTE: CONTRACTOR SHALL INSTALL SUBDIVISION BENCH MARKS ("FLAT SURVEY MARKERS NO. 8134-08 3" TOP DIAMETER" PROVIDED BY KANSAS BLUE PRINT CO., INC.) COSTS TO BE CONSIDERED SUBSIDIARY TO CONSTRUCTION OF COMBINED CURB AND GUTTER.

WOODLAND LAKES ESTATES
THIRD ADDITION

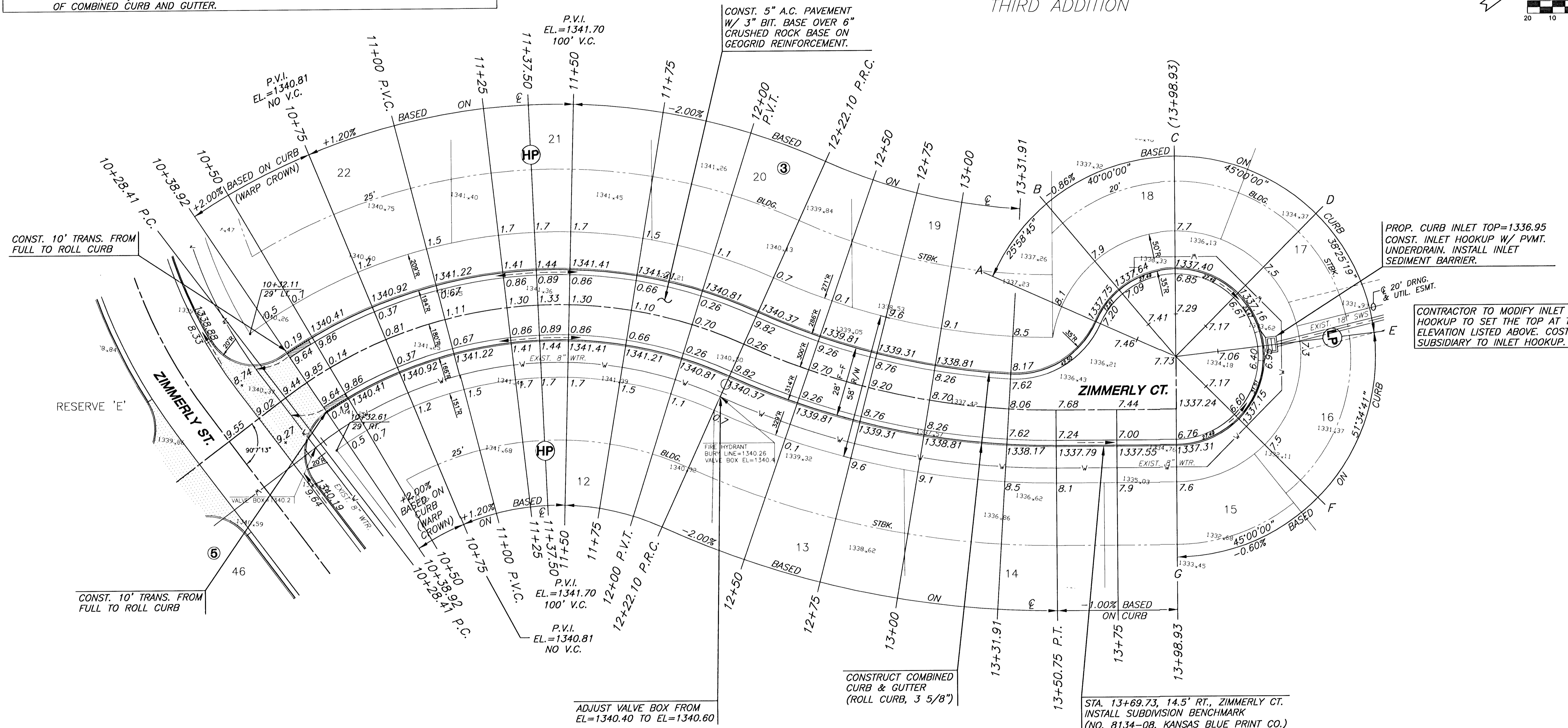
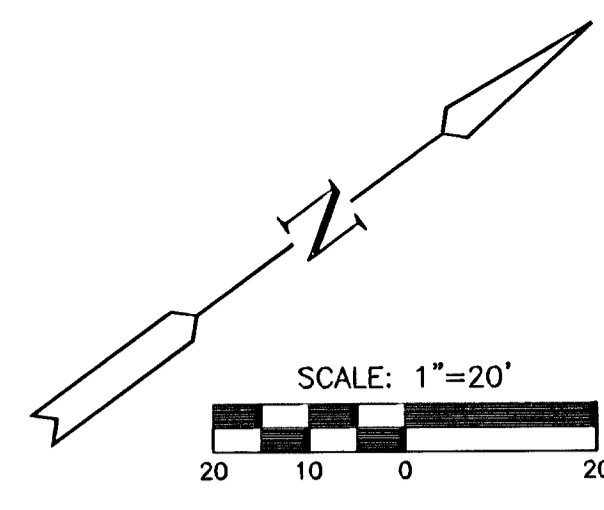

CURVE TABLE					
$\Delta = 61^{\circ}39'14''$ R = 180.00' T = 107.42' L = 193.69' LC = 184.48'					
CURVE DATA BASED ON CENTERLINE $\Delta / 2 = 30^{\circ}49'37''$					
STATION	ARC	CHORD LENGTH		TOTAL DEFLECTION	
		' Off LtCb	' Off RtCb	DEFLECTION	DEFLECTION
10+28.41	-	-	-	00°00'00"	00°00'00"
10+50.00	21.59'	23.26'	19.90'	03°26'10"	03°26'10"
10+75.00	25.00'	26.92'	23.04'	03°58'44"	07°24'54"
11+00.00	25.00'	26.92'	23.04'	03°58'44"	11°23'38"
11+25.00	25.00'	26.92'	23.04'	03°58'44"	15°22'22"
11+50.00	25.00'	26.92'	23.04'	03°58'44"	19°21'06"
11+75.00	25.00'	26.92'	23.04'	03°58'44"	23°19'50"
12+00.00	25.00'	26.92'	23.04'	03°58'44"	27°18'34"
12+22.10	22.10'	23.81'	20.37'	03°31'03"	30°49'37"

Def/Ft = 9.54930 Min.

CURVE TABLE					
$\Delta = 24^{\circ}34'07''$ R = 300.00' T = 65.32' L = 128.64' LC = 127.66'					
CURVE DATA BASED ON CENTERLINE $\Delta / 2 = 12^{\circ}17'03''$					
STATION	ARC	CHORD LENGTH		TOTAL DEFLECTION	
		' Off LtCb	' Off RtCb	DEFLECTION	DEFLECTION
12+22.10	-	-	-	00°00'00"	00°00'00"
12+50.00	27.90'	26.59'	29.19'	02°39'51"	02°39'51"
12+75.00	25.00'	23.83'	26.16'	02°23'14"	05°03'06"
13+00.00	25.00'	23.83'	26.16'	02°23'14"	07°26'20"
13+25.00	25.00'	23.83'	26.16'	02°23'14"	09°49'34"
13+50.00	25.00'	23.83'	26.16'	02°23'14"	12°12'49"
13+50.74	.74'	.71'	.78'	00°04'15"	12°17'03"

Def/Ft = 5.72958 Min.

WOODLAND LAKES ESTATES
THIRD ADDITION

- NOTES:
- TOP OF CURB ELEVATIONS SHOWN ARE FOR FULL CURB.
 - CONTRACTOR SHALL REMOVE ALL TREES WITHIN ROAD R/W.
- LEGEND
- + STREET SIGN & SIGN LOCATION (SEE SIGN ASSEMBLY TABLE FOR TYPE & STATION OF SIGN)

MKEC
ENGINEERING CONSULTANTS
411 N. WEBB ROAD
WICHITA, KS. 67206
316-284-9600

WOODLAND LAKES THIRD ADDITION
ZETA PHASE
PROJECT NAME

PAVING PLANS - ZIMMERLY COURT
SHEET TITLE

DFL	JAS	ASH
DESIGN BY:	DRAWN BY:	CHECKED BY:
JULY 2003	02172E11	18 / 42
DATE	JOB NO.	SHEET/OF