

BENCHMARKS:
 BM #1: COW BM at the SW corner of Pawnee Ave. and Maize Road.
 Elev. = 135.15 (City Datum)

BM #2: "□" in top of curb on the north side of Yosemite, 65' east of Maize Road.
 Elev. = 143.67 (City Datum)

BM #3: COW BM at Shefford on the south side of Pawnee Ave.
 Elev. = 145.53 (City Datum)

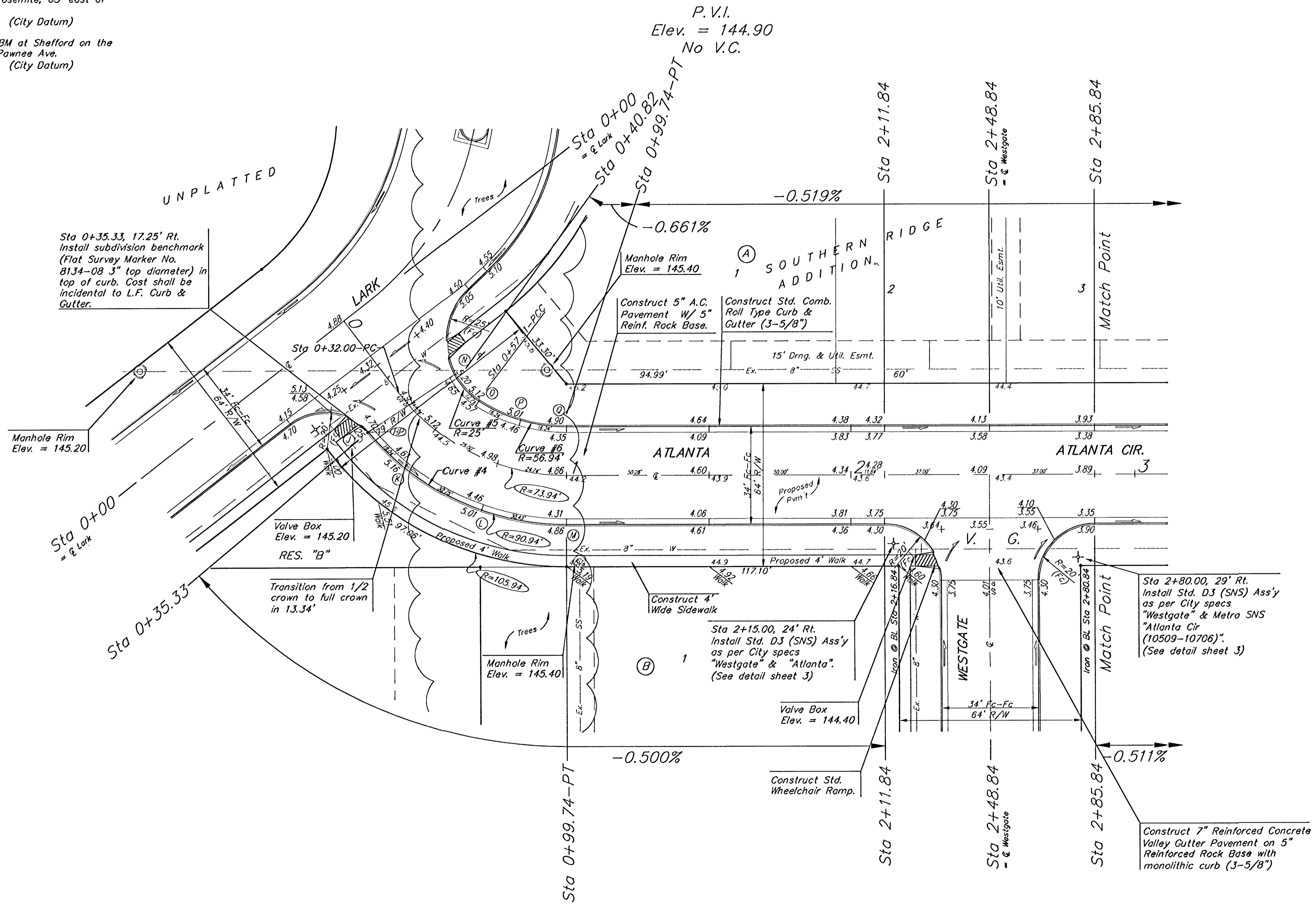
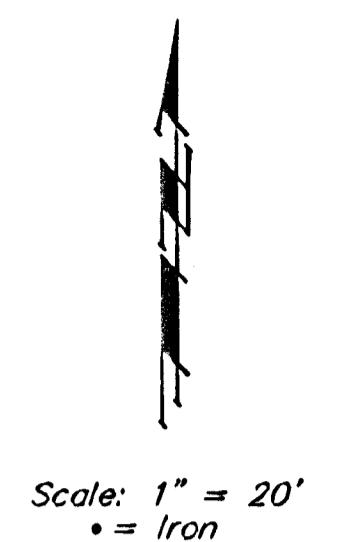

Curve #4
 Curve Data Based on Centerline
 Rad. = 90.94', Delta = 49° 54' 39", Tangent = 42.32'
 Arc = 79.22' L.C. = 76.74' Def/Ft. = 18.90085 Min.

Station	Arc	FACE CHORD LENGTHS	Defl.	T. Defl.
J	-	8' Rt.	0'00'00"	0'00'00"
K	18.04'	19.59'	5'40'58"	5'40'58"
L	30.75'	33.30'	9'41'12"	15'22'10"
M	30.43'	32.95'	9'35'09"	24'57'19"

Curve #5
 Curve Data Based on Face of Curb
 Rad. = 25' Delta = 29° 11' 43" Tangent = 6.51'
 Arc = 12.74' L.C. = 12.60' Def/Ft. = 68.74870 Min.

Station	Arc	FACE CHORD LENGTHS	Defl.	T. Defl.
N	-	8' Lt.	0'00'00"	0'00'00"
O	12.74'	16.58'	29'11'43"	29'11'43"

Curve #6
 Curve Data Based on Face of Curb
 Rad. = 56.94' Delta = 32° 52' 47" Tangent = 16.80'
 Arc = 32.68' L.C. = 32.23' Def/Ft. = 30.18335 Min.

Station	Arc	FACE CHORD LENGTHS	Defl.	T. Defl.
P	-	8' Lt.	0'00'00"	0'00'00"
Q	16.34'	13.99'	8'13'11"	16'26'24"
R	16.34'	13.99'	8'13'12"	16'26'23"

NOTE: ROLL TYPE CURB & GUTTER TO BE CONSTRUCTED ON THE PAVEMENT SHOWN ON THIS SHEET. TOP OF CURB ELEVATIONS ARE GIVEN FOR FULL HEIGHT CURB.

Remove trees ONLY as necessary for street construction and as approved by Engineer. Cost of removal to be incidental to lump sum bid item "Site Clearing & Restoration".

As Built 3/20/04

SOUTHERN RIDGE ADDITION
ATLANTA
 STA 0+00 TO STA 2+85.84

BAUGHMAN COMPANY P.A.
 ENGINEERING, SURVEYING, & PLANNING
 316-262-7271 • 315 ELLIS • WICHITA, KANSAS 67211

PROJECT NUMBER
472-83881

DESIGN: NBW DRAWN: TMS APPROVED: DATE: 05/03 SCALE: Noted SHEET: **7** OF **48**