

Subdivision Bench Marks

No.	Street and Station	From CL	Description	Elevation
2	Twinlake, Sta. 6+74	17.0' Lt.	East end of Inlet Hookup between Lots 7 & 8 (Block 7)	

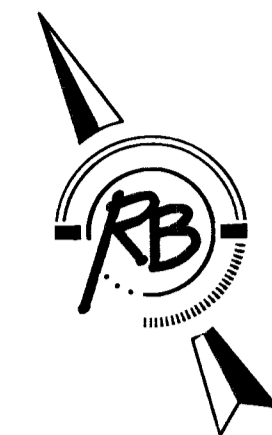

SCALE 1" = 20'  
IRON = •

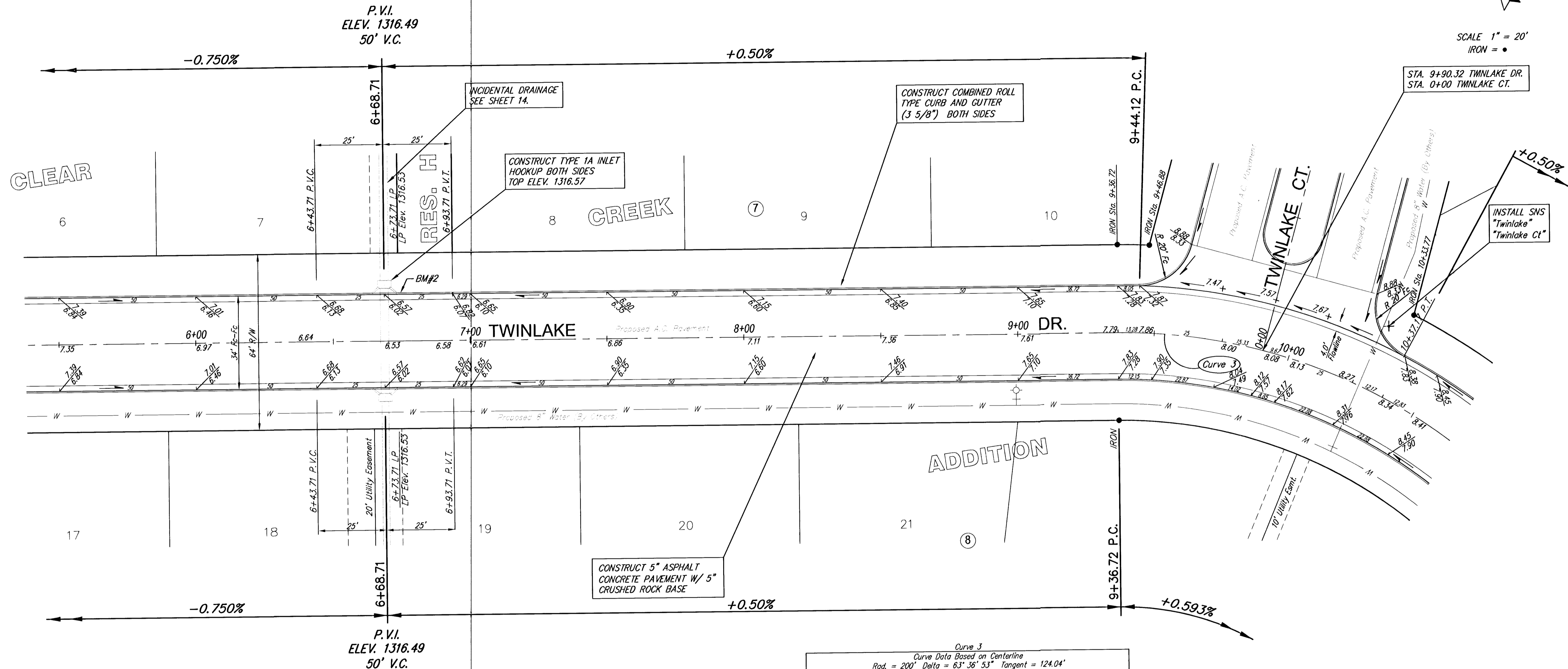

Curve 3  
Curve Data Based on Centerline  
Rad. = 200' Delta = 63° 36' 53" Tangent = 124.04'  
Arc = 222.05' L.C. = 210.83' Def/Fl. = 8.59465 Min.

Station	Arc	FACE CHORD LENGTHS		Defl.	T. Defl.
		B Lt.	B Rt.		
9+36.72	-	-	-	000'00"	000'00"
9+50.00	13.28'	14.94'	11.62'	134'08"	154'08"
9+75.00	25.00'	28.11'	21.86'	334'52"	529'00"
10+00.00	25.00'	28.11'	21.86'	334'52"	903'52"
10+25.00	25.00'	28.11'	21.86'	334'52"	1238'44"
10+50.00	25.00'	28.11'	21.86'	334'52"	1673'36"
10+75.00	25.00'	28.11'	21.86'	334'52"	1948'28"
11+00.00	25.00'	28.11'	21.86'	334'52"	2323'20"
11+25.00	25.00'	28.11'	21.86'	334'52"	2658'12"
11+58.78	33.78'	37.96'	29.52'	450'19"	3148'31"

NOTE: ROLL TYPE CURB AND GUTTER TO BE CONSTRUCTED ALONG PAVEMENT DEPICTED ON THIS SHEET

Clear Creek Addition, Paving Improvements  
Twinlake Drive  
WICHITA, KANSAS

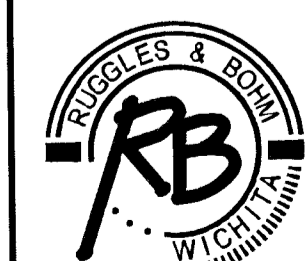

Ruggles & Bohm, P.A.  
Engineering, Surveying, Land Planning  
924 North Main  
Wichita, Kansas 67203  
www.rbkansas.com  
(316) 264-8008  
(316) 264-4621 fax  
E-mail: info@rbkansas.com

DRAWING FILE: paving {TWINLAKE DR (2)}  
PROJECT NUMBER: 472-83743  
DATE: July 29, 2003

DESIGN	KWL	SHEET 6 OF 40
DRAWN	TEB	
REVIEW		
UTILITY		