

Subdivision Bench Marks

No.	Street and Station	From CL	Description	Elevation
6	Laguna, 1+21	17.0' Lt.	P.T. on east side of Laguna.	

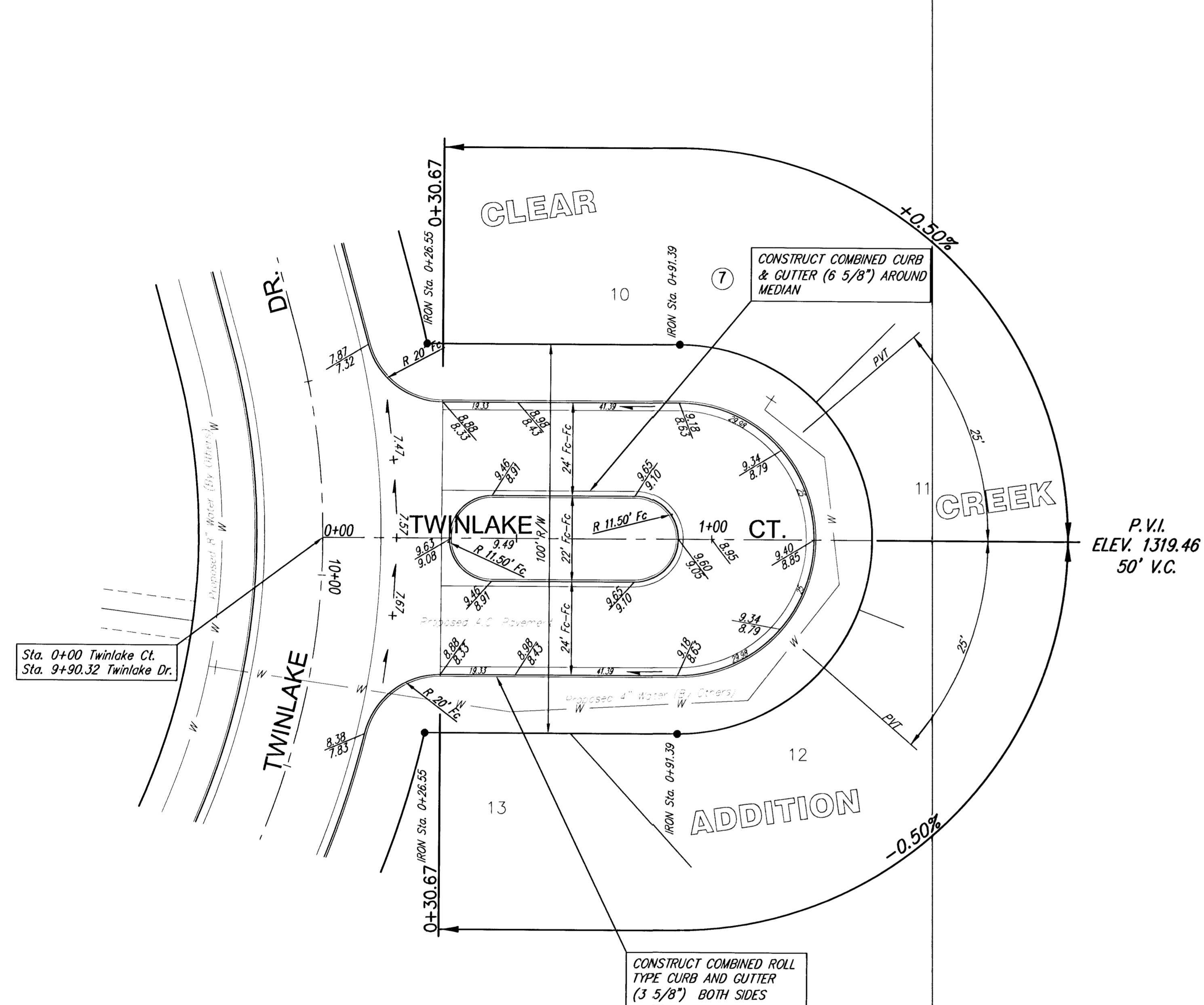

P.V.I.
ELEV. 1319.46
50' V.C.

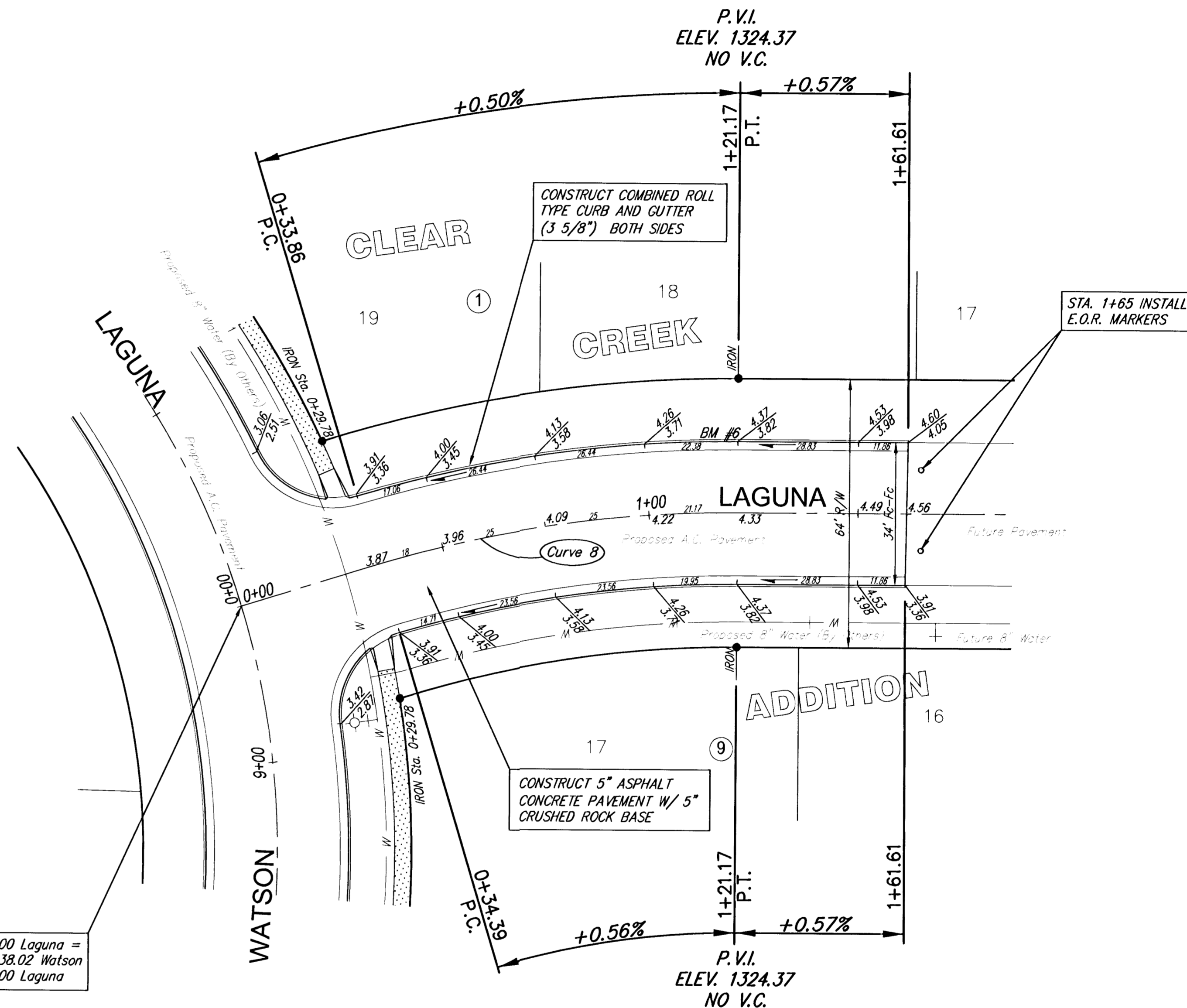

P.V.I.
ELEV. 1324.37
NO V.C.

P.V.I.
ELEV. 1324.37
NO V.C.

Sta. 0+00 Laguna =
Sta. 9+38.02 Watson
Sta. 0+00 Laguna

Curve 8
Curve Data Based on Centerline
Rad. = 295.98' Delta = 17° 15' 38" Tangent = 44.92'
Arc = 89.17' L.C. = 88.83' Def/Fl. = 5.80707 Min.

Station	FACE CHORD LENGTHS			Def.	T. Def.
	8 LL	8 RL	8 CL		
0+32.00	-	-	-	0°00'00"	0°00'00"
0+50.00	18.00'	19.52'	16.48'	1°44'51"	1°44'51"
0+75.00	25.00'	27.10'	22.88'	2°25'10"	4°09'42"
1+00.00	25.00'	27.10'	22.88'	2°25'10"	6°34'53"
1+21.17	21.17'	22.95'	19.38'	2°02'56"	8°37'49"

NOTE: ROLL TYPE CURB AND GUTTER TO BE CONSTRUCTED ALONG PAVEMENT DEPICTED ON THIS SHEET

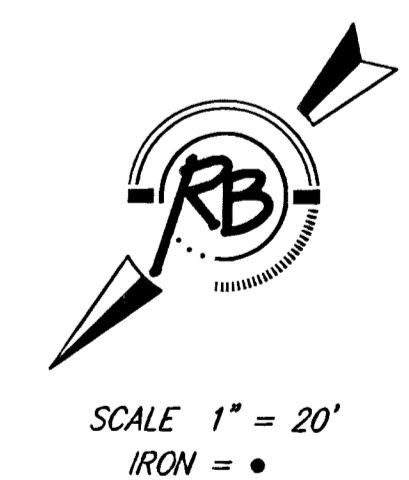
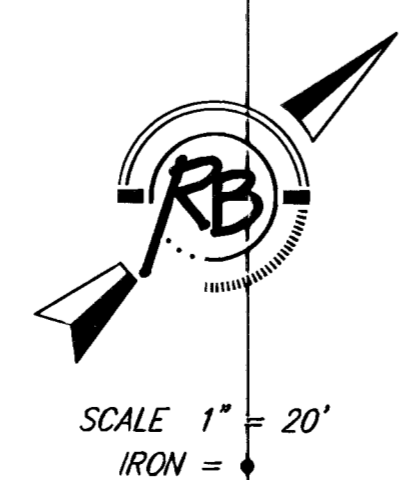

Clear Creek Addition, Paving Improvements
Twinlake Ct. and Laguna (South)
WICHITA, KANSAS

	Ruggles & Bohm, P.A. Engineering, Surveying, Land Planning		DESIGN KWL
	924 North Main Wichita, Kansas 67203 www.rbkansas.com		DRAWN TEB
(316) 264-8008 (316) 264-4021 fax E-mail: info@rbkansas.com		REVIEW TEB	SHEET 11
DRAWING FILE paving {TWINLAKE CT}		PROJECT NUMBER 472-83743	UTILITY DATE July 30, 2003