

Subdivision Bench Marks

No.	Street and Station	From CL	Description	Elevation
4	Watson, 1+34	17.0' Rt.	East End of SE Curb Return in front of Fire Hydrant at intersection of Morris & Watson.	

NOTE:
V-DITCH TO BE INSTALLED
WITH THE STORM WATER DRAIN
PROJECT.

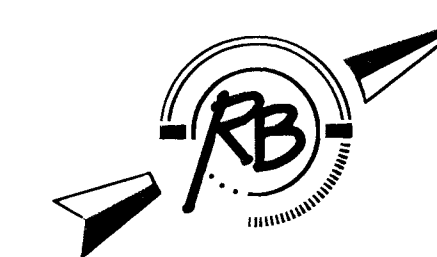
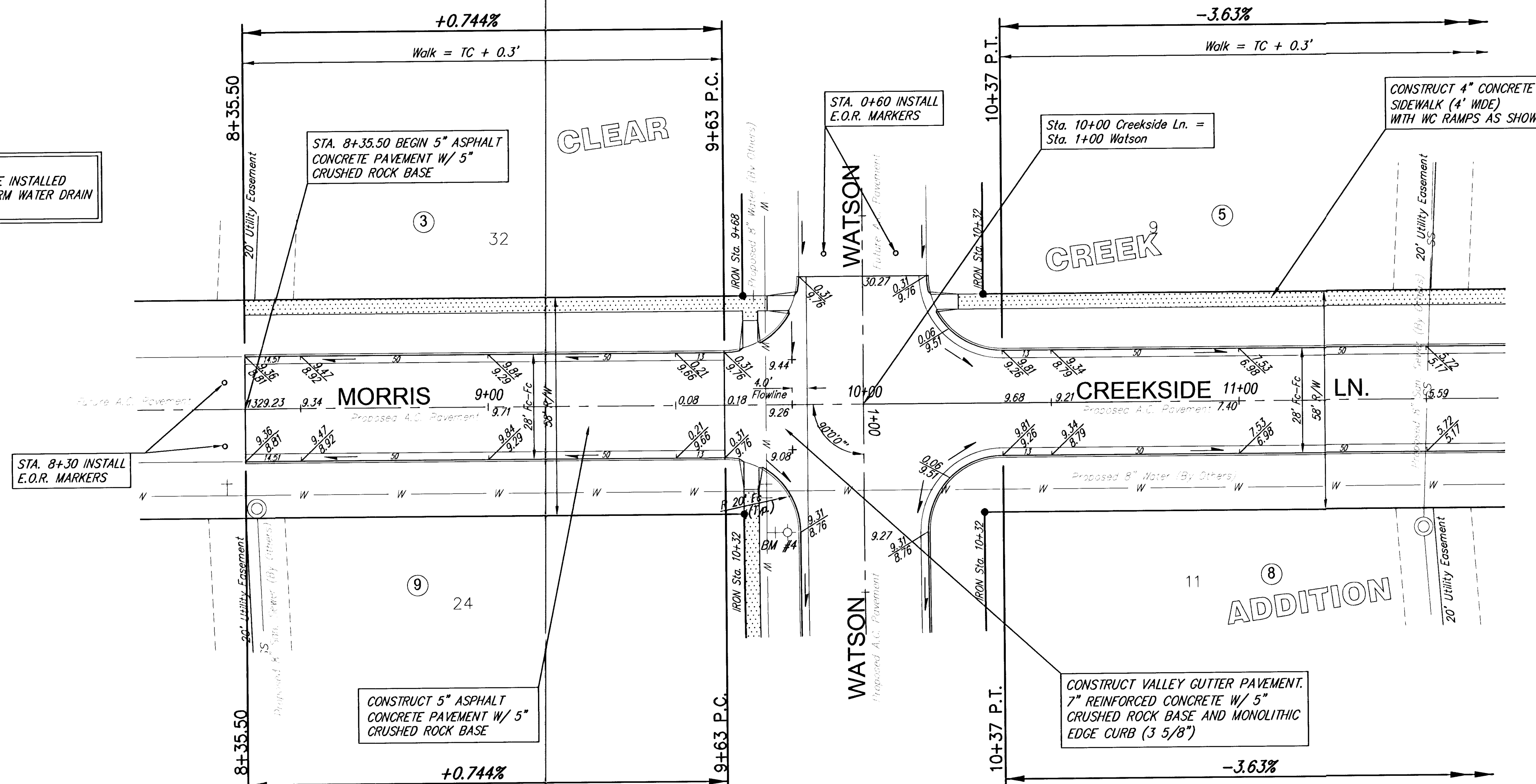

SCALE 1" = 20'
IRON = •

NOTE: ROLL TYPE CURB AND
GUTTER TO BE CONSTRUCTED ALONG
PAVEMENT DEPICTED ON THIS SHEET

Clear Creek Addition, Paving Improvements
Creekside Ln.
WICHITA, KANSAS

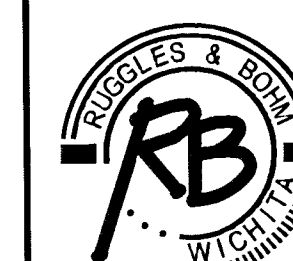

Ruggles & Bohm, P.A.
Engineering, Surveying, Land Planning

924 North Main (316) 264-8008
Wichita, Kansas 67203 (316) 264-4621 fax
www.rbkansas.com E-mail: info@rbkansas.com

DRAWING FILE paving [CREEKSIDE LN] PROJECT NUMBER 472-83743 DATE July 30, 2003

DESIGN	KWL	SHEET 12 OF 40
DRAWN	TEB	
REVIEW		
UTILITY		