

SCALE: 1" = 500'

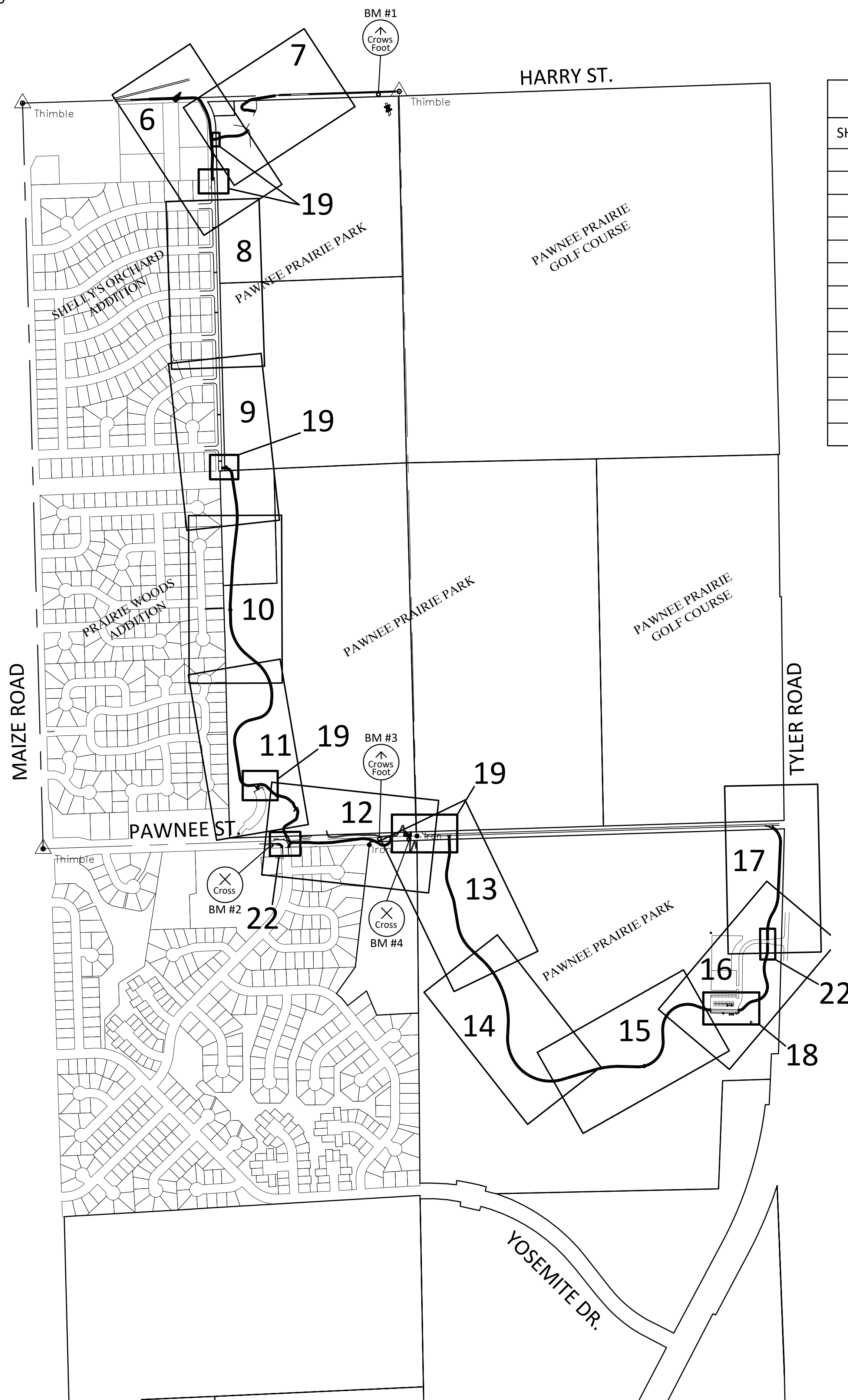

## BIKE PATH QUANTITIES

### BASE BID PAVING

PAVING QUANTITIES PER SHEET			
SHEET NO.	CONCRETE SIDEWALK (5") (REINFORCED)	CRUSHED CONCRETE PATH (4")	DIRT PATH (95% COMPACTION)
6	-	-	-
7	-	-	-
8	-	-	-
9	-	-	-
10	-	-	-
11	561.90 sf	2,808.69 sf	-
12	702.33 sf	10,180.56 sf	-
13	-	9,707.39 sf	-
14	-	11,751.53 sf	-
15	556.47 sf	11,071.31 sf	-
16	-	8,655.00 sf	-
17	-	7,189.19 sf	-
<b>TOTAL:</b>	<b>1,820.70 sf</b>	<b>61,363.67 sf</b>	-

### ALT 1A PAVING

PAVING QUANTITIES PER SHEET			
SHEET NO.	CONCRETE SIDEWALK (5") (REINFORCED)	CRUSHED CONCRETE PATH (4")	DIRT PATH (95% COMPACTION)
6	-	-	-
7	-	-	-
8	-	-	-
9	-	-	4,006.84 sf
10	546.05 sf	-	11,666.41 sf
11	-	-	9,681.49 sf
12	-	-	-
13	-	-	-
14	-	-	-
15	-	-	-
16	-	-	-
17	-	-	-
<b>TOTAL:</b>	<b>546.05 sf</b>	-	<b>25,354.74 sf</b>

### ALT 1B PAVING

PAVING QUANTITIES PER SHEET			
SHEET NO.	CONCRETE SIDEWALK (5") (REINFORCED)	CRUSHED CONCRETE PATH (4")	DIRT PATH (95% COMPACTION)
6	-	-	-
7	-	-	-
8	-	-	-
9	-	4,006.84 sf	-
10	6,102.44 sf	6,108.05 sf	-
11	5,980.07 sf	3,701.42 sf	-
12	-	-	-
13	-	-	-
14	-	-	-
15	-	-	-
16	-	-	-
17	-	-	-
<b>TOTAL:</b>	<b>12,082.51 sf</b>	<b>13,816.31 sf</b>	-

### ALT 2A PAVING

PAVING QUANTITIES PER SHEET			
SHEET NO.	CONCRETE SIDEWALK (5") (REINFORCED)	CRUSHED CONCRETE PATH (4")	DIRT PATH (95% COMPACTION)
6	-	-	10,306.88 sf
7	-	-	4,611.96 sf
8	-	-	-
9	-	-	-
10	-	-	-
11	-	-	-
12	-	-	-
13	-	-	-
14	-	-	-
15	-	-	-
16	-	-	-
17	-	-	-
<b>TOTAL:</b>	-	-	<b>14,918.84 sf</b>

### ALT 2B PAVING

PAVING QUANTITIES PER SHEET			
SHEET NO.	CONCRETE SIDEWALK (5") (REINFORCED)	CRUSHED CONCRETE PATH (4")	DIRT PATH (95% COMPACTION)
6	-	10,306.88 sf	-
7	-	990.23 sf	3,621.73 sf
8	-	-	-
9	-	-	-
10	-	-	-
11	-	-	-
12	-	-	-
13	-	-	-
14	-	-	-
15	-	-	-
16	-	-	-
17	-	-	-
<b>TOTAL:</b>	-	<b>11,297.11 sf</b>	<b>3,621.73 sf</b>

\*See Sheet 23 for Information Regarding Add Alternates for the Project

## CONTROL POINTS

POINT TABLE				
POINT #	RAW DESCRIPTION	NORTHING	EASTING	ELEVATION
1	SW 1/4, SW 1/4, SW 1/4 SEC. 32	1672178.5200	1612865.6260	1325.41
3	NW 1/4, NW 1/4, SW 1/4 SEC. 32	1677416.6600	1612720.9600	1324.62
77	SE 1/4, SW 1/4, SW 1/4 SEC. 32	1672267.8010	1615490.4170	1303.17
78	REBAR	1672206.4050	1615156.1380	1303.57
206	NE 1/4, NW 1/4, SW 1/4 SEC. 32	1677499.3810	1615366.0000	1307.91
220	BM #1 (CFT)	1677468.1130	1615262.5250	1308.31
304	BM #2 (X)	1672210.3450	1614491.1930	1309.83
305	BM #3 (CFT)	1672240.8030	1614874.3830	1309.91
306	BM #4 (X)	1672216.4110	1615465.3790	1300.53

## BENCHMARKS

BM #1 - Chiseled Crowsfoot on a Westar/Electric Manhole, 100' West & 30' South of the Section Corner (Point #204)  
Elev. = 1308.31 (NAVD 88)

BM #2 - Chiseled "X" in the Sidewalk, 75' West of the Centerline of Yellowstone St. and 17' South of the Centerline of Pawnee St.  
Elev. = 1309.83 (NAVD 88)

BM #3 - Chiseled Crowsfoot on a SWS Manhole, 310' East of the Centerline of Yellowstone St. and on the Centerline of Pawnee St.  
Elev. = 1309.91 (NAVD 88)

BM #4 - Chiseled "X" in the Sidewalk, 25' West & 50' South of the Section Corner (Point #77)  
Elev. = 1300.53 (NAVD 88)

