

Match Line - Sheet 8

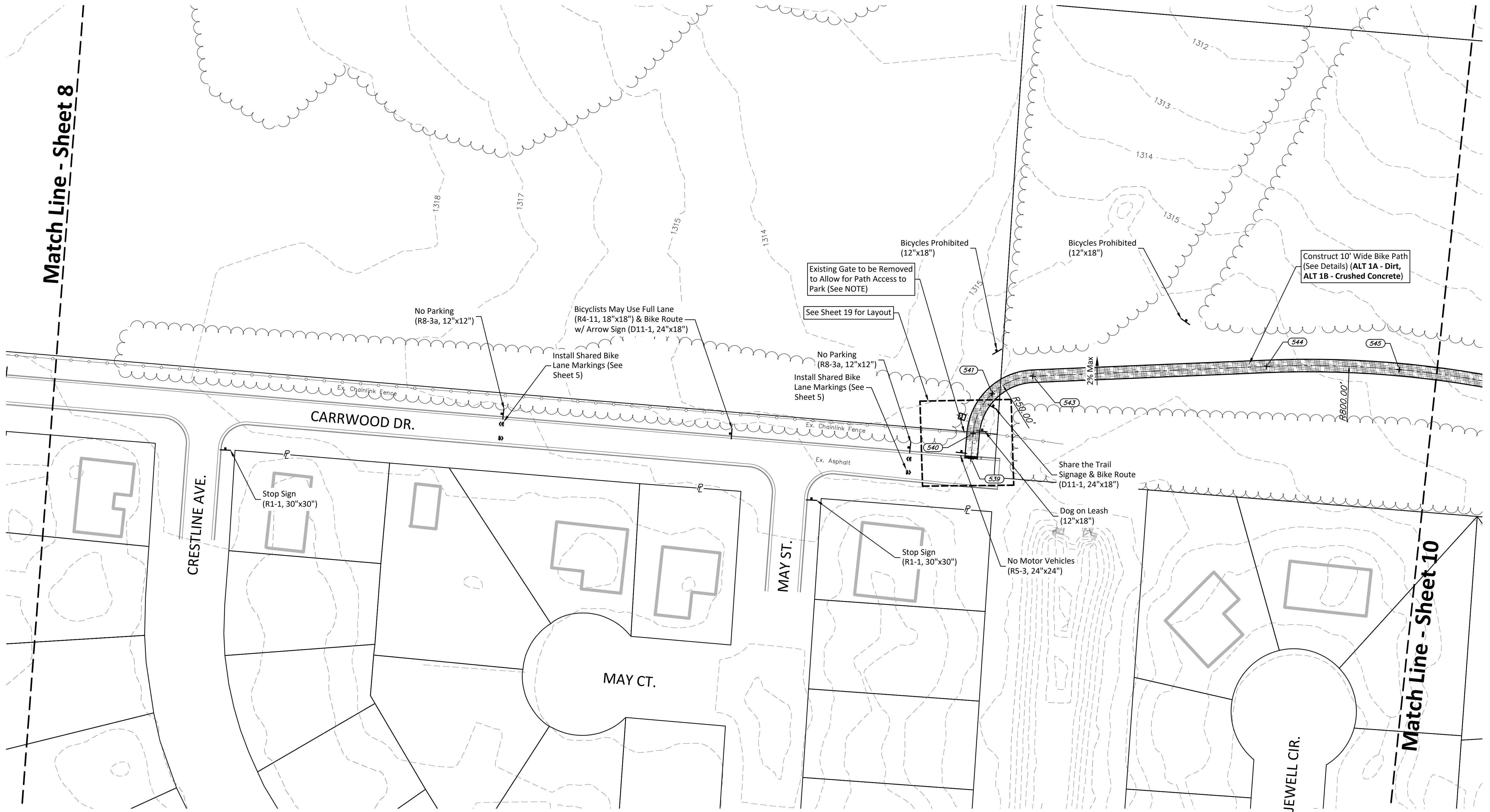
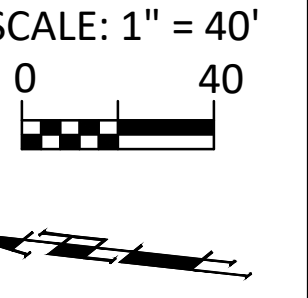

Match Line - Sheet 10

POINT TABLE				
POINT #	RAW DESCRIPTION	NORTHING	EASTING	ELEVATION
539	path	1674853.0571	1614119.8507	1315.08
540	path	1674853.5794	1614140.0611	1315.47
541	path	1674841.9441	1614173.4375	1315.71
543	path	1674811.1446	1614190.7797	1315.95
544	path	1674626.3852	1614218.9964	1316.14
545	path	1674520.8157	1614228.0213	1315.15

NOTE: Crushed Concrete (4") & Concrete Sidewalk Transitions shall have Thickened Edge as Shown in Details (See Sheet 4)

NOTE: Contractor to Supply Chainlink End Posts and All Other Materials Necessary for Gate Removal. Work to be Paid for by Bid Item "Fence Removal"

NOTE: Proposed Path to be Constructed Flush w/ Existing Surface Unless Otherwise Noted on Plans (Flume Grades). Path Cross Slope to Match Existing Runoff Direction as Shown on Plans and at 2% Max.

PAVING QUANTITIES PER SHEET		
BID	PAVEMENT TYPE	QUANTITIES
ALT 1A	Dirt Path (95% Compaction)	4,006.84 sf
ALT 1B	Crushed Concrete Path (4")	4,006.84 sf

R8-3a 12" X 12"

BICYCLES PROHIBITED 12" X 18"

Share the Trail Signage 12" X 18"

NO MOTOR VEHICLES R5-3 24" X 24"

STOP R1-1 30" X 30"

MAY USE FULL LANE R4-11 18" X 18"

M7-2 12" X 9"

BIKE ROUTE D11-1 24" X 18"