

PRIVATE STORM WATER SEWER IMPROVEMENTS

TO SERVE

UNIVERSITY PLACE, LOTS 49, 51, and 53 FRIENDS UNIVERSITY PARKING LOT

PRIVATE PROJECT NO. 1672 PPS (607861)
CITY OF WICHITA, KANSAS
JAMES L. ARMOUR, P.E. - CITY ENGINEER



INDEX OF SHEETS

SHEET NO. 1	TITLE SHEET
SHEET NO. 2	KEY MAP AND GENERAL NOTES
SHEET NO. 3	SWS PLAN AND PROFILE
SHEET NO. 4	AREA INLET DETAILS
SHEET NO. 5	TYPE "P" & "C" SHALLOW MANHOLES
SHEET NO. 6	MANHOLE FRAME & COVER
SHEET NO. 7	EROSION CONTROL BMP
SHEET NO. 8	EROSION CONTROL BMP
SHEET NO. 9	EROSION CONTROL BMP
SHEET NO. 10	EROSION CONTROL BMP

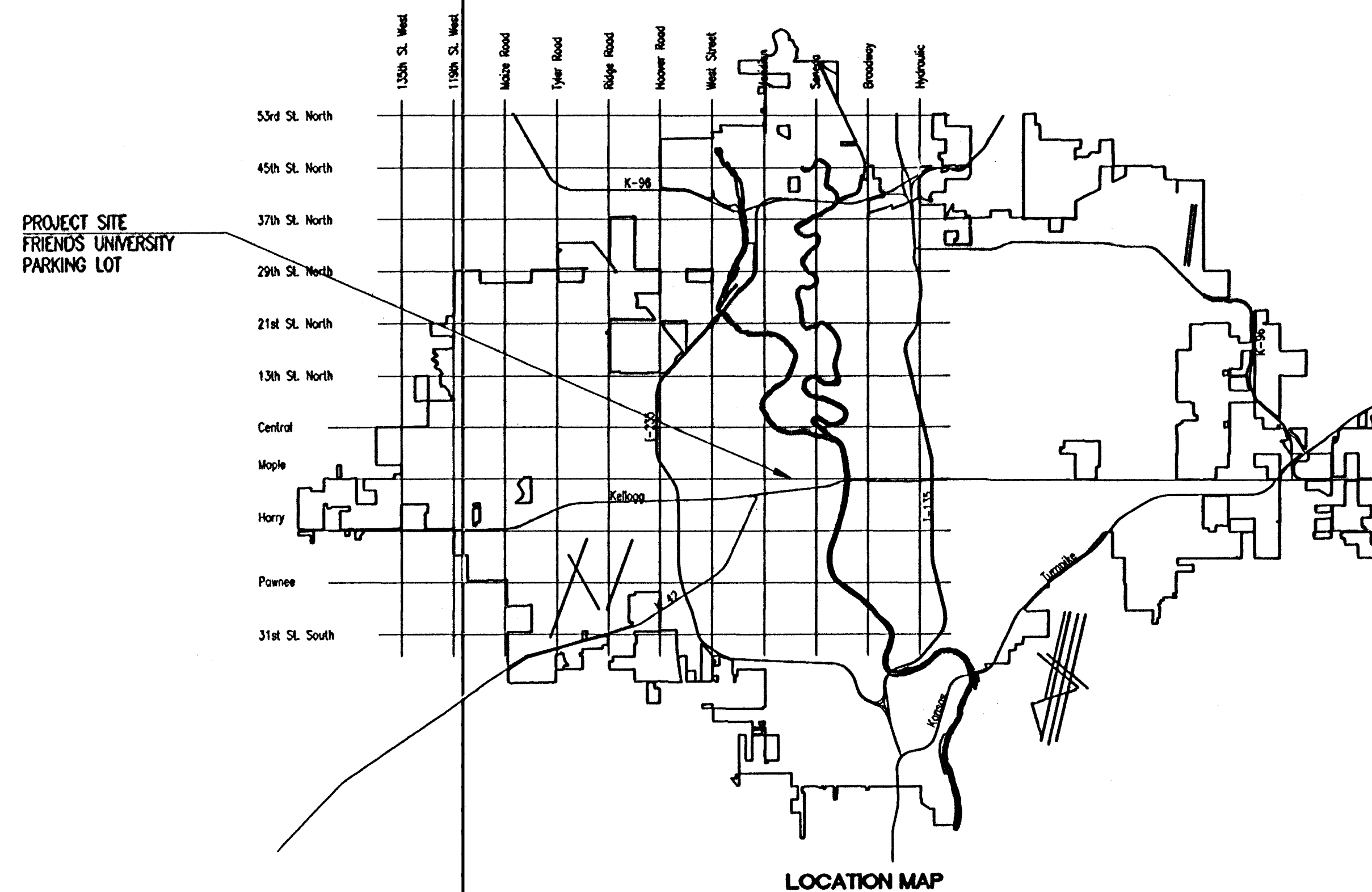

APPROVED AS NOTED
By CITY ENGINEER OF WICHITA

Storm Sewers ACT 6-22-06

NOTE TO CONTRACTOR

INSPECTION AND TESTING FOR THIS PROJECT IS TO BE PROVIDED BY A LICENSED CONSULTING ENGINEERING FIRM CONTRACTED BY THE OWNER/DEVELOPER. SAID INSPECTION TO BE IN ACCORDANCE WITH THE CITY OF WICHITA STANDARD CONSTRUCTION ENGINEERING PRACTICES AND CERTIFIED BY A LICENSED PROFESSIONAL ENGINEER. NO WORK SHALL BE PERFORMED IN DEDICATED EASEMENTS OR PUBLIC RIGHT-OF-WAY BY THE CONTRACTOR UNTIL SUCH INSPECTION IS ARRANGED FOR AND REQUIRED BONDS HAVE BEEN SUBMITTED TO AND APPROVED BY THE CITY. NOR SHALL ANY WORK BE COMMENCED IN DEDICATED EASEMENTS OR PUBLIC RIGHT-OF-WAY WITHOUT WRITTEN AUTHORIZATION BY THE CITY ENGINEER. IMPROVEMENTS PERFORMED UNDER THIS PROJECT SHALL NOT BE ACCEPTED BY THE CITY UNTIL ALL APPLICABLE DOCUMENTATION HAS BEEN SUBMITTED TO THE CITY ENGINEER. THIS MAY INCLUDE RECORD DRAWINGS, INSPECTION LOGS, TEST DOCUMENTATION, TV TAPES, AND A CERTIFICATE OF COMPLETION. THE ABOVE SHALL BE PERFORMED BY THE CONSULTING FIRM CONTRACTED TO INSPECT THIS PROJECT.

MAY 2006

PLANS PREPARED BY
PROFESSIONAL ENGINEERING CONSULTANTS, P.A.
ENGINEERS
WICHITA, KANSAS

AS-BUILT
8/1/06
Data J.E. Miller
[Signature]
[Signature]

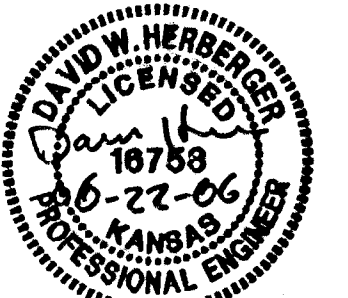

06/22/06 Revised for PW Signature

Sheet 06-22-06 15/04 PM by JET
 Plot Scale 1" = 60'-0" 06-22-06 2:10:34 PM by JET
 CA 2006/06/19/10:01/06193-001-004 1-SWS-Title-Rev-1-06-22-06