

**BENCHMARKS:**  
 BM #1: Railroad spike in HLP  
 2' West of center Sec. 11,  
 T-27-S, R-2-W  
 (S. Face of HLP)  
 Elev. = 1367.70 NGVD29

BM #2: "□" Cut in top of  
 curb adjacent to the Southwest  
 Corner, Lot 11, Block B,  
 Blackstone Addition  
 Elev. = 1369.85 NGVD29

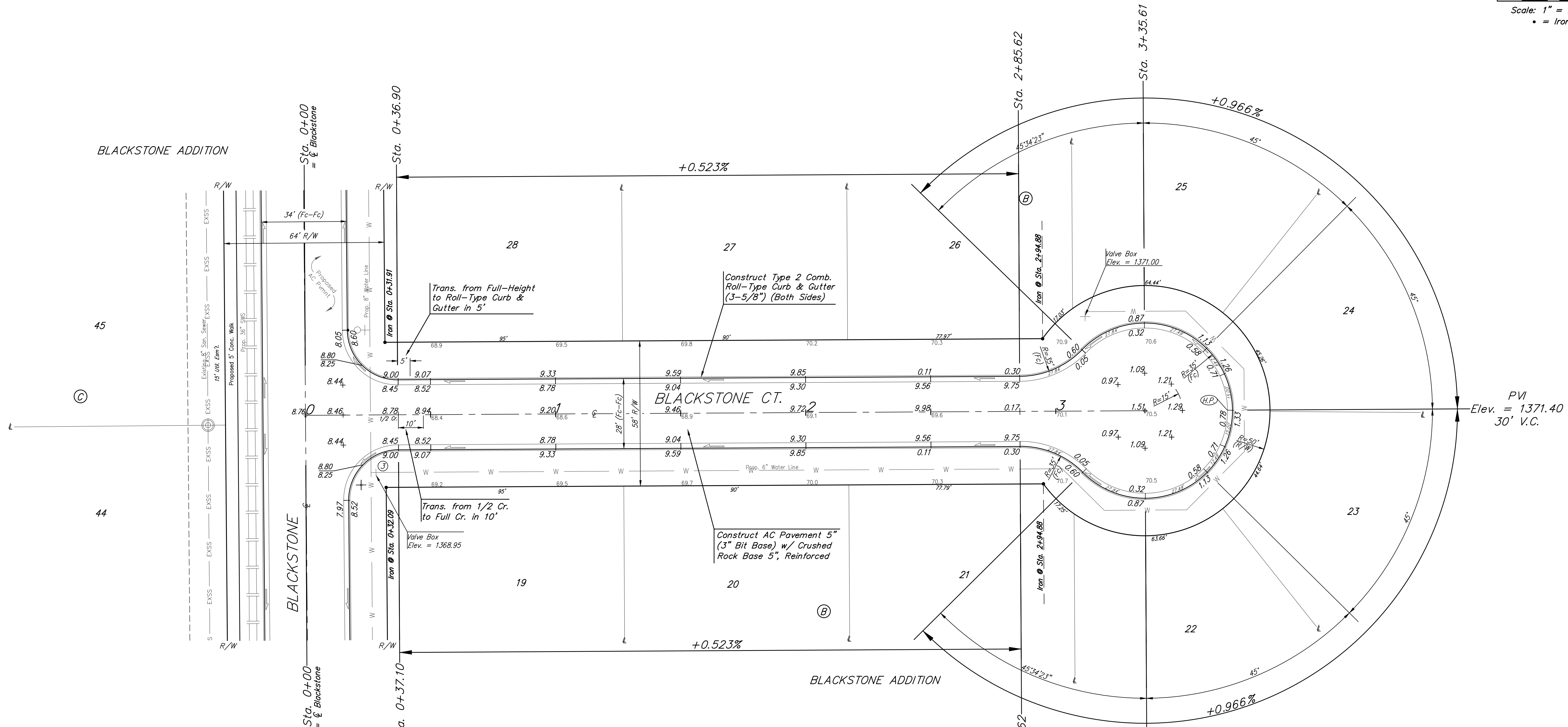
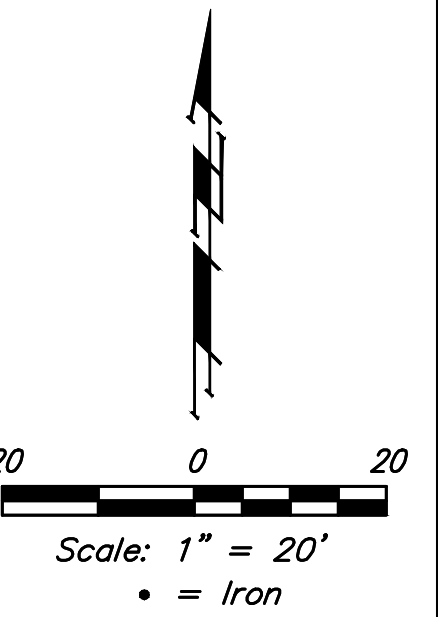

Roll type curb & gutter to  
 be constructed on the pavement  
 on this sheet.  
 Top of curb elevation are given  
 for full height curb.

		Blackstone Addition - Phase III	
		<b>BLACKSTONE CT</b>	
Lot 19 - Lot 28, Block B		<small>Baughman Company, P.A. 315 Ellis St. Wichita, KS 67211 P 316-262-7271 F 316-262-0149          ENGINEERING   SURVEYING   PLANNING   LANDSCAPE ARCHITECTURE</small>	
PROJECT NUMBER 472-84399	DESIGN NBW	DRAWN JAK	DATE 8/27/18
REVISIONS:	APPROVED	SCALE Noted	SHEET
			<b>12 OF 41</b>